

- LEGEND**
- PROPERTY LINE
 - - - BUILDING ENVELOPE
 - - - PERENNIAL STREAM
 - - - INTERMITTENT STREAM
 - BREAKPOINT BETWEEN PERENNIAL/INTERMIT. STREAM
 - FEMA FLOODWAY OR FLOOD HAZARD AREA
 - ▨ RESOURCE CONSERVATION DISTRICT STREAMSIDE ZONE
 - ▩ RESOURCE CONSERVATION DISTRICT MANAGED ZONE
 - ▧ RESOURCE CONSERVATION DISTRICT UPLAND ZONE

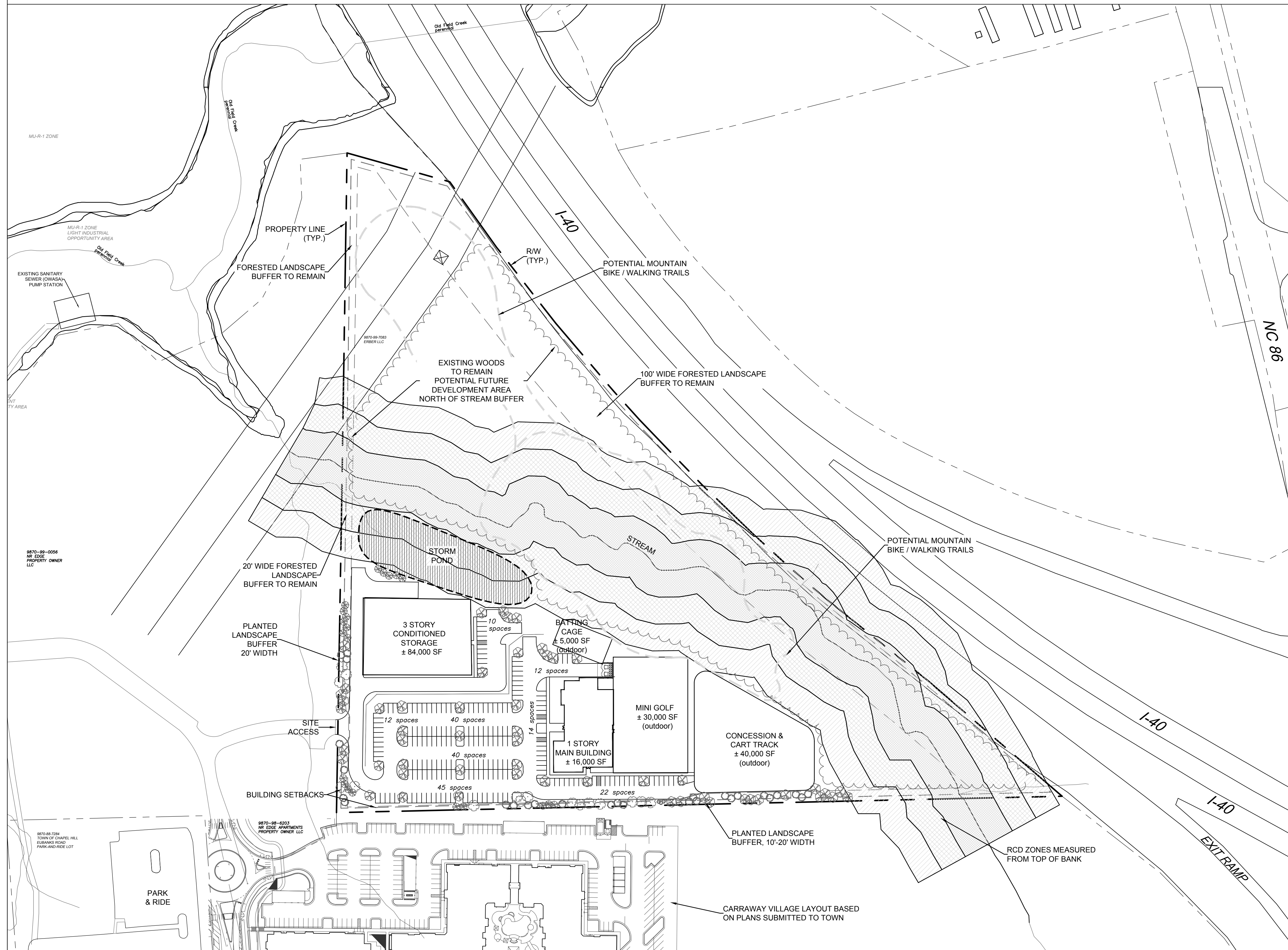

PIN	9870997083
ENVIRONMENTAL CONSTRAINTS	JORDAN BUFFER RESOURCE CONSERVATION DISTRICT
LAND AREA	844,031 SF / 19.376 AC APPROX 148,920 SF IN STREAMSIDE RCD ZONE APPROX 144,960 SF IN UPLAND RCD ZONE
USE GROUP:	B and C
PROPOSED USES INCLUDE:	- CONDITIONED SELF-STORAGE - INDOOR AND OUTDOOR RECREATION USES INCLUDING BUT NOT LIMITED TO: MINI GOLF, LASER TAG, BATTING CAGES, GO-KART TRACK, BUMPER CARS, BIKE AND WALKING TRAILS, AND ACCESSORY USES SUCH AS DINING AND EVENT SPACES WITHIN THE PROJECT
MAXIMUM FLOOR AREA:	148,920 SF X .01 + 144,960 SF X .19 ± 550,171 SF X .264 174,275 SF MAXIMUM BASED ON GIS INFO
PROPOSED FLOOR AREA:	84,000 SF CONDITIONED SELF STORAGE 16,000 SF INDOOR RECREATION PLUS OUTDOOR RECREATION SPACE
MAXIMUM BUILDING HEIGHT:	60 FT.
REQUIRED PARKING:	33-56 SPACES FOR 84,000 SF CONDITIONED SELF-STORAGE NO REQUIREMENTS FOR RECREATION USES
PROPOSED PARKING:	APPROXIMATELY 200 SPACES 10-20 SPACES FOR SELF-STORAGE 150-180 SPACES FOR INDOOR-OUTDOOR RECREATION BICYCLE PARKING WILL BE PROVIDED
MAX. PROPOSED IMPERVIOUS SURFACE AREA:	MAXIMUM 60% OF SITE
TREE COVERAGE AREA:	REQUIRED - 844,031 SF x 40% = 337,612 SF PROVIDED - MINIMUM 400,000 SF TREE PRESERVATION AREA

2 PROJECT DATA
DP-3



Coulter Jewell Thames
P.A.

111 West Main Street
Durham, N.C. 27701
p 919.682.0368
f 919.688.5646
www.cjtpa.com

NC BOARD OF EXAMINERS FOR ENGINEERS AND SURVEYORS LIC# C-1209
NC BOARD OF LANDSCAPE ARCHITECTS LIC#C-104

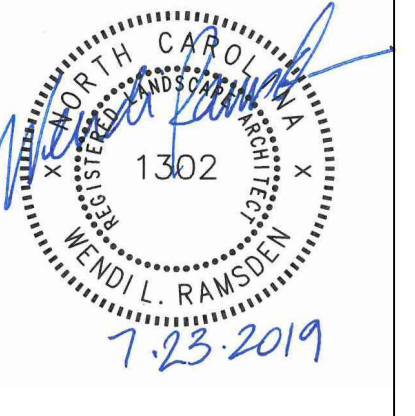

Project
Putt-Putt Fun Center
Eubanks Road
Chapel Hill, NC

PIN 9870997083

Job Number 1952

Drawn WLR, MTC
Checked WLR
Date 7/23/2019
Revisions

CONCEPT PLAN APPLICATION NOT ISSUED FOR CONSTRUCTION

Sheet Title

CONCEPT PLAN

Sheet Number

DP-3

