

# East Rosemary Redevelopment-Streetscape/Median Concepts

Brian Peterson, AIA, Urban Designer, 02-12-21

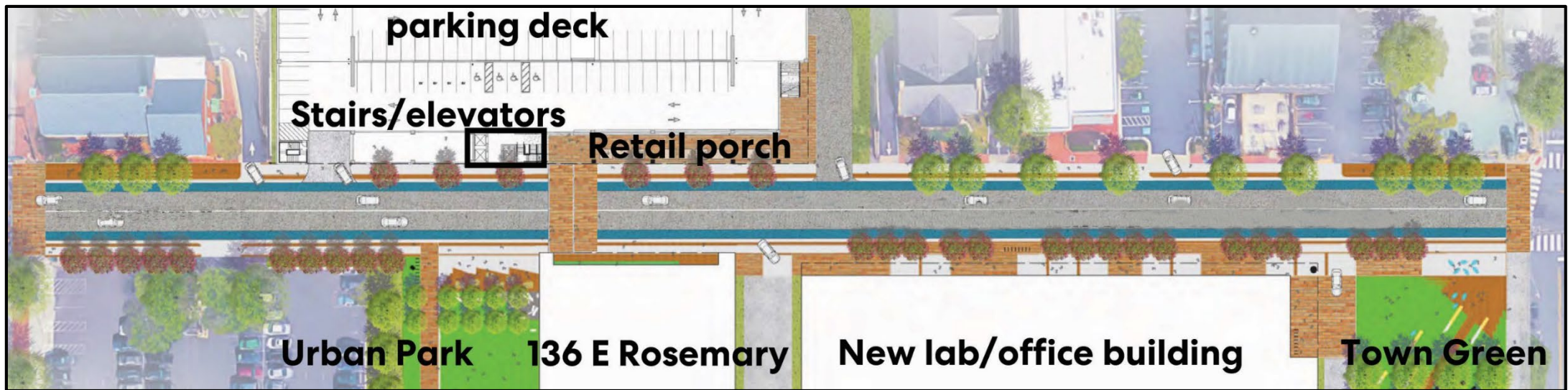

**1. Two travel lanes, bike lane on each side of street**

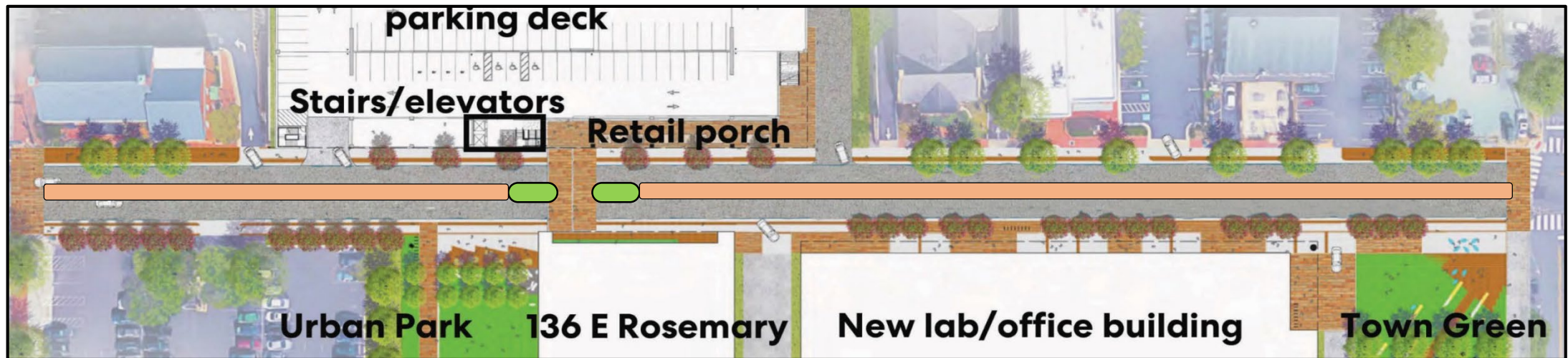

**2. Proposed: Center left turn lane and two travel lanes, as exists, share with bikes**

## Lane Allocation Options (existing pavement width to remain)

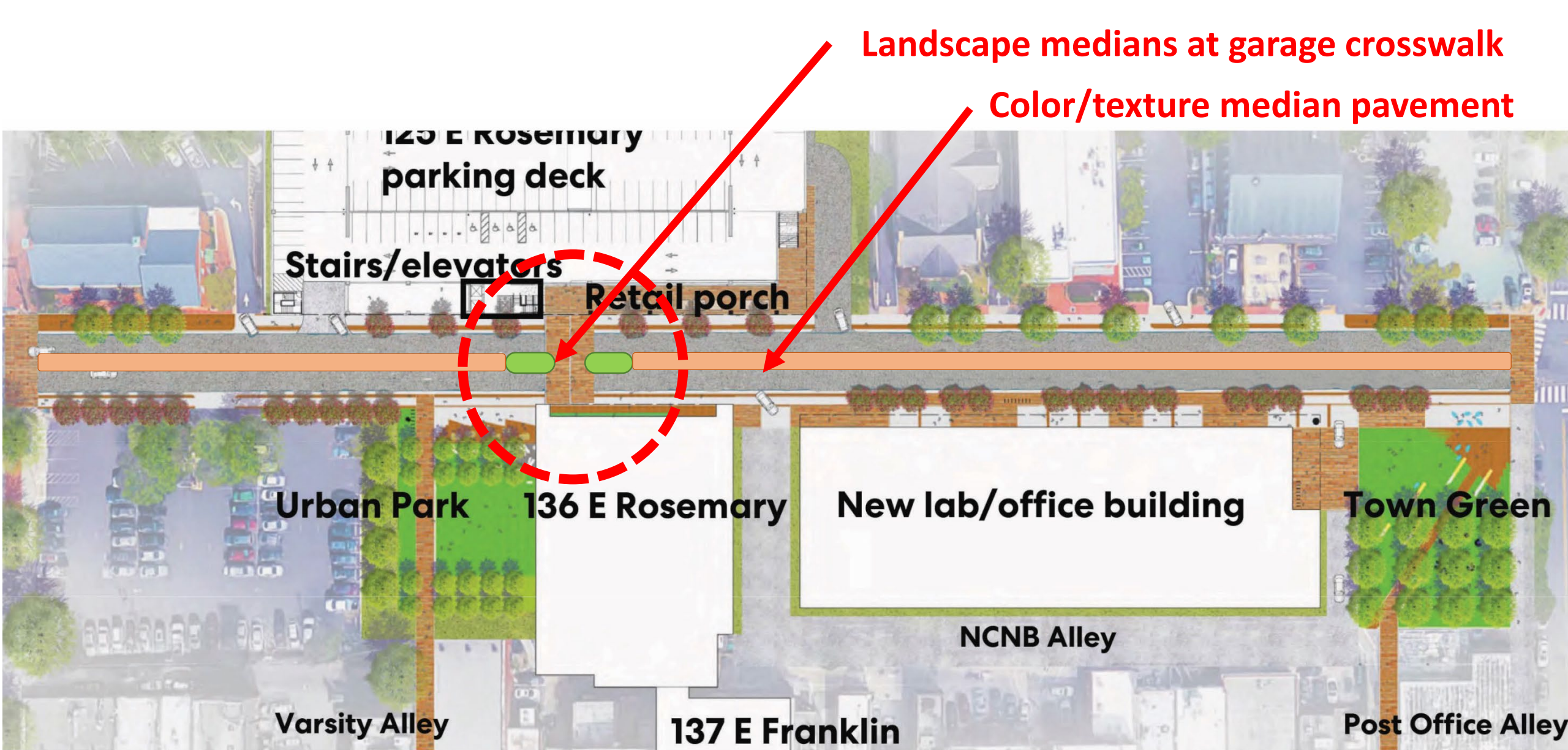

Landscape medians at garage crosswalk

Color/texture median pavement

**East Rosemary Street-Block Plan of Proposed Center Median/Left Turn Lane with Decorative Pavement and Planter Crosswalk Medians**

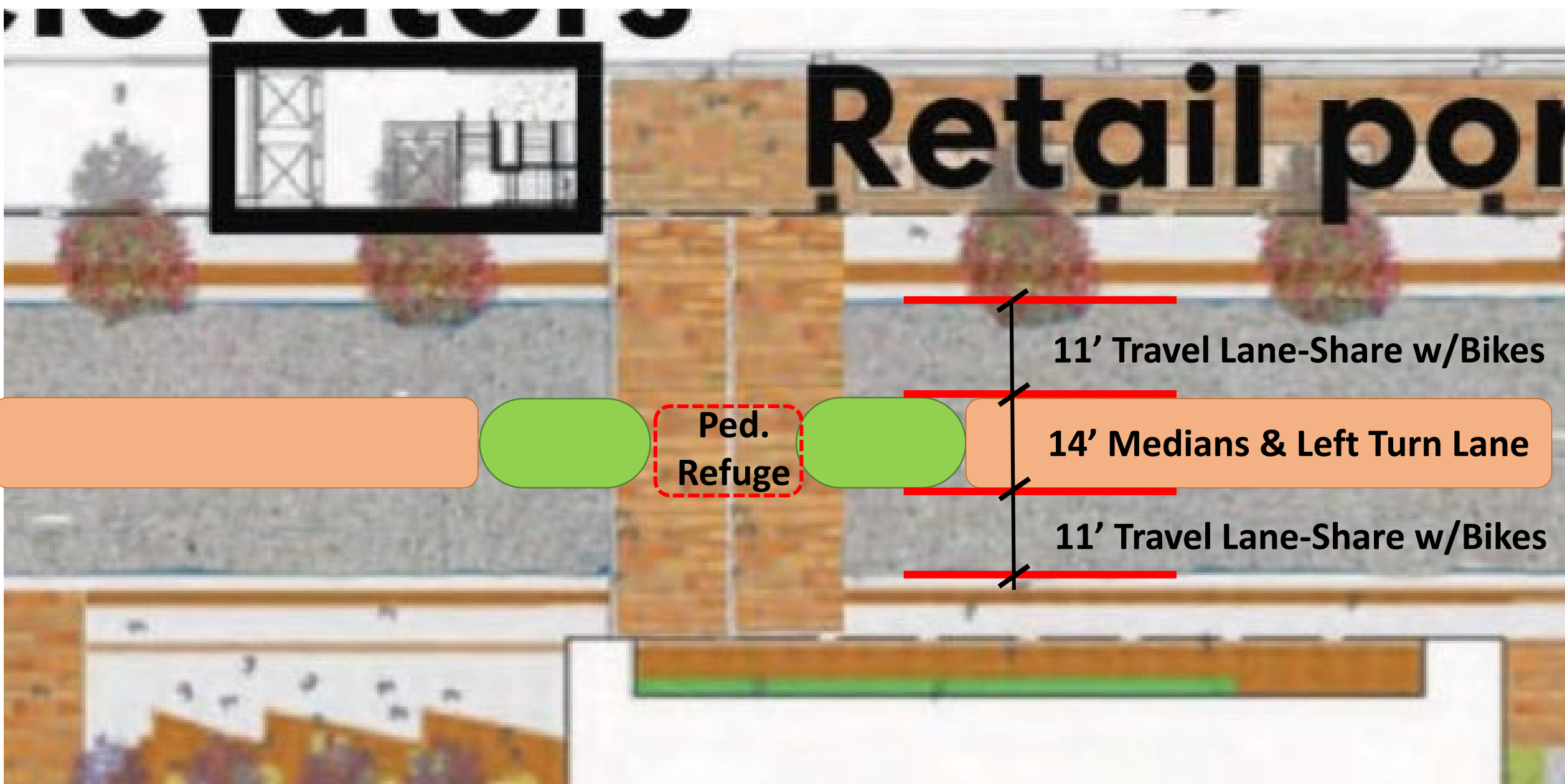

**East Rosemary Street-Pedestrian Crosswalk: Center Left Turn Lane With Decorative Pavement**



**Examples: Median With Decorative Pavement, Color and Texture**

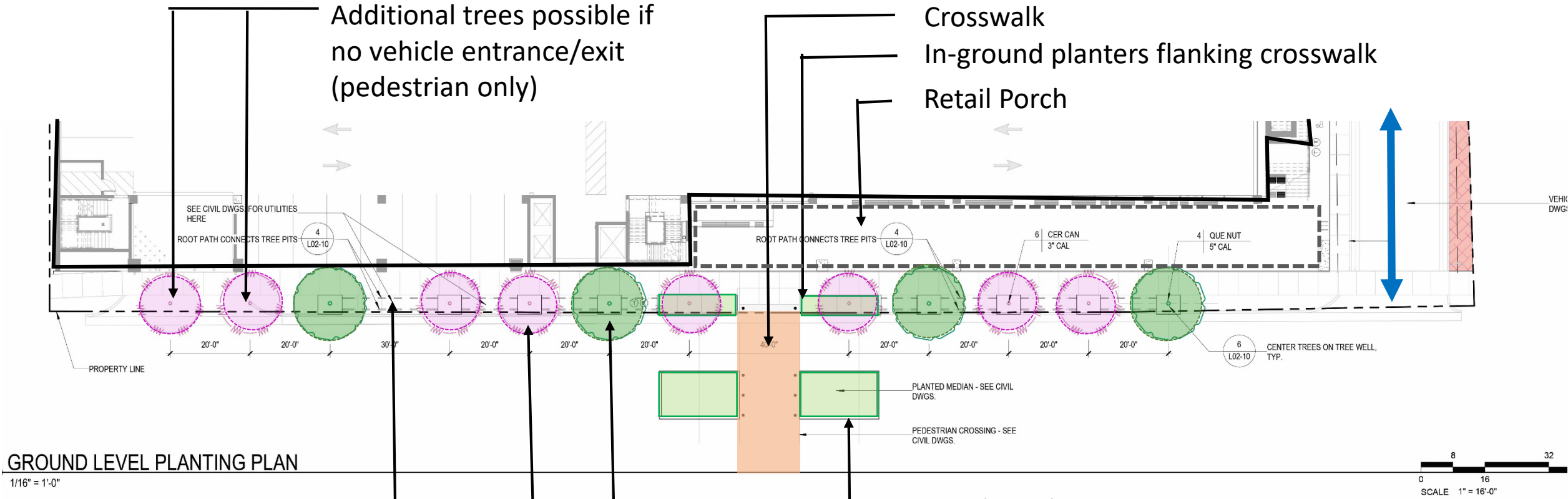

**GROUND LEVEL PLANTING PLAN**  
1/16" = 1'-0"

Additional trees possible if no vehicle entrance/exit (pedestrian only)

Crosswalk  
In-ground planters flanking crosswalk  
Retail Porch

Median planters

Taller Trees-Ruby Spring Nuttail Oak

Shorter Trees-Texas Redbud

Root Path System connects tree pits (or possibly Silva Cell system) TBD

# Planting Plan in Front of Parking Ramp



Crosswalk Detail:  
Planters & Bollards

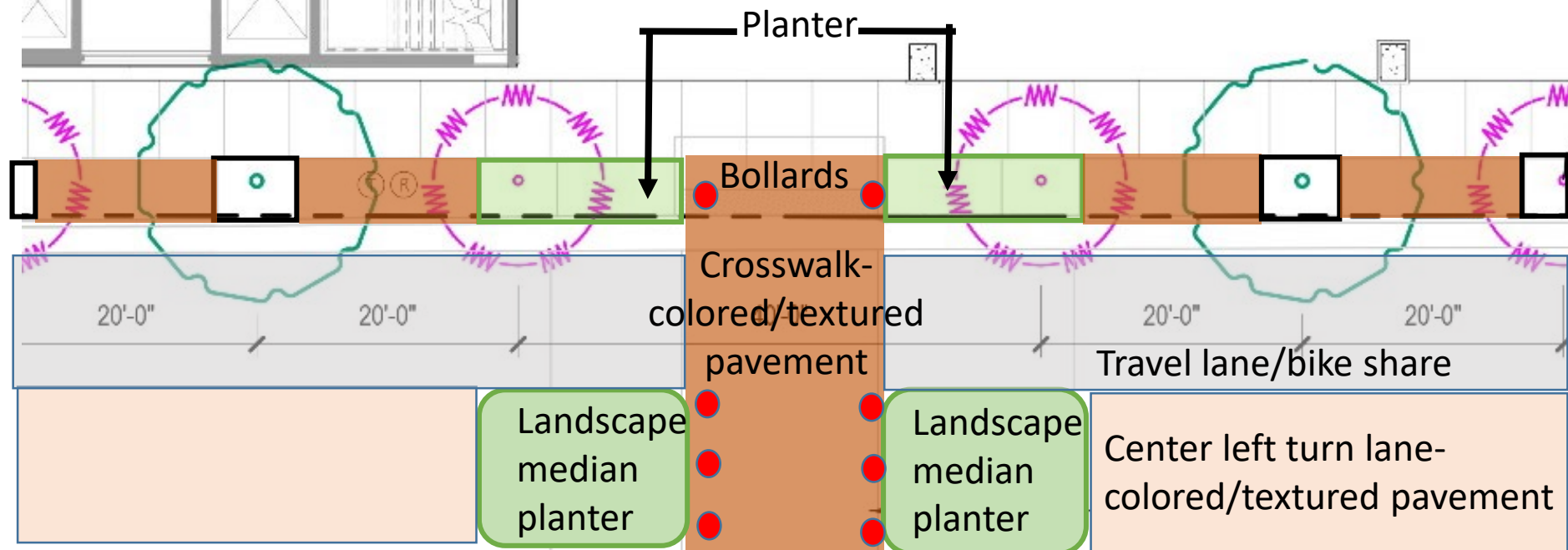



**East Rosemary  
Street-Potential  
Crosswalk Treatment**



Thank You!  
Questions??

