

TOWN OF CHAPEL HILL DEVELOPMENT UPDATE SEPTEMBER 10, 2021

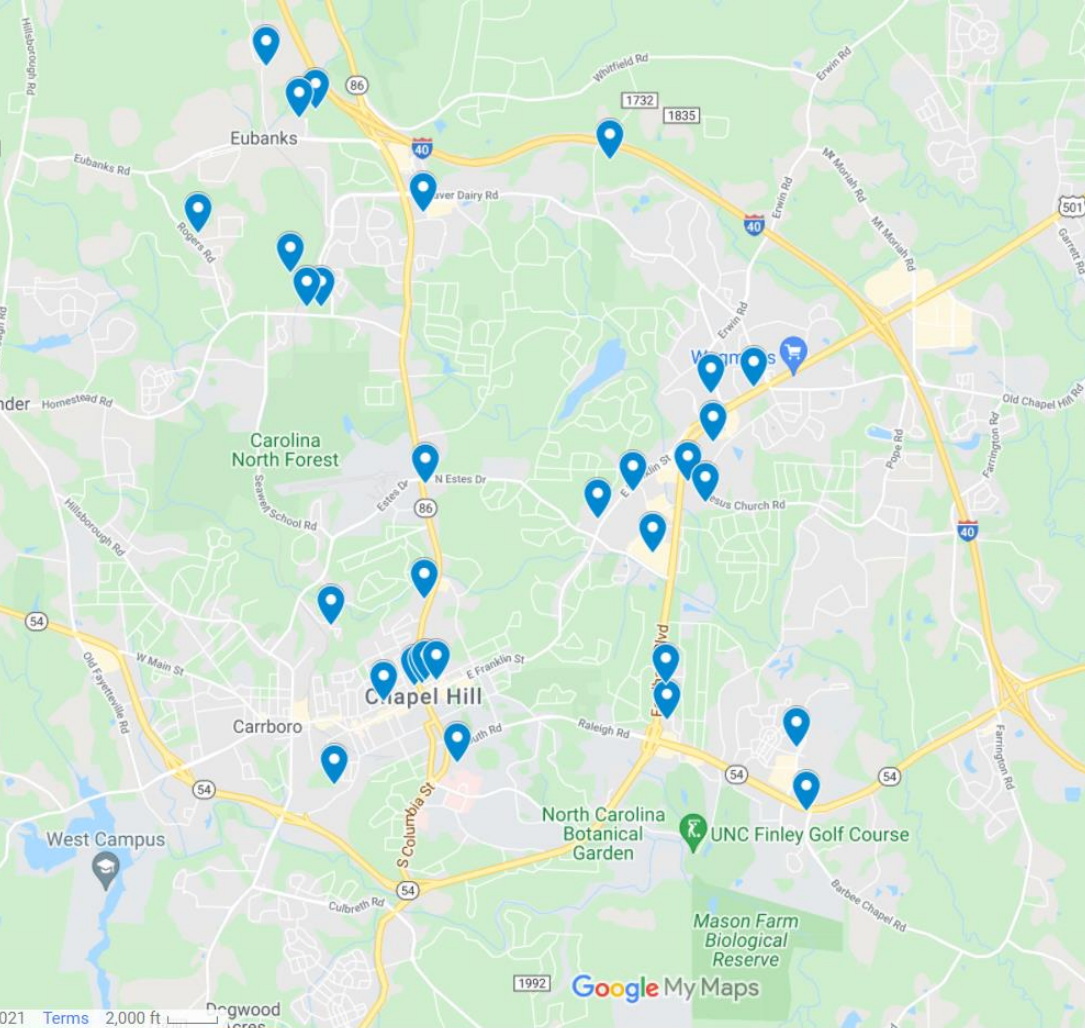

30 Projects Under Review for Development



Heading North on 15-501



UNC Healthcare Surgical Tower

Use	Healthcare
Size	376,301 sf
Status	Construction

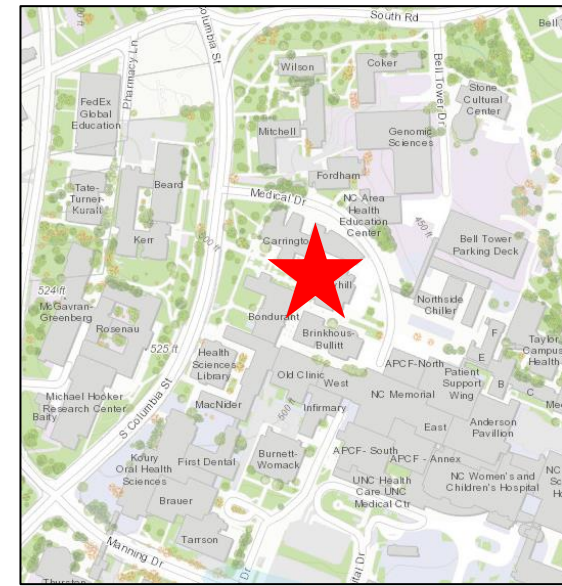

UNC Medical Education Berryhill Hall

Use	Healthcare/Education
Size	174,582 sf
Status	Construction

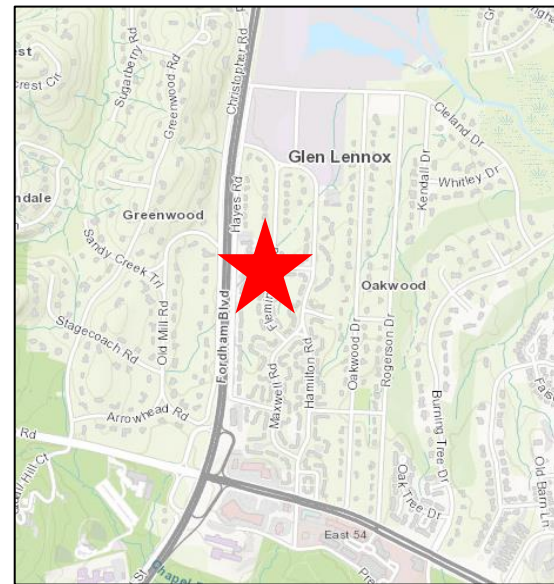

Glen Lennox - Calyx	
Use	Multifamily
Size	304 units
Status	DACP being issued

5
KMK

2



20141217000227950 AGMT
Bk:RB5883 Pg:11
12/17/2014 10:26:27 AM 1/196
FILED Rick Chilton
Register of Deeds, Orange Co. NC
Recording Fee: \$750.00
NC Real Estate Tx. \$ 500 NH

DEVELOPMENT AGREEMENT

BY AND BETWEEN
FCP GLEN LENNOX, LLC (f/k/a GLEN LENNOX DELAWARE, LLC),
and GLEN LENNOX SHOPPING CENTER, LLC

AND

THE TOWN OF CHAPEL HILL, NORTH CAROLINA

Effective Date: 12/10, 2014

Orange County Parcel Identifier Numbers: 9798-26-8547; 9798-25-4529

AB

RETURN TO: TOWN OF CHAPEL HILL,
405 MARTIN LUTHER KING JR BLVD.
CHAPEL HILL, NC 27514
ATTN: KAY PEARLSTEIN

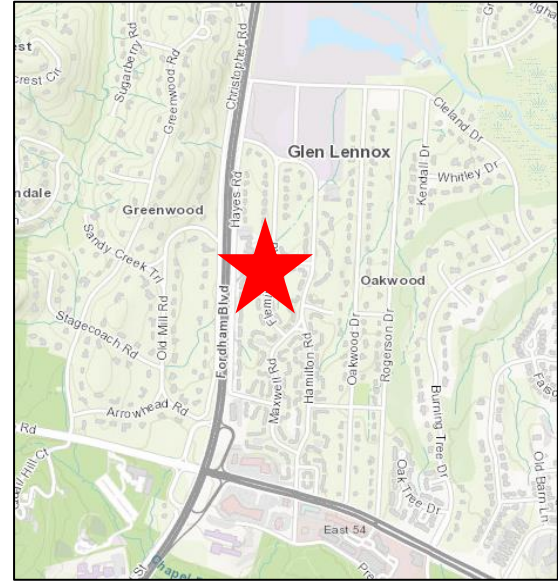

Glen Lennox Development Agreement – Minor Modification

Change	Adjustment to setbacks & realignment of Hamilton Road
---------------	---

Modification Request – Height Limit Shifts: DA Plan

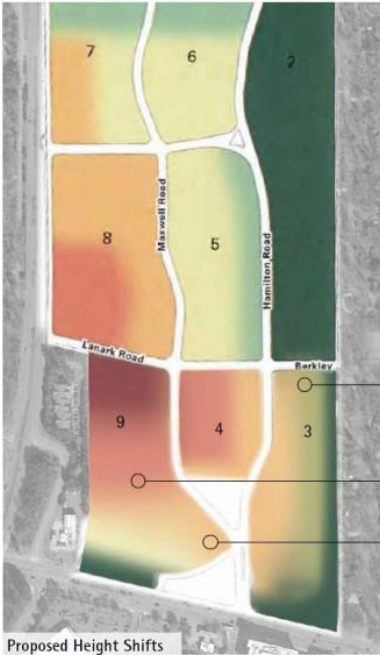

- Step down to 3 story building height. Maintain green buffer edge at existing residential.
- Similar to the North side of Lanark Road, introduce a smooth height transition from Lanark to Raleigh. Maintain green buffer edge on Raleigh Road.
- Shift height to project core, further away from existing residential.

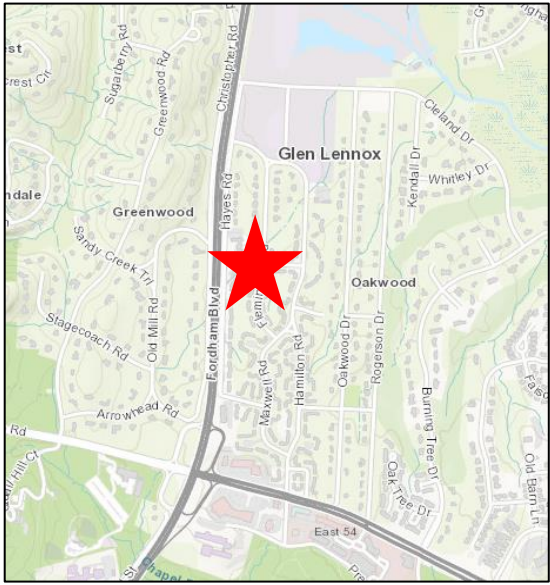

Glen Lennox	
Use	Development Agreement
Size	Major Modification
Status	Council - September

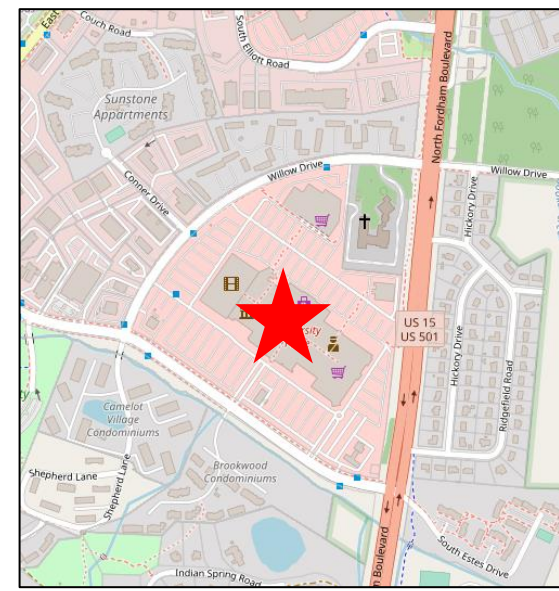

University Place

Use	Mixed Use
Size	300 du; office 150,000sf; comm 450,000; Hotel (150 rooms)
Status	Final Plan – staff review

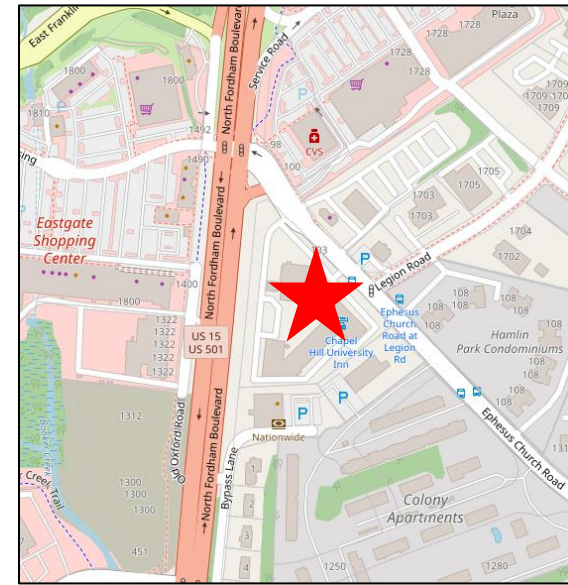

Millennium Chapel Hill (University Inn)

Use	Multifamily & non-residential
Size	284 Units
Status	FDP (COA issued)

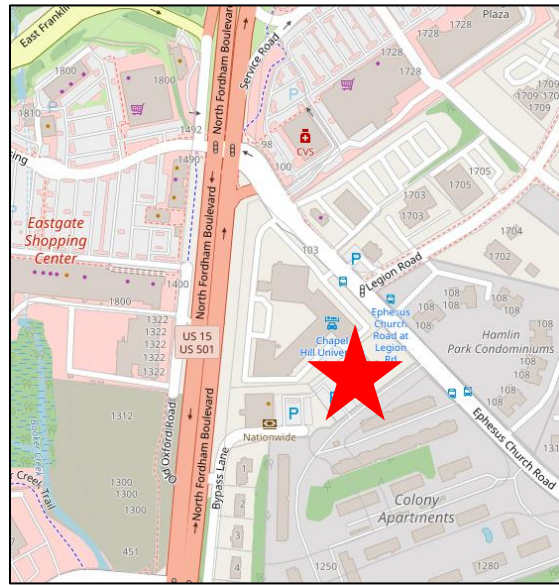
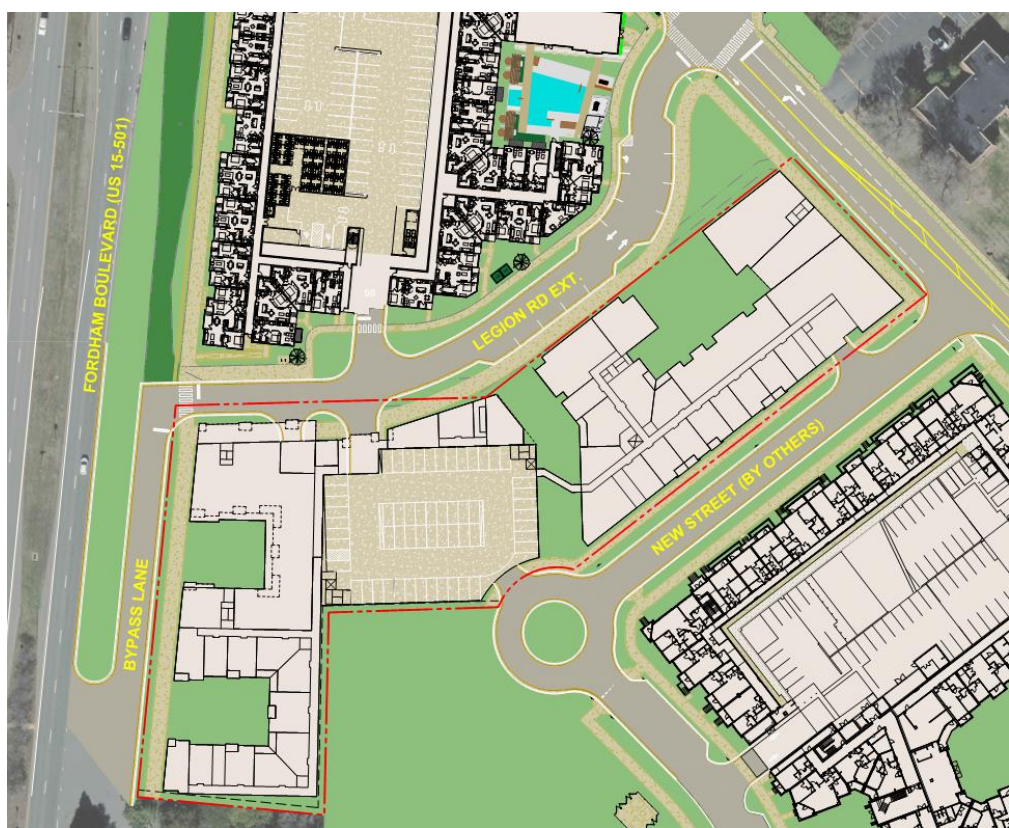

Aura Blue Hill

Use	Multifamily & non-residential
Size	272 units & 23,195 sf commercial
Status	COA under review

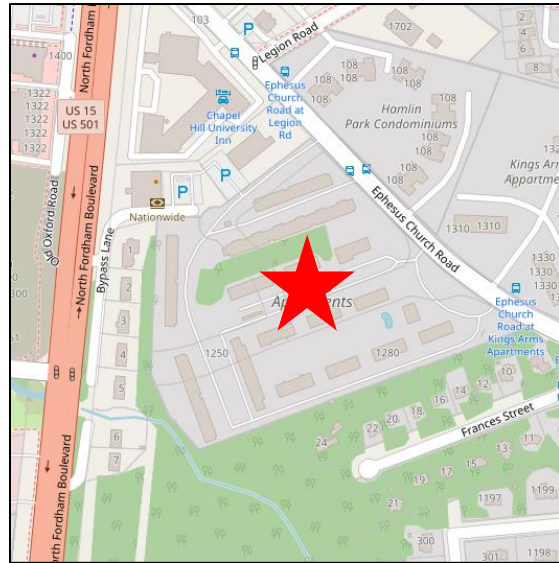

Park Apartments	
Use	Multifamily
Size	414 Units (4 buildings)
Status	Under construction



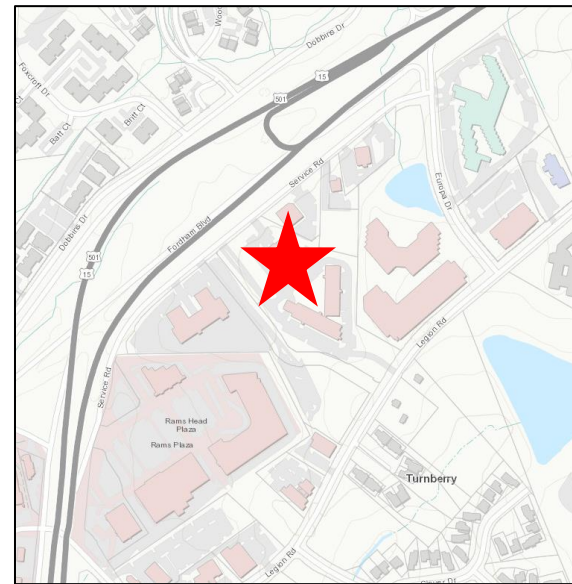

Tarheel Lodging	
Use	Office, Hotel, Multifamily
Size	98 hotel rooms; 43,000 sf office; 234 units
Status	Under construction



Hardees (1800 Fordham Blvd)	
Use	Change to Bank
Size	2,400 sf
Status	Concept Plan

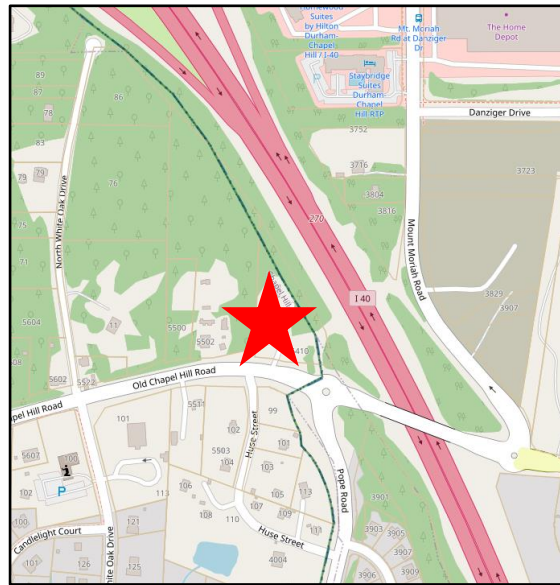

5500 Old Durham Road

Use	Multifamily
Size	90 units; 141,500 sf
Status	Concept Plan - October

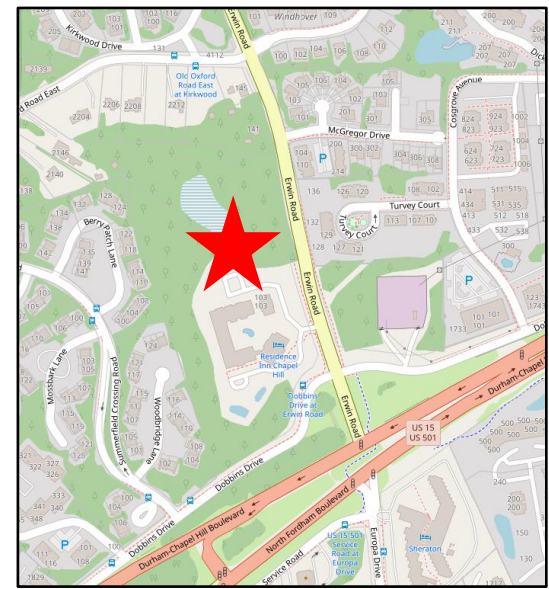

101-110 Erwin Road	
Use	Hotel and Residential
Size	52 units 34,000 sf increase (44 rooms)
Status	Conditional Zoning – Council October

Downtown



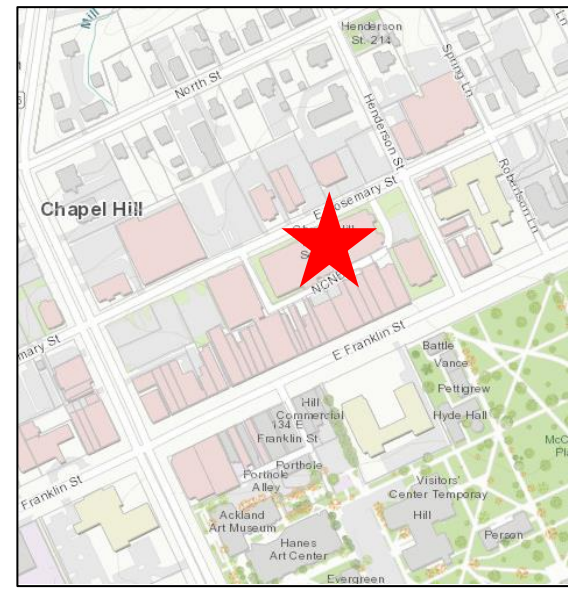
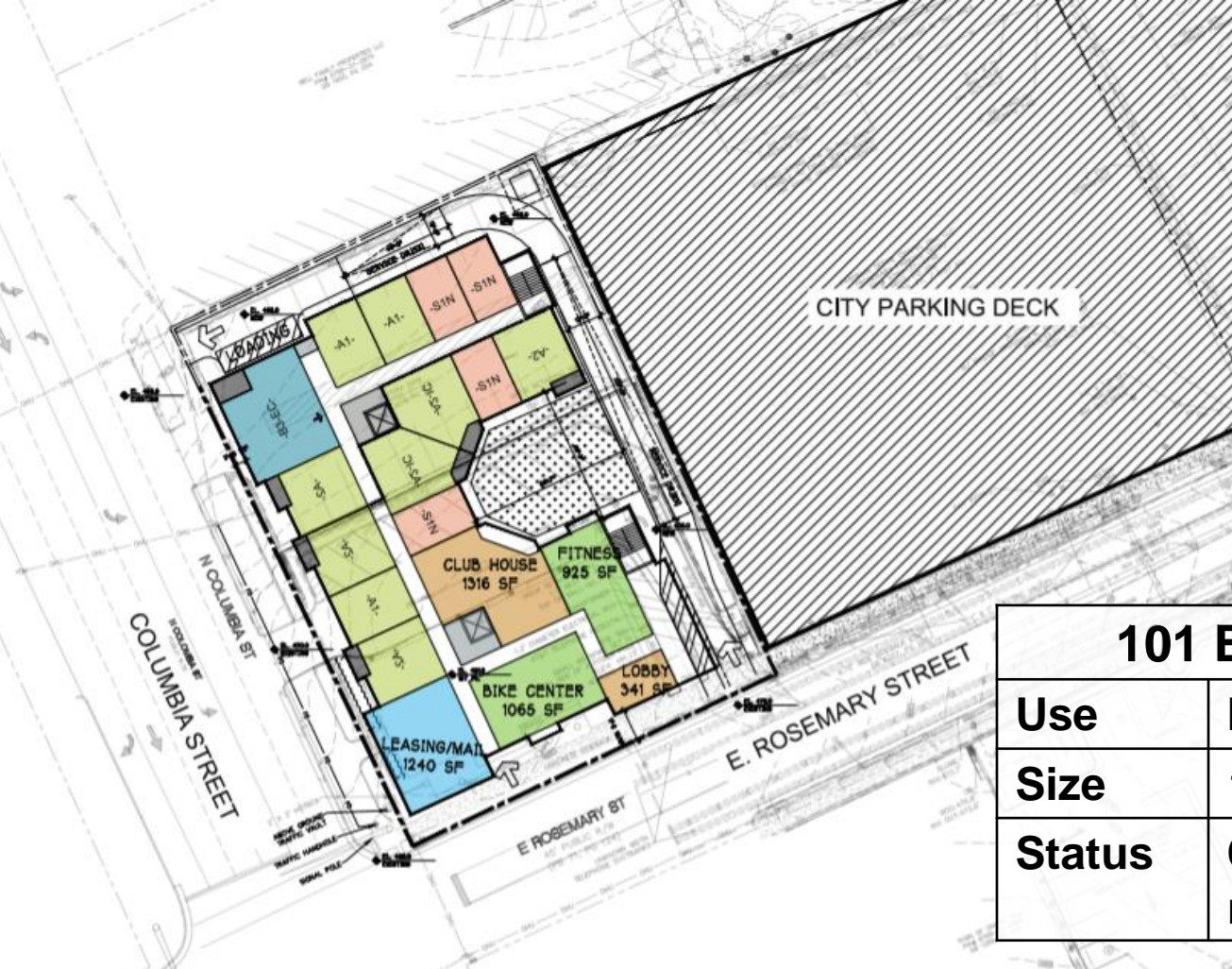

101 E. Rosemary Street	
Use	Multifamily
Size	140 units; 74,000 SF
Status	Conditional Zoning – staff review

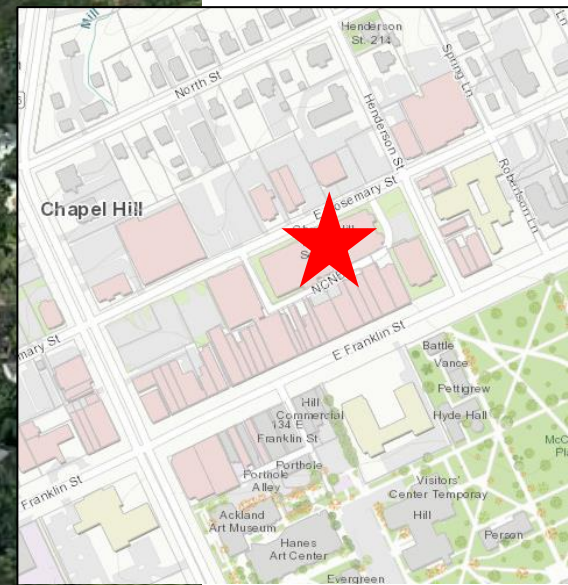

125 East Rosemary Street

Use	Parking Garage
Size	1,160 spaces
Status	Demo begun; Phase 2 under review

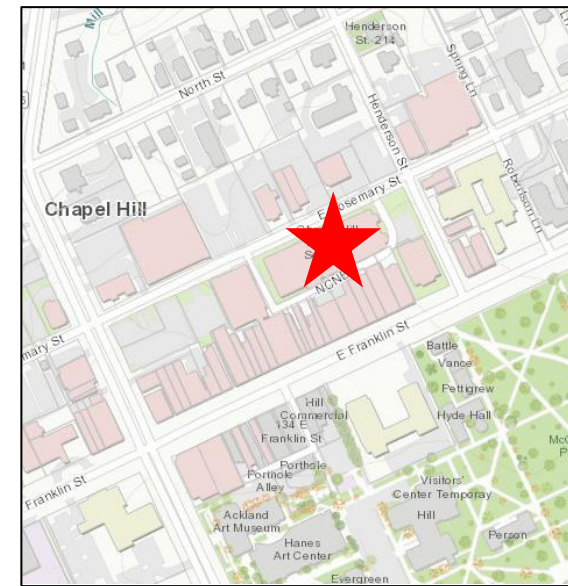
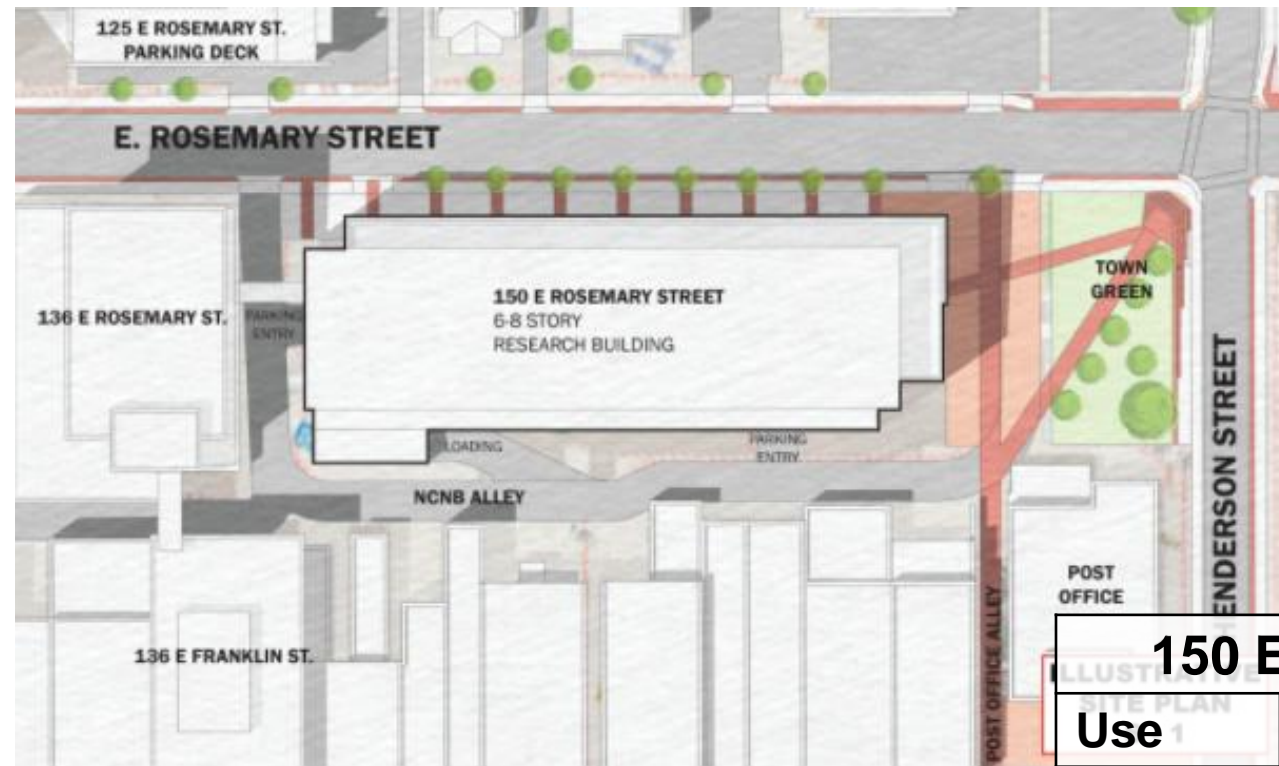

150 East Rosemary Street

Use	Commercial Office
Size	228,000 sf
Status	Conditional Zoning – staff review



The existing Trinity Court Apartments

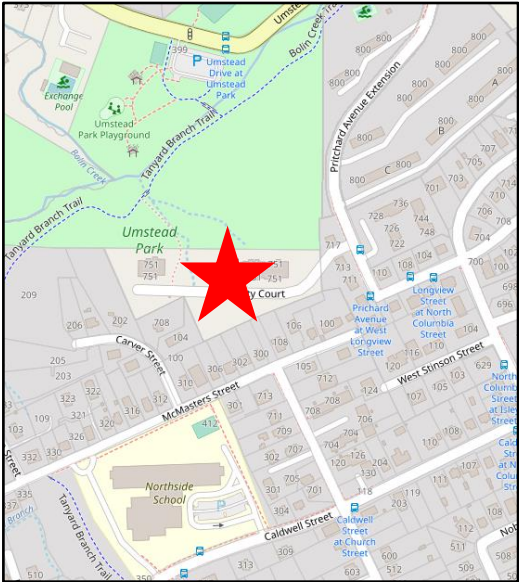

Trinity Court	
Use	Multifamily
Size	<i>To be determined</i>
Status	Concept Plan - November

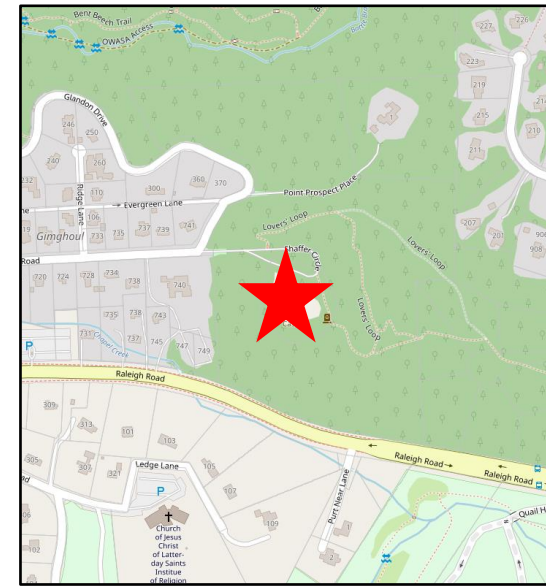

Gimghoul Castle

Use	Club
Size	1,200 sf addition
Status	Conditional Zoning – staff review

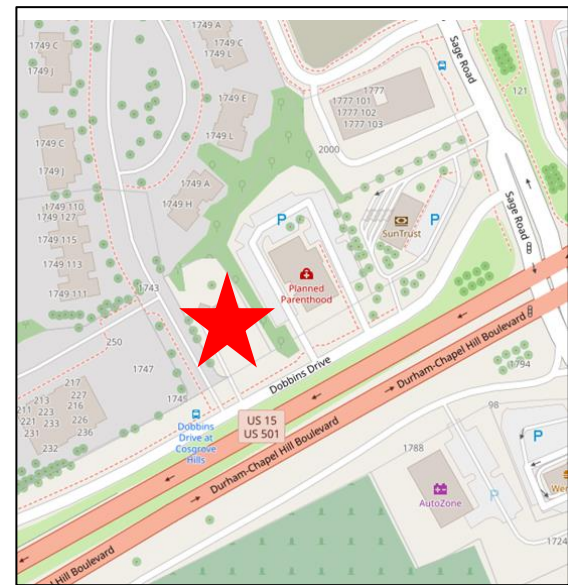
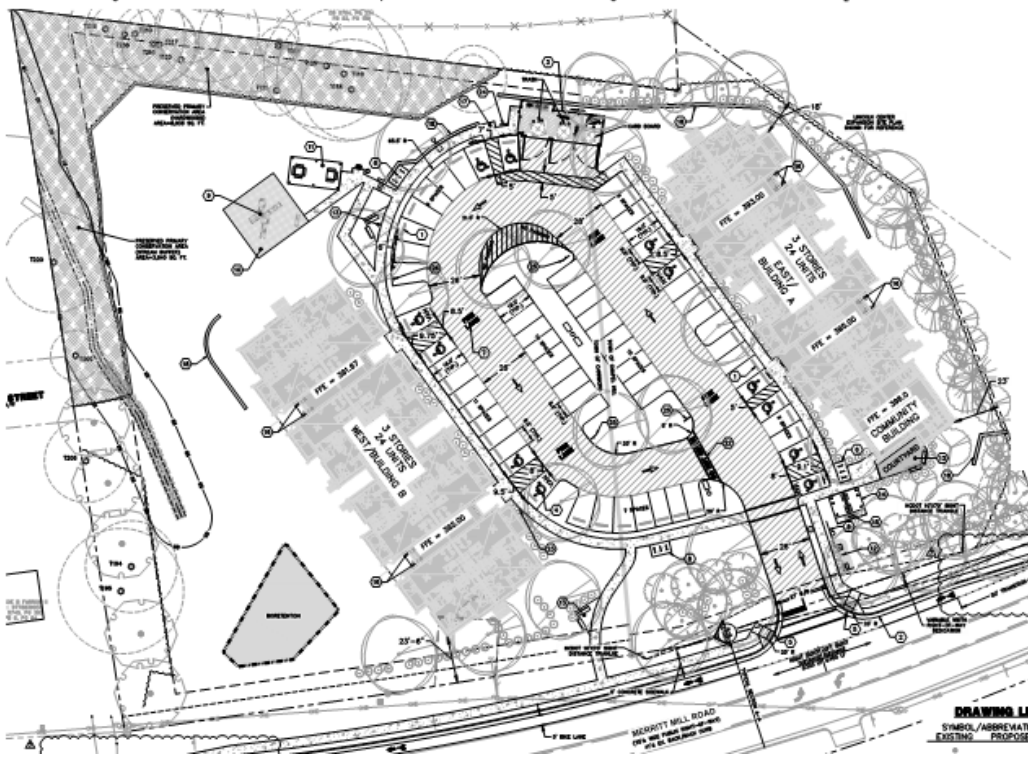

Perry Place, CASA	
Use	Multifamily
Size	48 units (22,658 sf in Chapel Hill)
Status	Final Plan



Heading north on Martin Luther King Jr Blvd

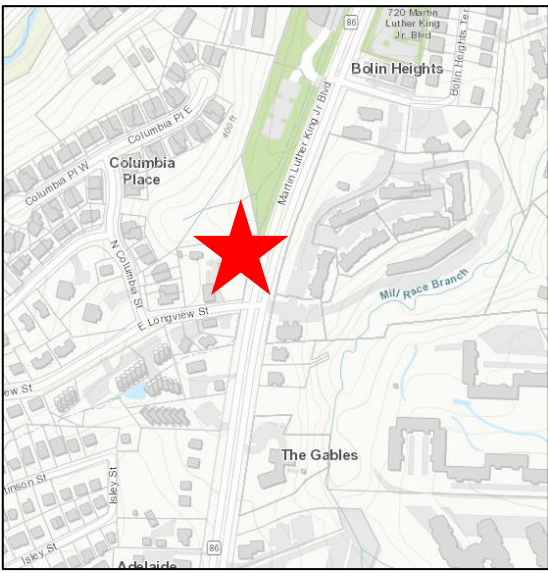
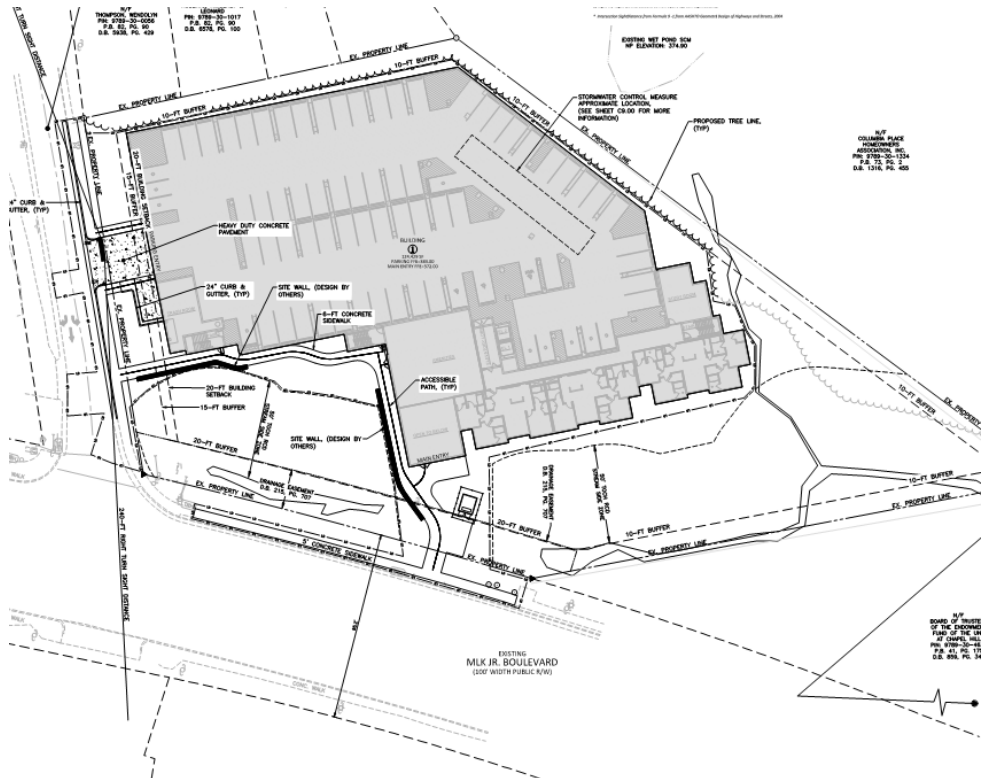

Aspen Heights	
Use	Multifamily
Size	112 units; 124,000 sf
Status	Conditional Zoning – staff review

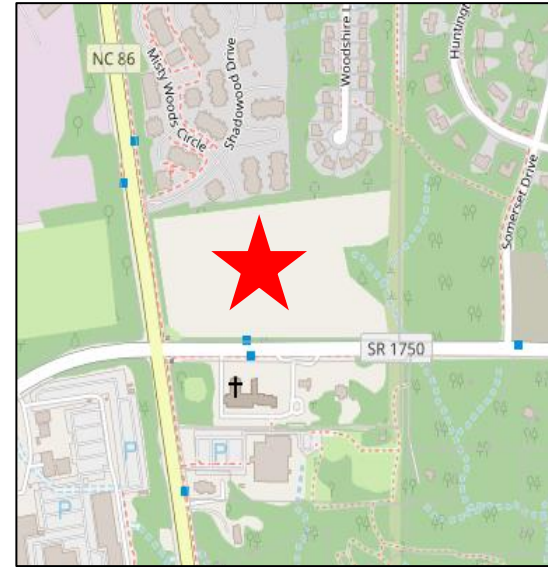

Aura Chapel Hill	
Use	Multifamily & Commercial
Size	544,946 sf; 419 units
Status	Final Plan – staff review

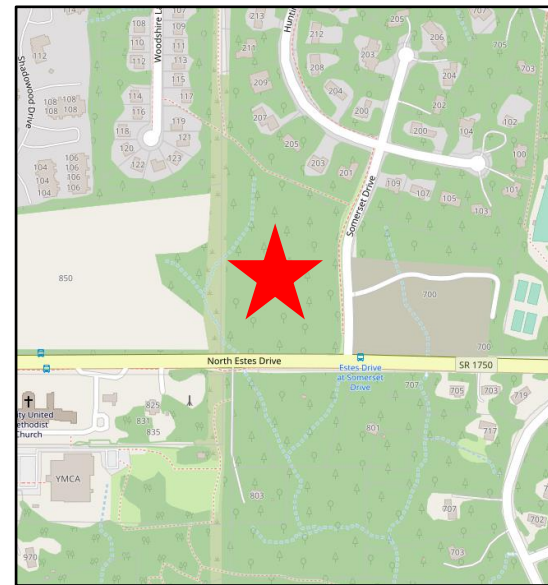

710 N Estes Drive

Use

Multifamily

Size

78 units

Status

Concept Plan – November

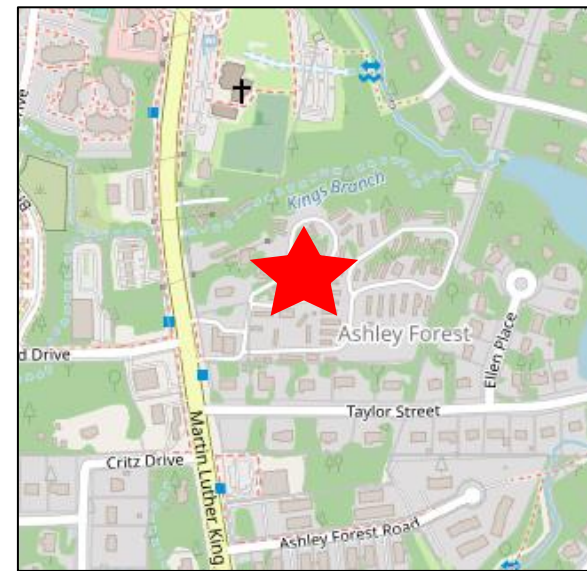

1200 MLK

Use	Gas Station, Storage Facility, Mobile Home Park
Size	105,700 sf & 73 residential units
Status	Final Plan – staff review

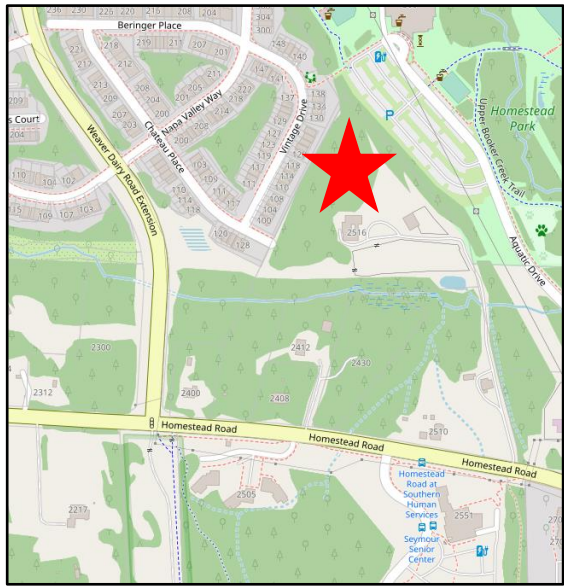

Stanat's Place	
Use	Residential
Size	47 townhomes
Status	Concept Plan - October

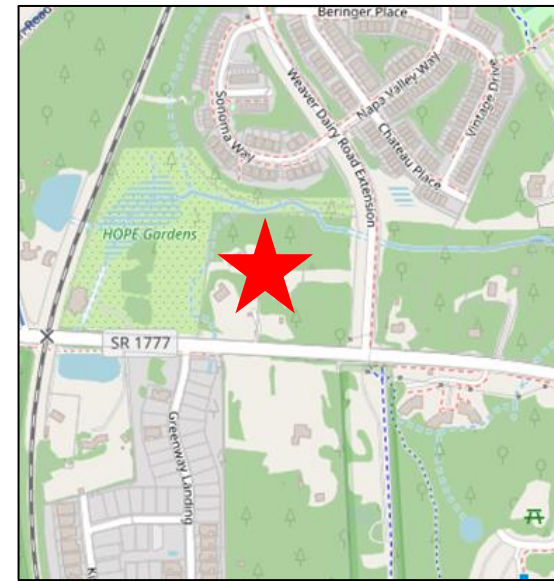

Bridgepoint	
Use	Residential
Size	53 townhomes
Status	Final Plan – staff review

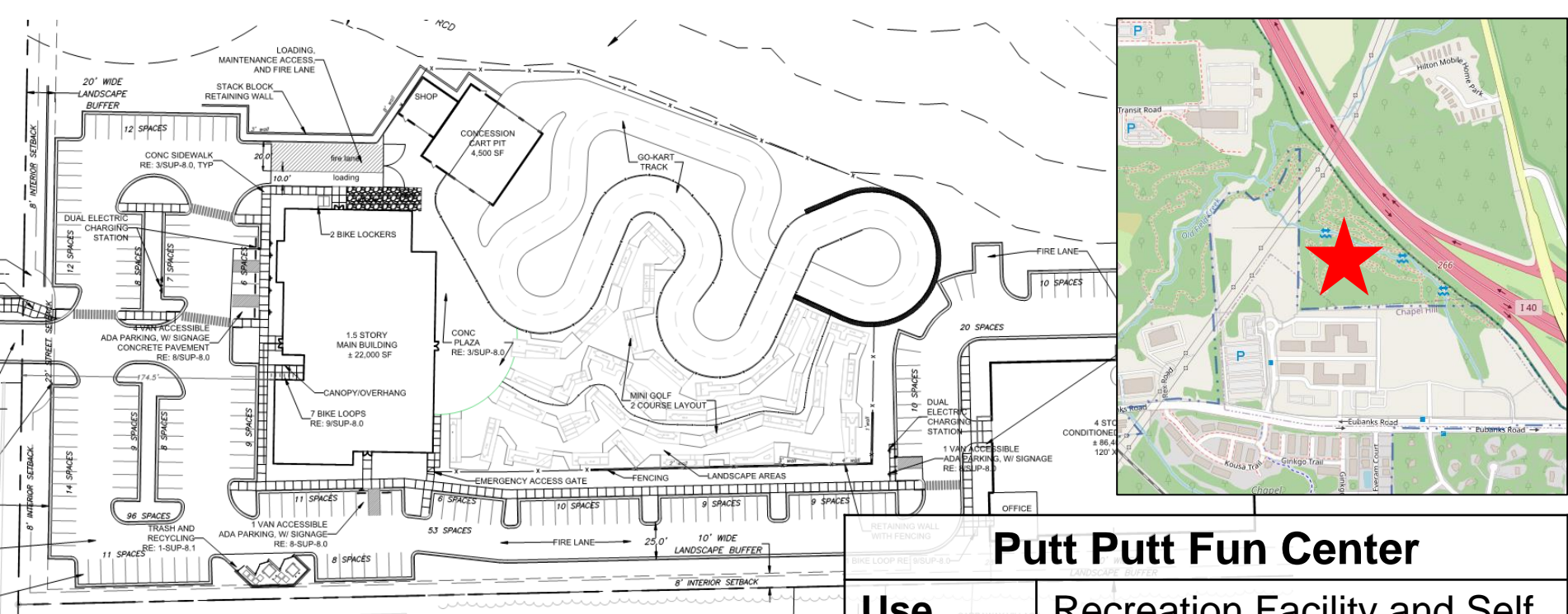

Putt Putt Fun Center

Use	Recreation Facility and Self Storage
Size	114,900 sf
Status	Final Plans – staff review

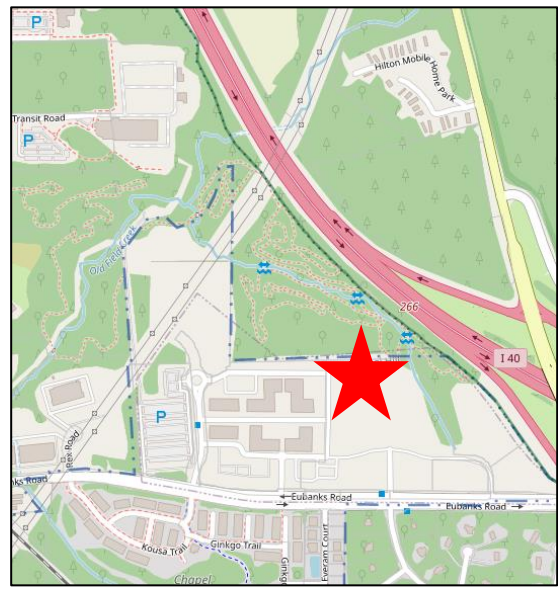
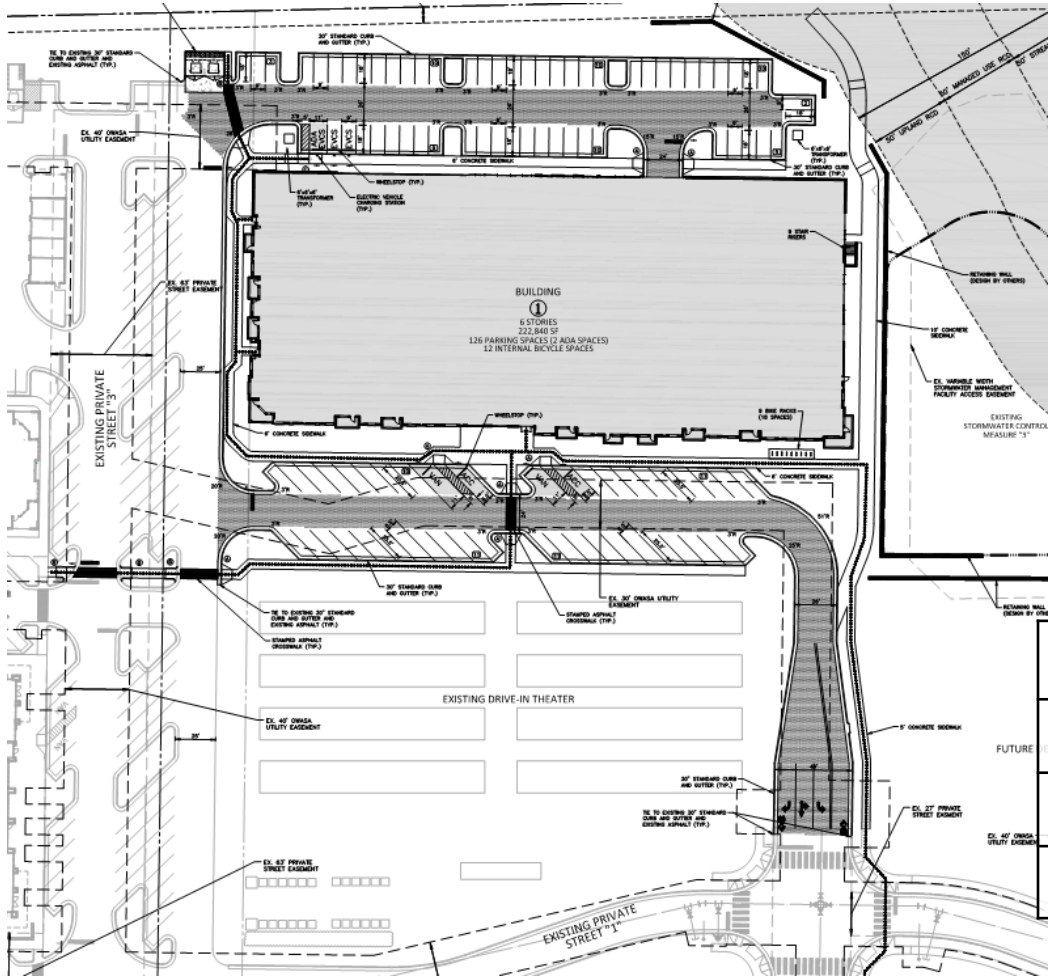

Carraway Phase 3

Use	Multifamily
Size	208 units; 222,840 sf
Status	Final Plans – staff review

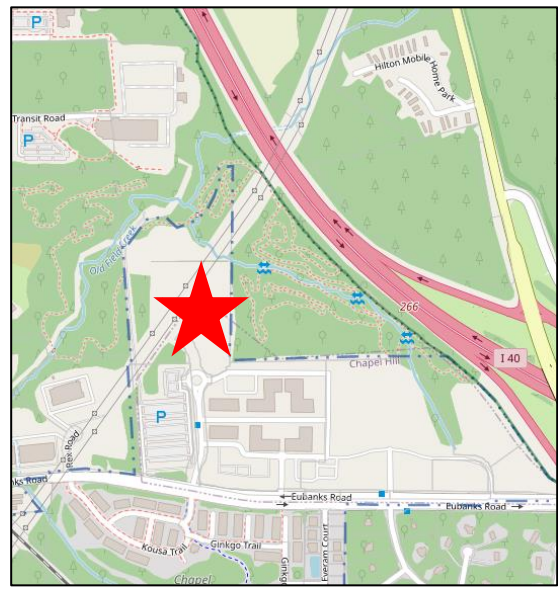

<h2 style="text-align: center;">Carraway Self-Storage (Block G)</h2>	
Use	Storage facility
Size	128,474 sf
Status	Final Plans – staff review

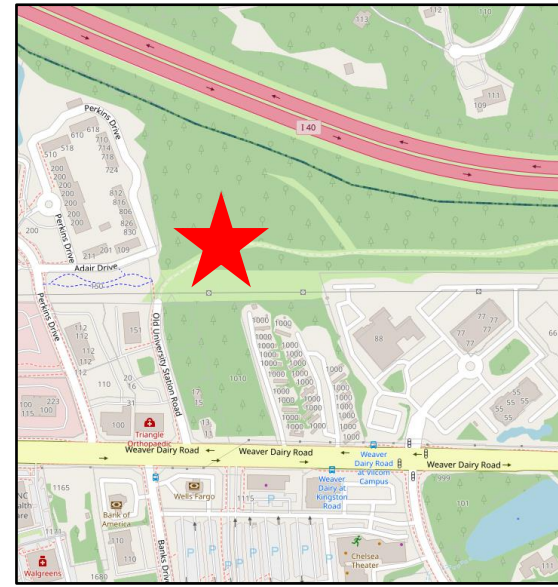

Lullwater	
Use	Multifamily
Size	310 units; 222,840 sf
Status	Concept Plan - September

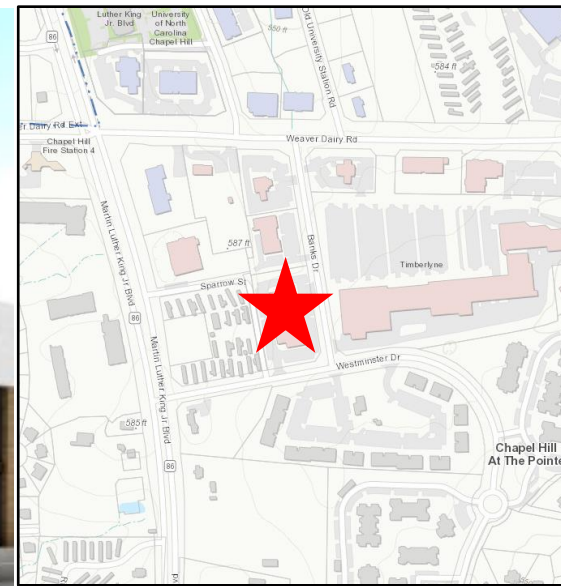

Timberlyne Office (Timberlyne Theatre)

Use	Office
Size	19,857 sf
Status	Final Plans – staff review

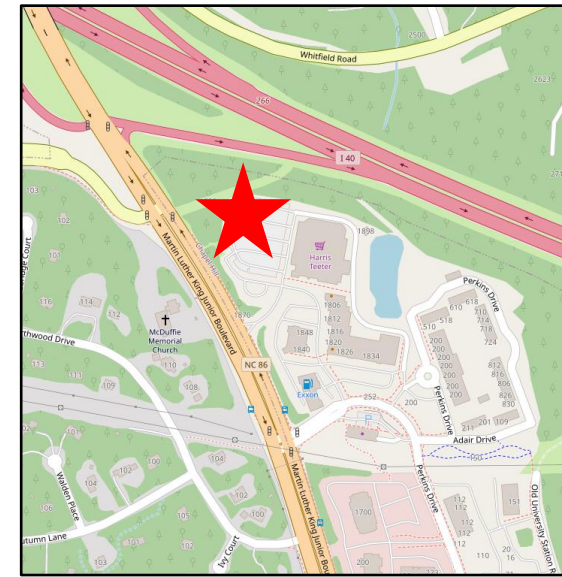

Harris Teeter expansion and Fuel Center

Use	Commercial
Size	11,800 sf expansion
Status	SUP – staff review

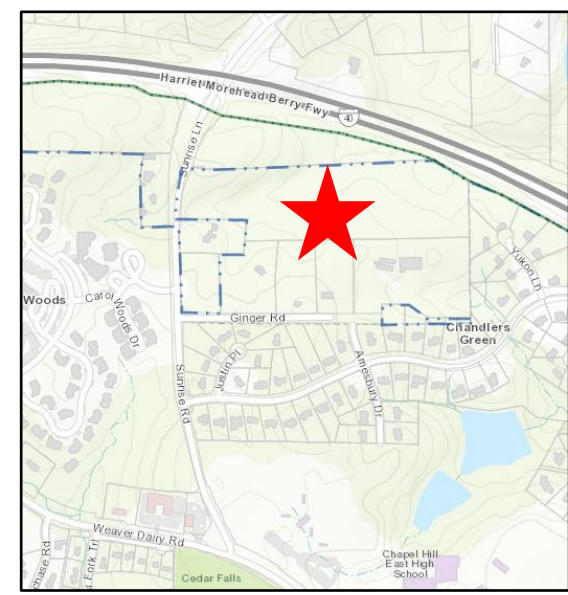

Weavers Grove	
Use	Multifamily/Mixed Use
Size	243 dwelling units 19,447 sf non-residential
Status	Final Plans – staff review



R-5-CZD

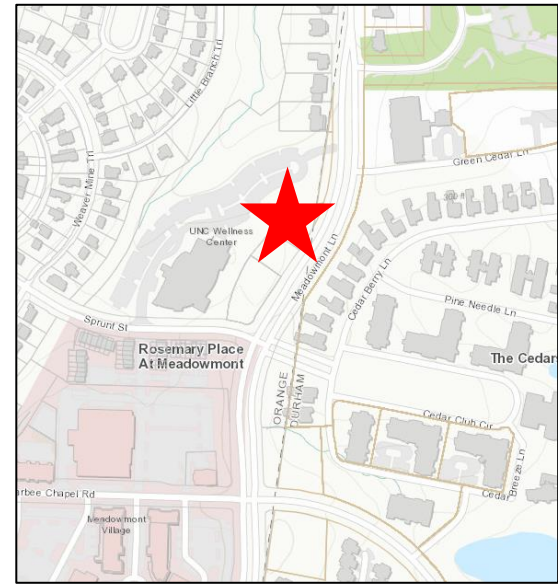
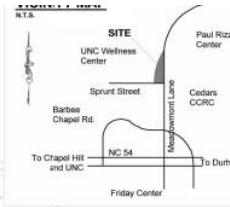
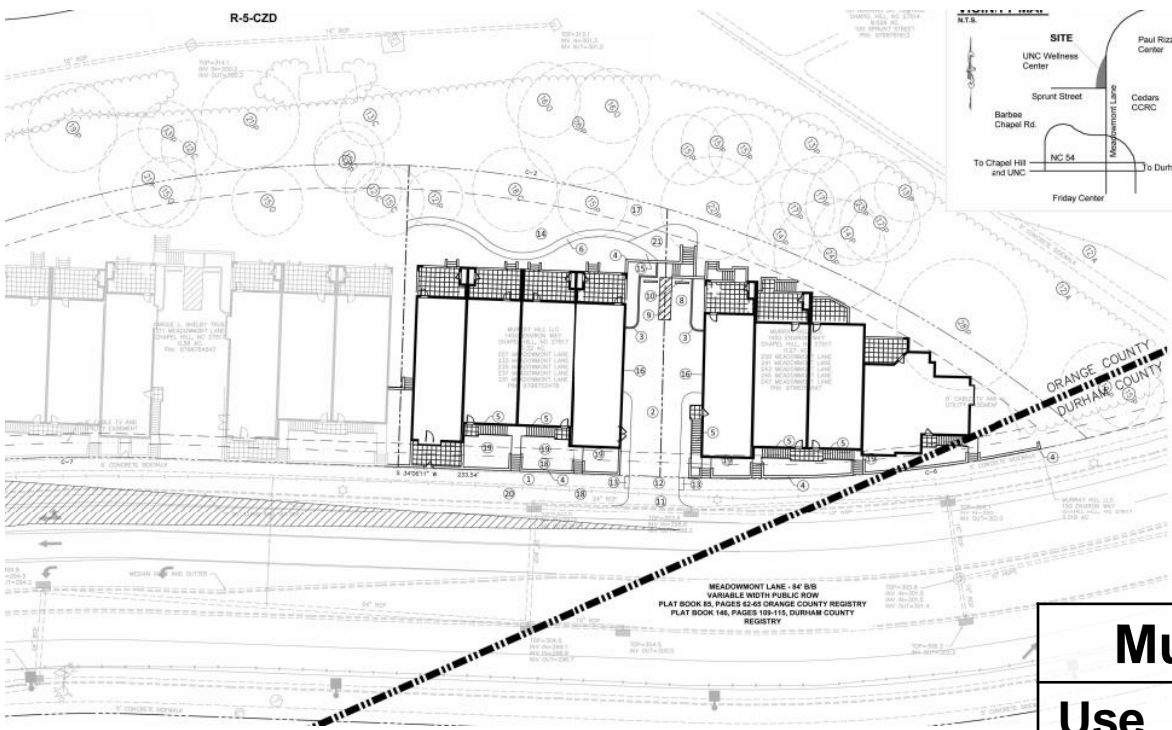

Murray Hill at Meadowmont

Use	Residential
Size	8 additional units
Status	SUP – staff review

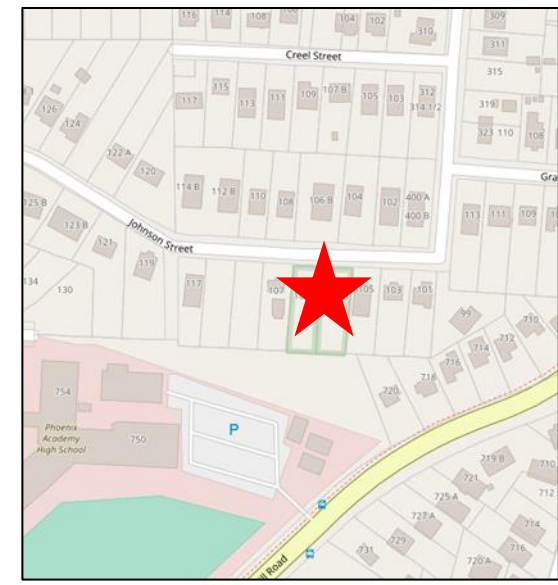
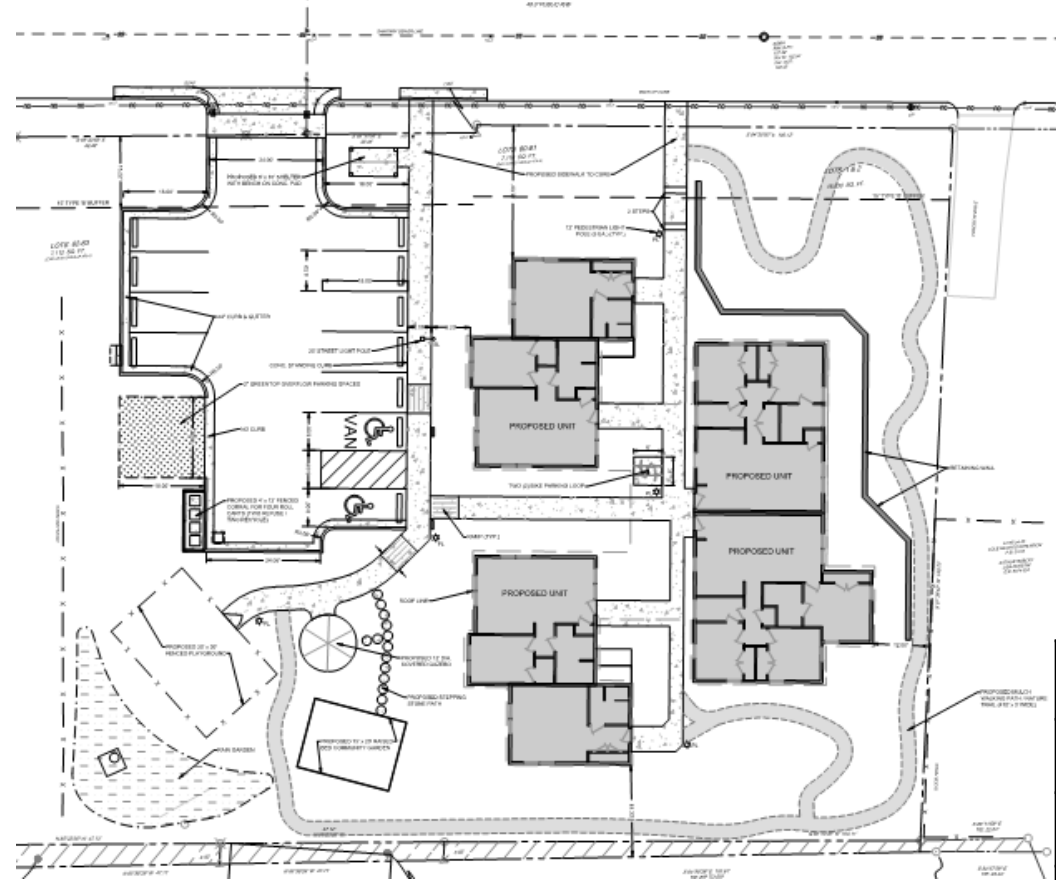

Peach Apartment	
Use	Multi-family
Size	10 units
Status	Concept Plan - CDC