

ROSEMARY PARKING DECK

PUBLIC INFORMATION MEETING

SEPTEMBER 20, 2021



AGENDA

- Design of Deck
- On-street parking changes
- Monitoring and addressing future conditions



**LIVE
CONSTRUCTION
CAMERA ON
PROJECT PAGE**



Sketch of Revised Left-Only Exit from Deck to North Street

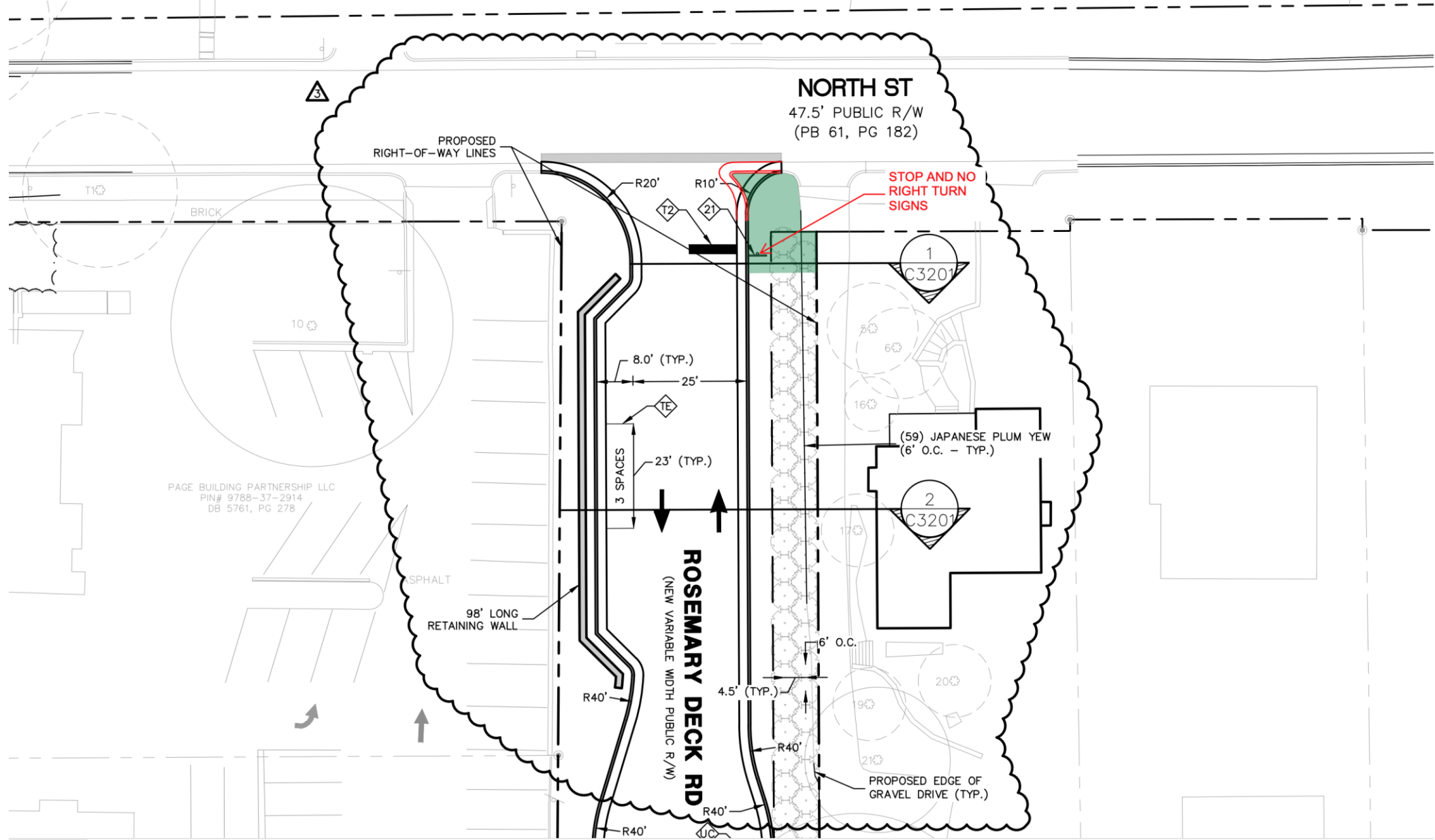

OVERVIEW

- Demolition has begun
- Construction through summer 2022
- Occupancy target October 2022
- Traffic Counts & Monitoring



Copy of North Street

Rosemary Deck Entry/Exit Configuration

All changes saved in Drive

Add layer Share Preview

Untitled layer

- Individual styles
- House 1 w/ no back parking
- House 2 w/ no back parking
- No Parking 24/7
- No Parking Zone 24/7
- Convert Judicial to Resident...
- Rosemary Deck
- Rosemary Deck

Base map

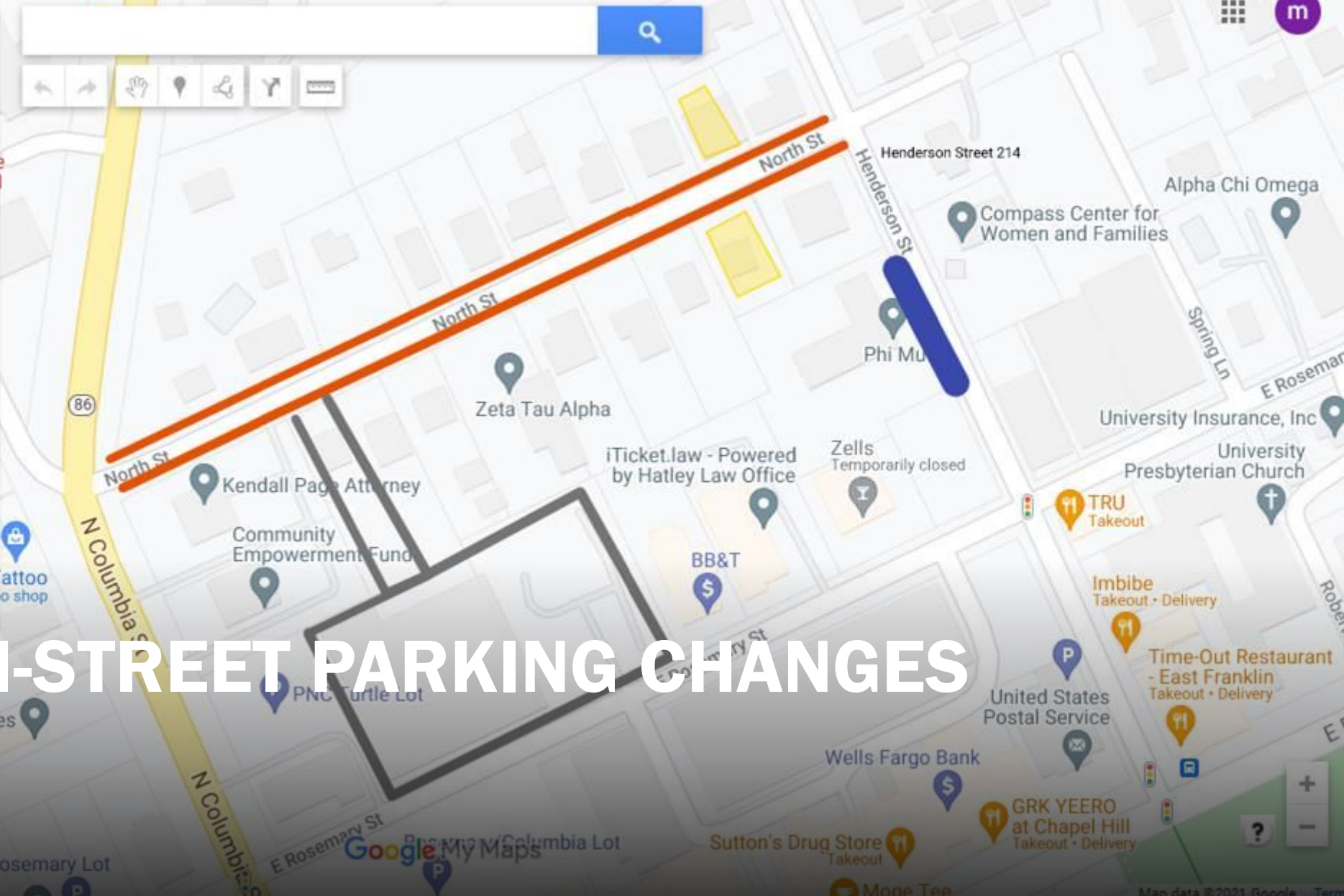

ON-STREET PARKING CHANGES

DISCUSSION

