

NOT USED



McADAMS

The John R. McAdams Company, Inc.
2905 Meridian Parkway
Durham, NC 27713

phone 919. 361. 5000
fax 919. 361. 2269
license number: C-0293

www.mcadamsco.com

CLIENT

RAM REALTY
2100 S. TRYON STREET SUITE 203
CHARLOTTE, NORTH CAROLINA 28203



UNIVERSITY PLACE
PHASE 1B + 1C
ZONING COMPLIANCE PERMIT
CHAPEL HILL, NC 27514

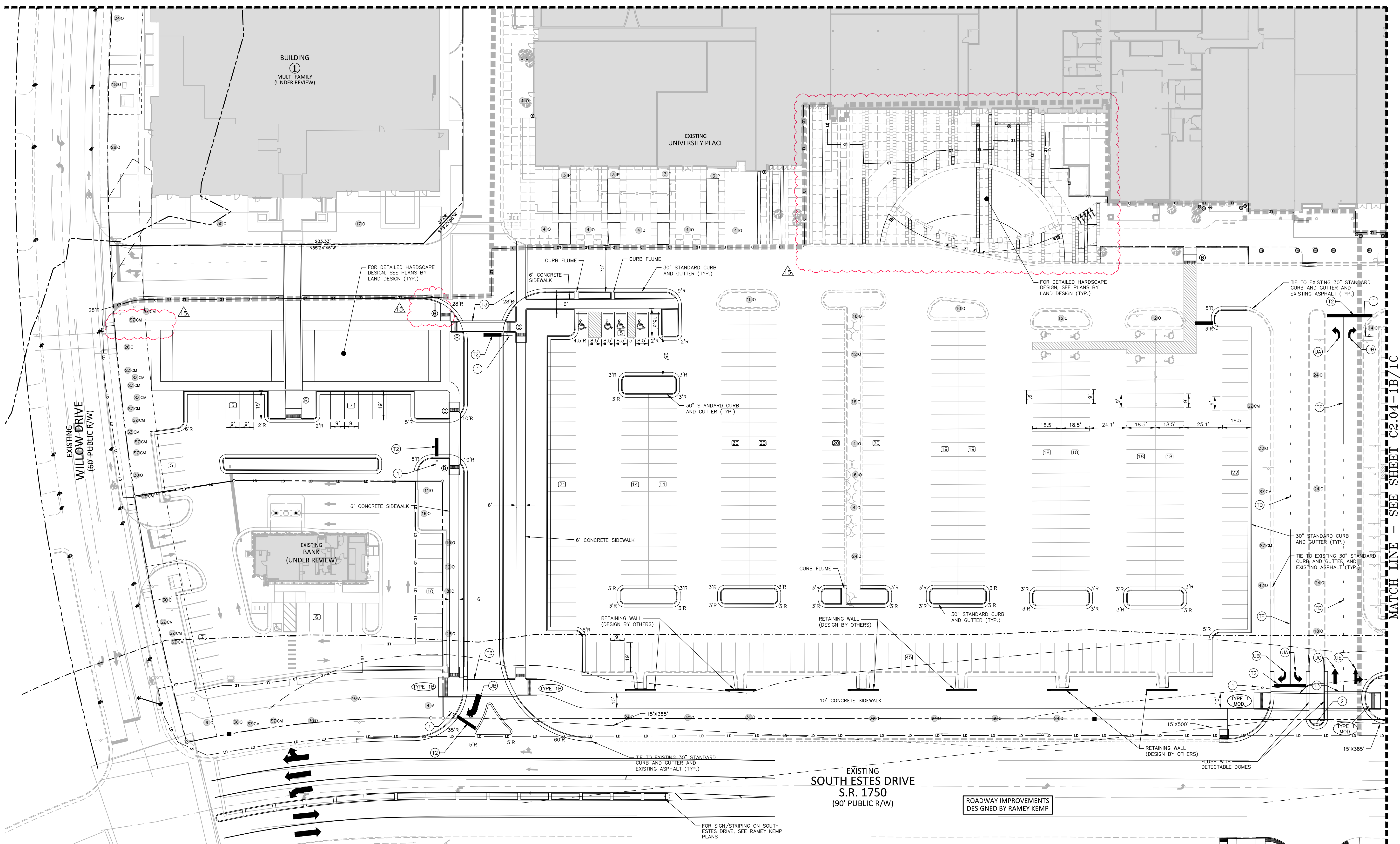
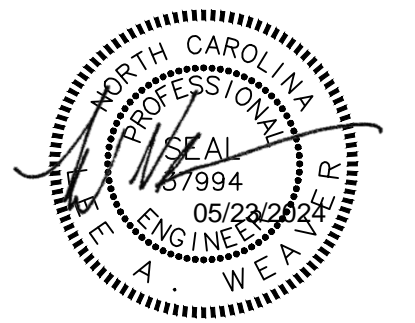

SITE LEGEND

	SIGNAGE		ACCESSIBLE ROUTE
	YARD LIGHTS		PHASE LINE
	LIGHT POLE		PROPERTY LINE
	POWER POLE		RIGHT-OF-WAY LINE
	TRAFFIC DIRECTIONAL ARROW		LOT LINE
	ACCESSIBLE PARKING STALL		EASEMENT LINE
	VAN ACCESSIBLE PARKING STALL		CENTERLINE
	PARKING SPACE COUNT		HEAVY DUTY ASPHALT PAVEMENT
	ACCESSIBLE RAMPS		

PAVEMENT MARKING LEGEND

LANE LINES/MARKINGS

T2 24" WHITE STOPBAR
T3 24" WHITE CROSSWALK LINE (HIGH VISIBILITY)
TD 4" WHITE MANUSIP (3" SP.)
TE 4" WHITE SOLID LANE LINE
TI 4" YELLOW DOUBLE CENTER

ARROWS/CHARACTERS

UA LEFT TURN ARROW
UB RIGHT TURN ARROW
UC STRAIGHT ARROW
LD COMBINATION STRAIGHT/LEFT TURN ARROW
LE COMBINATION STRAIGHT/RIGHT TURN ARROW
UF COMBINATION LEFT/RIGHT ARROW
UG COMBINATION LEFT/STRAIGHT/RIGHT ARROW
UR SHARROW

- PAVEMENT MARKING / SIGNAGE NOTES**
- ALL PAVEMENT MARKINGS WITHIN PUBLIC RIGHT OF WAY (INCLUDING DRIVEWAYS) SHALL BE THERMOPLASTIC AND ARE TO BE PLACED PER NCDOT STANDARDS (REFERENCE NCDOT DETAILS (1205.01-1205.12).
 - ALL PAVEMENT MARKINGS WITHIN THE SITE SHALL BE PAINT AND ARE TO BE PLACED PER NCDOT STANDARDS (REFERENCE NCDOT DETAILS (1205.01-1205.12).
 - ALL NEW SIGNS WILL INCLUDE PRISMATIC SHEETING AND WILL CONFORM TO THE LATEST RETROREFLECTIVITY STANDARDS FOUND IN THE LATEST EDITION OF THE MUTCD.
 - ALL SIGNS MUST MEET MUTCD GUIDELINES FOR LETTER HEIGHT, LETTER CASE AND SIGN COLOR.
 - EXISTING SIGNS SHALL BE RELOCATED TO THE APPROPRIATE LOCATION IN THE FIELD.



MUTCD R1-1

SEE SHEET C0.00 FOR ALL PROJECT, SITE, GRADING, STORM DRAINAGE AND UTILITY NOTES

ALL CONSTRUCTION SHALL BE IN ACCORDANCE WITH THE CURRENT TOWN OF CHAPEL HILL ENGINEERING DESIGN AND CONSTRUCTION STANDARDS

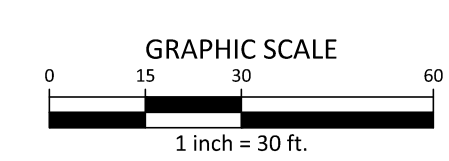
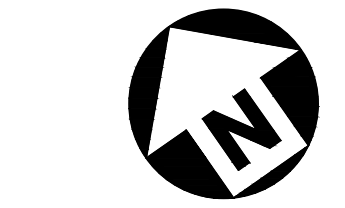

MATCH LINE - SEE SHEET C2.04-1B/1C

REVISIONS

NO.	DATE	DESCRIPTION
9	07.14.2023	FIRE HYDRANT REVISION
10	07.28.2023	WEST RIN/ROUT
11	08.24.2023	CHASE BANK EC PLANS
12	09.18.2023	NCDOT-SIDEWALK REVISION
13	09.27.2023	S-B BANK SPOT GRADES
14	02.28.2024	CHASE BANK EC SUBMITTAL
15	05.20.2024	ZCP UPDATE

PLAN INFORMATION

PROJECT NO.	RAM-19000
FILENAME	RAM19000-51
CHECKED BY	LAW
DRAWN BY	MRO
SCALE	1"=30'
DATE	09.18.2023

SHEET

SITE PLAN - INSET 'C'

C2.03-1B/1C

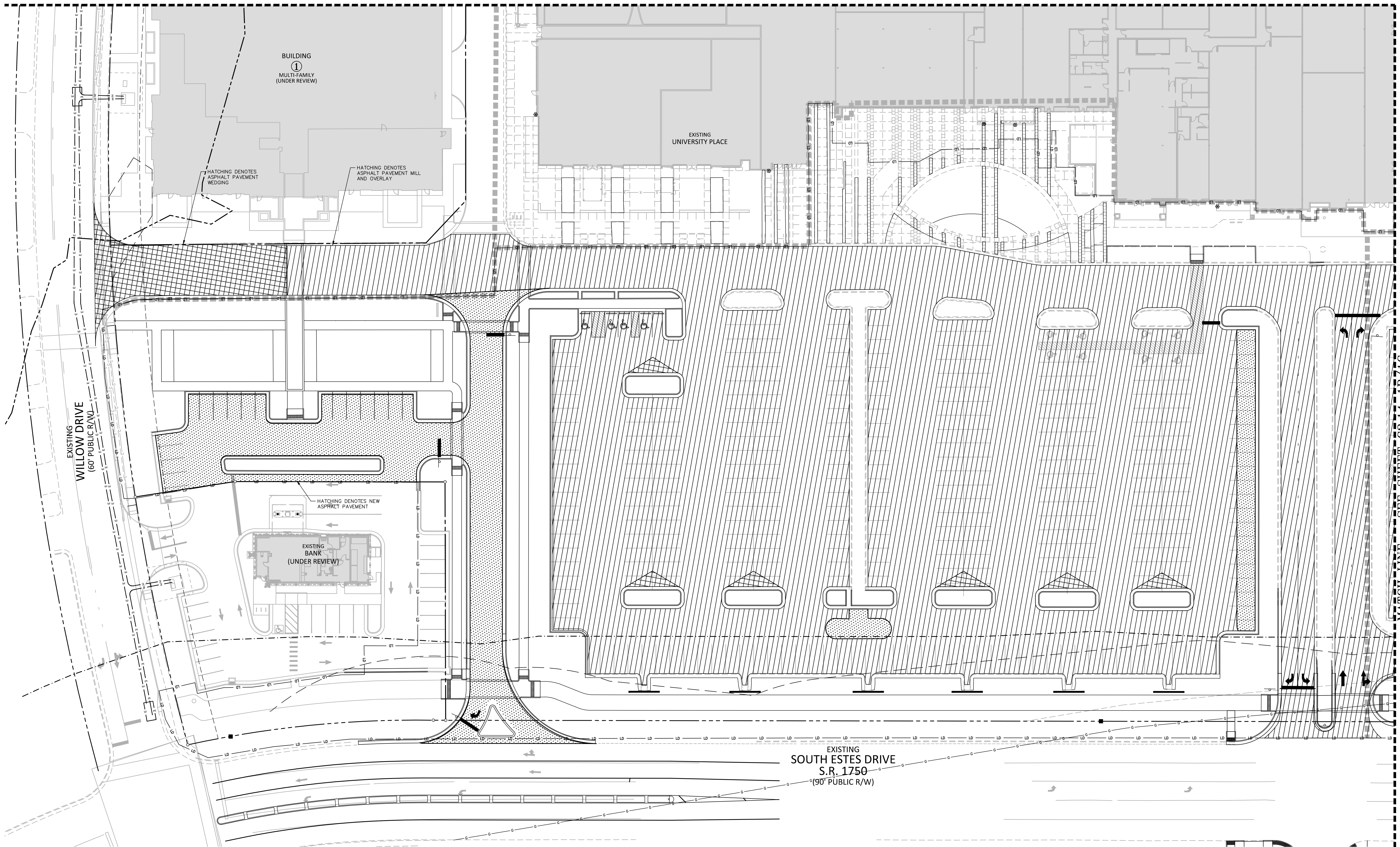

M:\Projects\RAM\2023110551\04-Production\Engineering\Construction Drawings\Retail-1\Current Drawings\RAM19000-51.dwg, 5/23/2024 8:38:59 AM, Lee Weaver

NOT USED



MATCH LINE - SEE SHEET C2.14-1B/1C

SITE LEGEND

-  HEAVY DUTY ASPHALT PAVEMENT
-  ASPHALT PAVEMENT MILL AND OVERLAY
-  ASPHALT PAVEMENT WEDGING

SEE SHEET C0.00 FOR ALL PROJECT, SITE, GRADING, STORM DRAINAGE AND UTILITY NOTES

ALL CONSTRUCTION SHALL BE IN ACCORDANCE WITH THE CURRENT TOWN OF CHAPEL HILL ENGINEERING DESIGN AND CONSTRUCTION STANDARDS

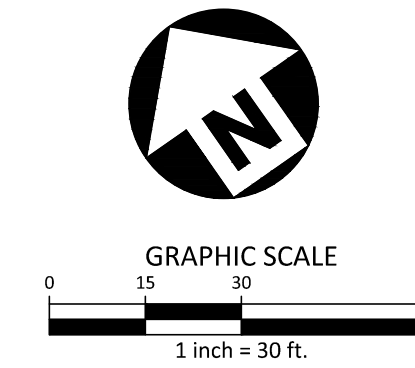



McADAMS
The John R. McAdams Company, Inc.
2905 Meridian Parkway
Durham, NC 27713
phone 919. 361. 5000
fax 919. 361. 2269
license number: C-0293
www.mcadamsco.com

CLIENT
RAM REALTY
2100 S. TRYON STREET SUITE 203
CHARLOTTE, NORTH CAROLINA 28203

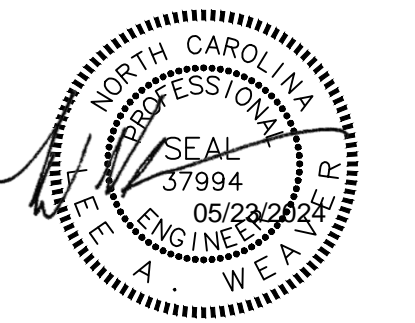

**UNIVERSITY PLACE
PHASE 1B + 1C
ZONING COMPLIANCE PERMIT**
CHAPEL HILL, NC 27514



REVISIONS

NO.	DATE	DESCRIPTION
9	07.14.2023	FIRE HYDRANT REVISION
10	07.28.2023	WEST RIN/ROUT
11	08.24.2023	CHASE BANK EC PLANS
12	09.18.2023	NCDDOT-SIDEWALK REVISION
13	09.27.2023	S-B BANK SPOT GRADES
14	02.28.2024	CHASE BANK EC SUBMITTAL
15	05.20.2024	ZCP UPDATE

PLAN INFORMATION

PROJECT NO. RAM-19000
 FILENAME RAM19000-S1
 CHECKED BY LAW
 DRAWN BY WHM
 SCALE 1"=30'
 DATE 09.18.2023

SHEET

**PAVEMENT PLAN -
INSET 'C'**
C2.13-1B/1C

M:\Projects\RAM\2023110551\04-Production\Engineering\Construction Drawings\Retail-1\Current Drawings\RAM19000-S2.dwg, 5/23/2024 8:19:06 AM, Lee Weaver

NOT USED



McADAMS

The John R. McAdams Company, Inc.
2905 Meridian Parkway
Durham, NC 27713

phone 919. 361. 5000
fax 919. 361. 2269
license number: C-0293

www.mcadamsco.com

CLIENT

RAM REALTY
2100 S. TRYON STREET SUITE 203
CHARLOTTE, NORTH CAROLINA 28203



**UNIVERSITY PLACE
PHASE 1B + 1C
ZONING COMPLIANCE PERMIT**
CHAPEL HILL, NC 27514



REVISIONS

NO.	DATE	DESCRIPTION
9	07.14.2023	FIRE HYDRANT REVISION
10	07.28.2023	WEST RIN/ROUT
11	08.24.2023	CHASE BANK EC PLANS
12	09.18.2023	NC DOT SIDEWALK REVISION
13	09.27.2023	S-B BANK SPOT GRADES
14	02.28.2024	CHASE BANK EC SUBMITTAL
15	05.20.2024	ZCP UPDATE

PLAN INFORMATION

PROJECT NO. RAM-19000
 FILENAME RAM19000-51
 CHECKED BY LAW
 DRAWN BY WHM
 SCALE 1"=30'
 DATE 09.18.2023

SHEET

**PAVEMENT PLAN -
INSET 'D'**

C2.14-1B/1C

MATCH LINE - SEE SHEET C2.13-1B/1C

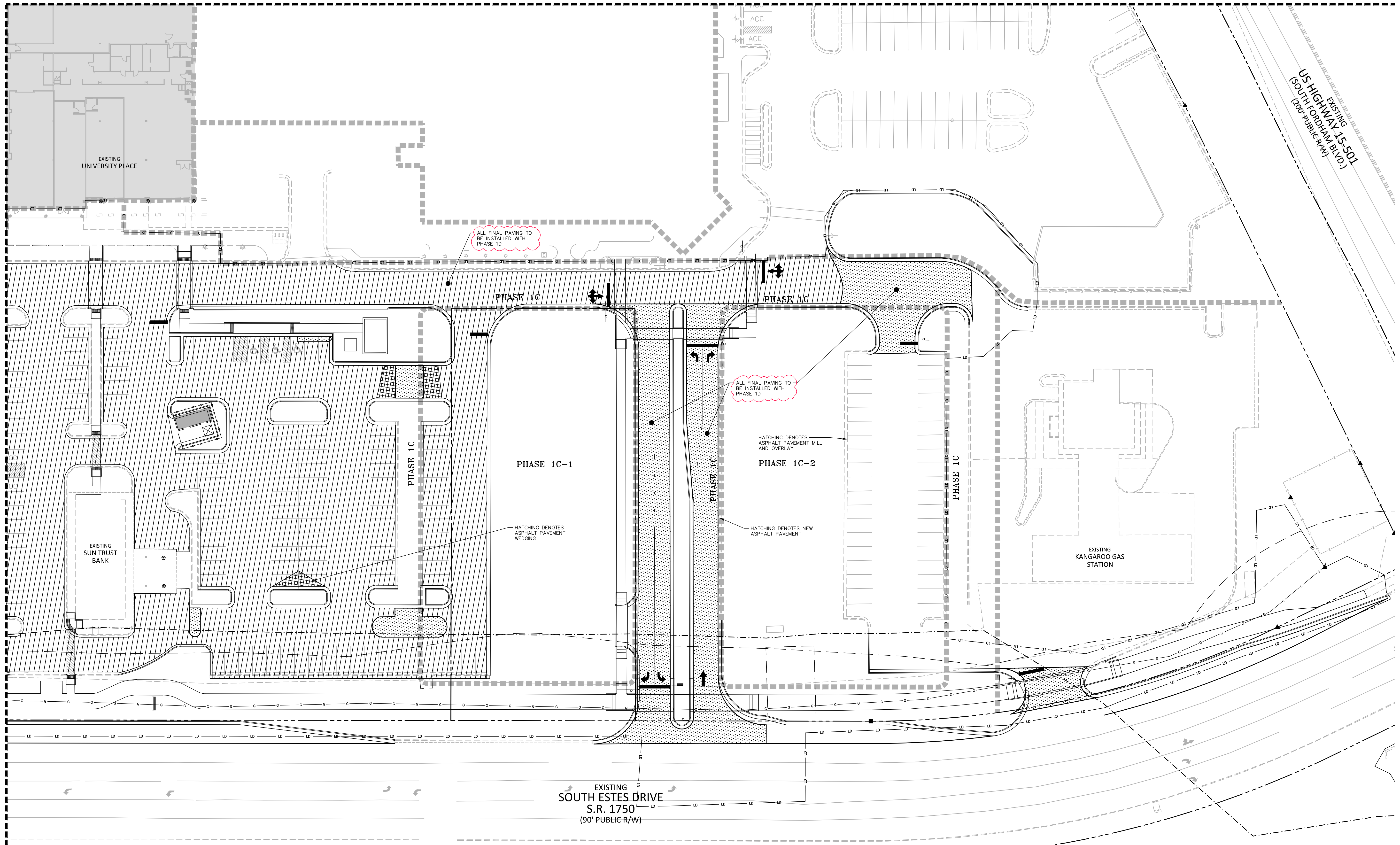

SITE LEGEND

- HEAVY DUTY ASPHALT PAVEMENT
- ASPHALT PAVEMENT MILL AND OVERLAY
- ASPHALT PAVEMENT WEDGING

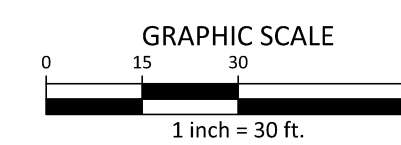
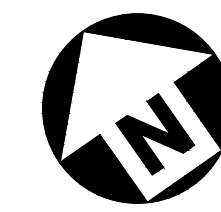

SEE SHEET C0.00 FOR ALL PROJECT, SITE, GRADING, STORM DRAINAGE AND UTILITY NOTES

ALL CONSTRUCTION SHALL BE IN ACCORDANCE WITH THE CURRENT TOWN OF CHAPEL HILL ENGINEERING DESIGN AND CONSTRUCTION STANDARDS

SEE SHEET C0.00 FOR ALL PROJECT, SITE, GRADING, STORM DRAINAGE AND UTILITY NOTES

ALL CONSTRUCTION SHALL BE IN ACCORDANCE WITH THE CURRENT TOWN OF CHAPEL HILL ENGINEERING DESIGN AND CONSTRUCTION STANDARDS

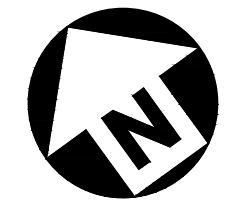

GRAPHIC SCALE
0 30 60 120
1 inch = 60 ft.

GRADING LEGEND

- FLARED END SECTION
- ENDWALL SECTION
- CATCH BASIN
- DROP INLET
- STORM SERVICE INLET
- STORM SERVICE ROOF-RAIN
- JUNCTION BOX
- DRAINAGE FLOW ARROW
- LINE BREAK SYMBOL
- TOP & BOTTOM CURB ELEVATIONS
- TW=223.00
TOP OF WALL ELEVATION
- BW=213.00
BOTTOM OF WALL ELEVATION
(NOTE: BOTTOM OF WALL IS GROUND ELEVATION NOT WALL FOUNDATION)
- + 250.60
SPOT ELEVATION
- STORM DRAINAGE
- STORM SERVICE LINE
- RD RD RD
ROOF DRAIN, 8" ADS
NON-PERFORATED TUBING OR
EQUAL 1.0% MIN. SLOPE 3" MIN.
COVER PVC SCHEDULE 40 IN
TRAFFIC AREAS
- TP TP TP
TREE PROTECTION FENCE
- LD LD
LIMITS OF DISTURBANCE
- WOODED AREA
- 250
MAJOR CONTOUR
- 252
MINOR CONTOUR
- 250
EXISTING MAJOR CONTOUR
- 252
EXISTING MINOR CONTOUR
- EASEMENT LINE
- ACCESSIBLE PARKING AREA
(2% MAX. SLOPE IN ALL DIRECTIONS)

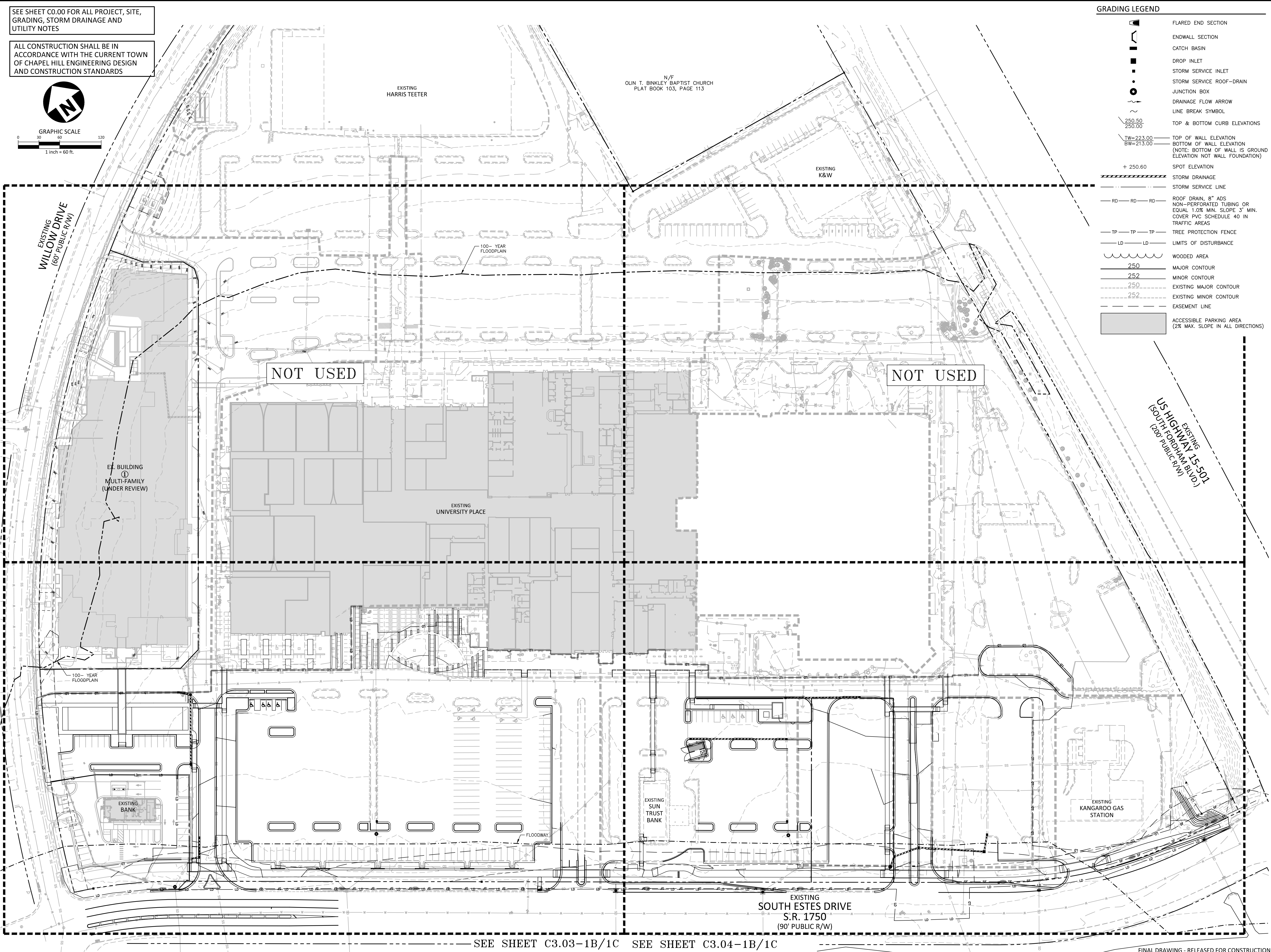

McADAMS
The John R. McAdams Company, Inc.
2905 Meridian Parkway
Durham, NC 27713
phone 919.361.5000
fax 919.361.2269
license number: C-0293
www.mcadamsco.com

CLIENT
RAM REALTY
2100 S. TRYON STREET SUITE 203
CHARLOTTE, NORTH CAROLINA 28203



**UNIVERSITY PLACE
PHASE 1B + 1C
ZONING COMPLIANCE PERMIT**
CHAPEL HILL, NC 27514



REVISIONS

NO.	DATE	DESCRIPTION
9	07.14.2023	FIRE HYDRANT REVISION
10	07.28.2023	WEST RIN/ROUT
11	08.24.2023	CHASE BANK EC PLANS
12	09.18.2023	NCDOT-SIDEWALK REVISION
13	09.27.2023	5-3 BANK SPOT GRADES
14	02.28.2024	CHASE BANK EC SUBMITTAL
15	05.20.2024	ZCP UPDATE

PLAN INFORMATION

PROJECT NO.	RAM-19000
FILENAME	RAM19000-OAG1
CHECKED BY	LAW
DRAWN BY	MRO
SCALE	1"=60'
DATE	09.18.2023

SHEET
OVERALL GRADING AND STORM DRAINAGE PLAN

C3.00-1B/1C

SEE SHEET C3.03-1B/1C SEE SHEET C3.04-1B/1C

FINAL DRAWING - RELEASED FOR CONSTRUCTION

M:\Projects\RAMA\202110551\04-Production\Engineering\Construction Drawings\Retail-1\Current Drawings\RAM19000-OAG1.dwg, 5/23/2024 8:19:13 AM, Lee Weaver

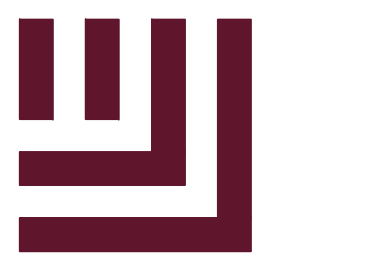

McADAMS

The John R. McAdams Company, Inc.
2905 Meridian Parkway
Durham, NC 27713

phone 919. 361. 5000
fax 919. 361. 2269
license number: C-0293

www.mcadamsco.com

CLIENT

RAM REALTY
2100 S. TRYON STREET SUITE 203
CHARLOTTE, NORTH CAROLINA 28203



UNIVERSITY PLACE
PHASE 1B + 1C
ZONING COMPLIANCE PERMIT
CHAPEL HILL, NC 27514

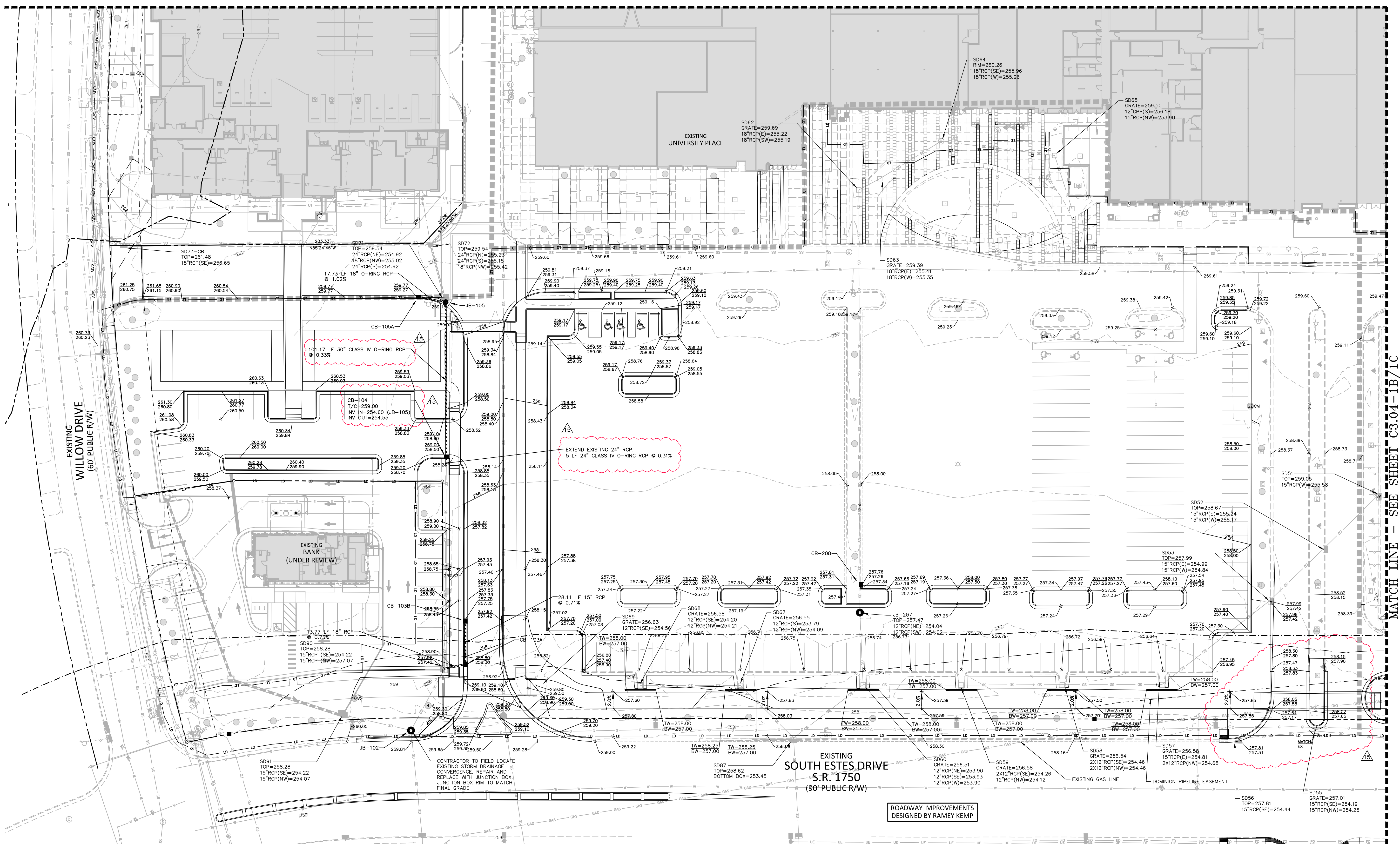

GRADING LEGEND

- FLARED END SECTION
- ENDWALL SECTION
- CATCH BASIN
- DROP INLET
- STORM SERVICE INLET
- STORM SERVICE ROOF-DRAIN
- JUNCTION BOX
- DRAINAGE FLOW ARROW
- LINE BREAK SYMBOL
- EXISTING TOP & BOTTOM CURB ELEVATIONS
- PROPOSED TOP & BOTTOM CURB ELEVATIONS
- TOP OF WALL ELEVATION
- BOTTOM OF WALL ELEVATION
- (NOTE: BOTTOM OF WALL IS GROUND ELEVATION NOT WALL FOUNDATION)
- STORM DRAINAGE
- STORM SERVICE LINE
- TREE PROTECTION FENCE
- LIMITS OF DISTURBANCE
- WOODED AREA
- MAJOR CONTOUR
- MINOR CONTOUR
- EXISTING MAJOR CONTOUR
- EXISTING MINOR CONTOUR
- EASEMENT LINE
- ACCESSIBLE PARKING AREA (2% MAX. SLOPE IN ALL DIRECTIONS)

- CB-103A
T/C=258.80
INV IN=254.25 (CB-103B)
INV OUT=254.25
- CB-103B
T/C=257.75
INV OUT=254.45
- CB-103C
TOP=259.54
INV IN=255.02 (CB-105A)
INV IN=254.92 (SD72)
INV OUT=254.92
- CB-105A
T/C=259.65
INV OUT=255.20
- CB-208
T/C=257.76
INV IN=254.12 (EX. DI-209)
INV OUT=254.12

ROADWAY IMPROVEMENTS
DESIGNED BY RAMEY KEMP

SEE SHEET C0.00 FOR ALL PROJECT, SITE,
GRADING, STORM DRAINAGE AND
UTILITY NOTES

ALL CONSTRUCTION SHALL BE IN
ACCORDANCE WITH THE CURRENT TOWN
OF CHAPEL HILL ENGINEERING DESIGN
AND CONSTRUCTION STANDARDS

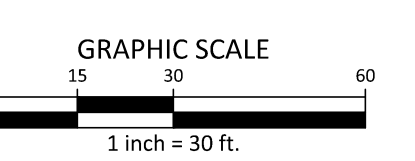
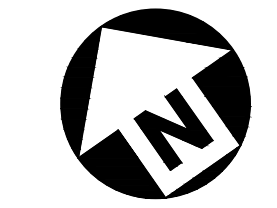

MATCH LINE - SEE SHEET C3.04-1B/1C

REVISIONS

NO.	DATE	DESCRIPTION
9	07.14.2023	FIRE HYDRANT REVISION
10	07.28.2023	WEST RIN/ROUT
11	08.24.2023	CHASE BANK EC PLANS
12	09.18.2023	NCDOT-SIDEWALK REVISION
13	09.27.2023	5-3 BANK SPOT GRADES
14	02.28.2024	CHASE BANK EC SUBMITTAL
15	05.20.2024	ZCP UPDATE

PLAN INFORMATION

PROJECT NO.	RAM-19000
FILENAME	RAM19000-OAG1
CHECKED BY	LAW
DRAWN BY	MRO
SCALE	1"=30'
DATE	09.18.2023

SHEET

GRADING AND STORM
DRAINAGE PLAN - INSET 'C'

C3.03-1B/1C

M:\Projects\RAM\2023\10551\04-Production\Engineering\Construction Drawings\RAM19000-G1.dwg, 5/23/2024 8:59:31 AM, Lee Weaver

SEE SHEET C0.00 FOR ALL PROJECT, SITE, GRADING, STORM DRAINAGE AND UTILITY NOTES

ALL CONSTRUCTION SHALL BE IN ACCORDANCE WITH THE CURRENT TOWN OF CHAPEL HILL ENGINEERING DESIGN AND CONSTRUCTION STANDARDS

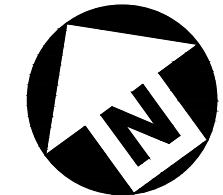

GRAPHIC SCALE
0 30 60 120
1 inch = 60 ft.

UTILITY LEGEND

- FIRE HYDRANT ASSEMBLY
- FIRE DEPARTMENT CONNECTION (FDC)
- WATER METER
- WATER VALVE
- POST INDICATOR VALVE
- VALVE IN MANHOLE
- METER & VAULT
- BACKFLOW PREVENTER
- REDUCER
- PLUG
- BLOW-OFF ASSEMBLY
- SANITARY SEWER MANHOLE
- SEWER CLEAN-OUT
- GREASE TRAP
- SEWER FLOW DIRECTION ARROW
- YARD LIGHTS
- LIGHT POLE
- POWER POLE
- LINE BREAK SYMBOL
- WATERLINE
- WATER SERVICE LINE
- UTILITY SLEEVE
- SANITARY SEWER
- SEWER SERVICE LINE
- SEWER FORCE MAIN
- GAS LINE
- OVERHEAD UTILITY
- UNDERGROUND ELECTRIC
- TELEPHONE
- EASEMENT LINE

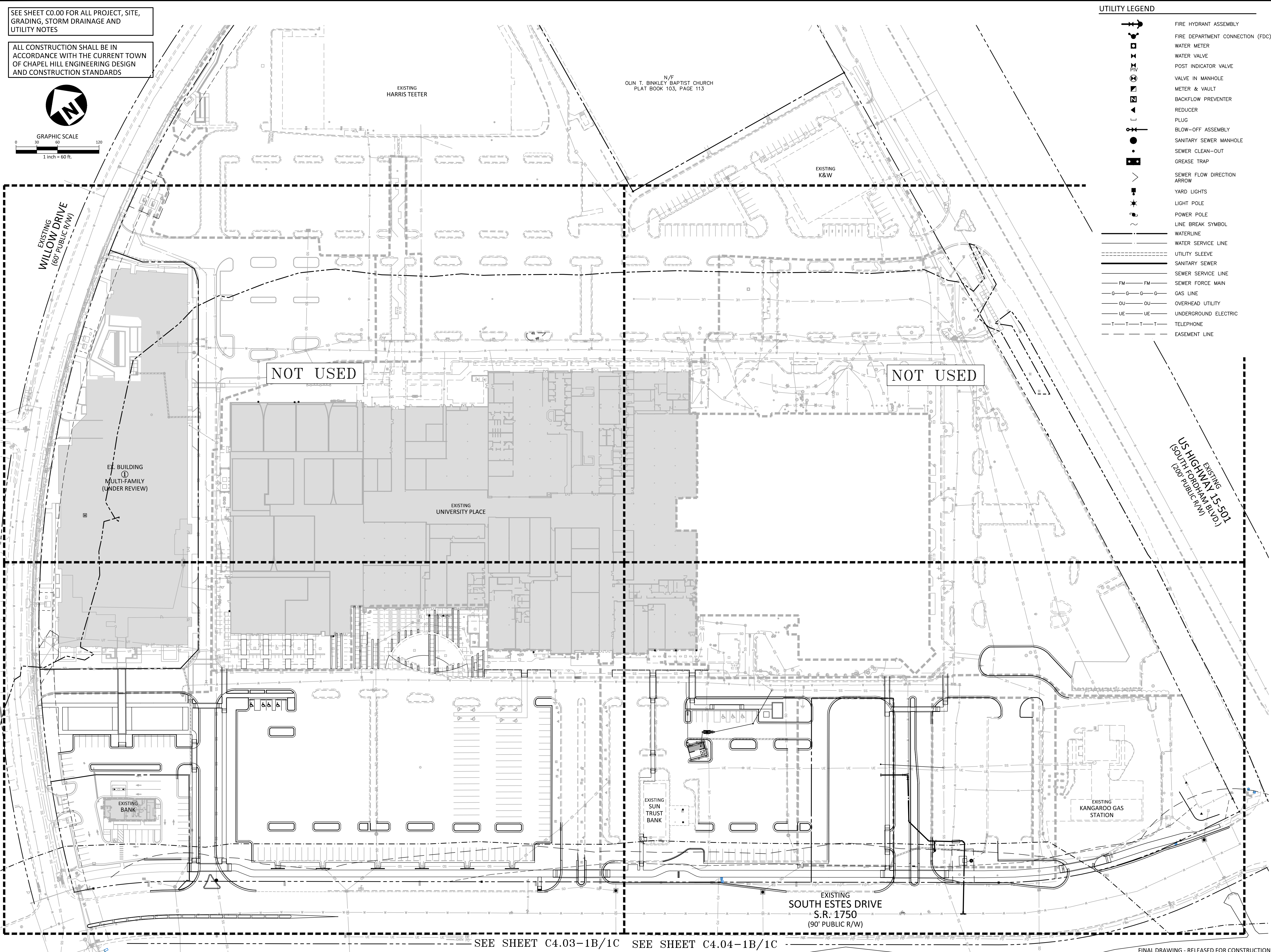

McADAMS
The John R. McAdams Company, Inc.
2905 Meridian Parkway
Durham, NC 27713
phone 919. 361. 5000
fax 919. 361. 2269
license number: C-0293
www.mcadamsco.com

CLIENT
RAM REALTY
2100 S. TRYON STREET SUITE 203
CHARLOTTE, NORTH CAROLINA 28203



**UNIVERSITY PLACE
PHASE 1B + 1C
ZONING COMPLIANCE PERMIT**
CHAPEL HILL, NC 27514

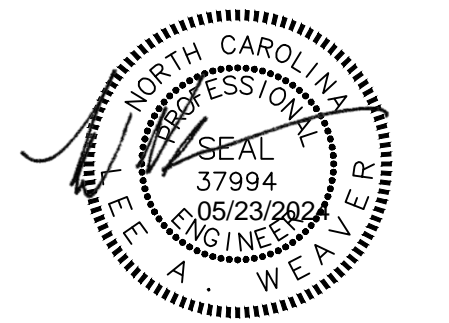

REVISIONS

NO.	DATE	DESCRIPTION
9	07.14.2023	FIRE HYDRANT REVISION
10	07.28.2023	WEST RIN/ROUT
11	08.24.2023	CHASE BANK EC PLANS
12	09.18.2023	NCDOT SIDEWALK REVISION
13	09.27.2023	S-3 BANK SPOT GRADES
14	02.28.2024	CHASE BANK EC SUBMITTAL
15	05.20.2024	ZCP UPDATE

PLAN INFORMATION

PROJECT NO.	RAM-19000
FILENAME	RAM19000-OAU1
CHECKED BY	LAW
DRAWN BY	MRO
SCALE	1"=60'
DATE	09.18.2023

**OVERALL UTILITY PLAN
C4.00-1B/1C**

M:\Projects\RAMA\202110551\04-Production\Engineering\Construction Drawings\Retail-1\Current Drawings\RAM19000-OAU1.dwg, 5/23/2024 8:19:30 AM, Lee Weaver

SEE SHEET C4.03-1B/1C SEE SHEET C4.04-1B/1C

FINAL DRAWING - RELEASED FOR CONSTRUCTION

NOT USED

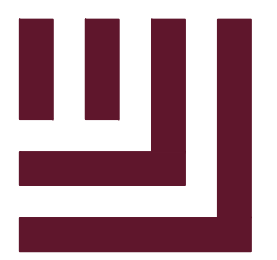

McADAMS

The John R. McAdams Company, Inc.
2905 Meridian Parkway
Durham, NC 27713

phone 919. 361. 5000
fax 919. 361. 2269
license number: C-0293

www.mcadamsco.com

CLIENT

RAM REALTY
2100 S. TRYON STREET SUITE 203
CHARLOTTE, NORTH CAROLINA 28203



UNIVERSITY PLACE
PHASE 1B + 1C
ZONING COMPLIANCE PERMIT
CHAPEL HILL, NC 27514



REVISIONS

NO.	DATE	DESCRIPTION
9	07.14.2023	FIRE HYDRANT REVISION
10	07.28.2023	WEST RIN/ROUT
11	08.24.2023	CHASE BANK EC PLANS
12	09.18.2023	NCDDP-SIDEWALK REVISION
13	09.27.2023	S-3 BANK SPOT GRADES
14	02.28.2024	CHASE BANK EC SUBMITTAL
15	05.20.2024	ZCP UPDATE

PLAN INFORMATION

PROJECT NO. RAM-19000
 FILENAME RAM19000-U1
 CHECKED BY LAW
 DRAWN BY MRO
 SCALE 1"=30'
 DATE 09.18.2023

SHEET

UTILITY PLAN -
INSET 'C'
C4.03-1B/1C

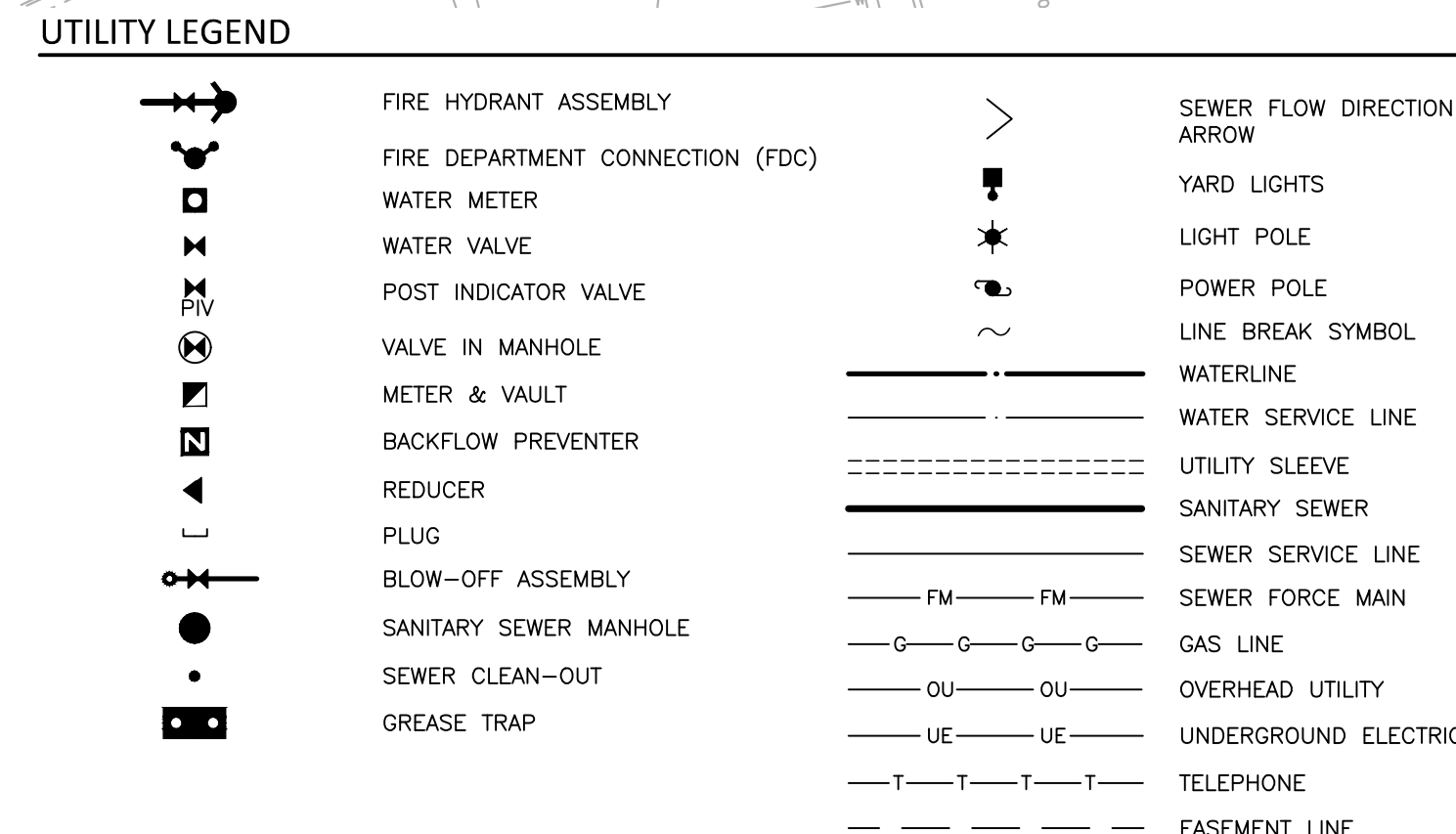
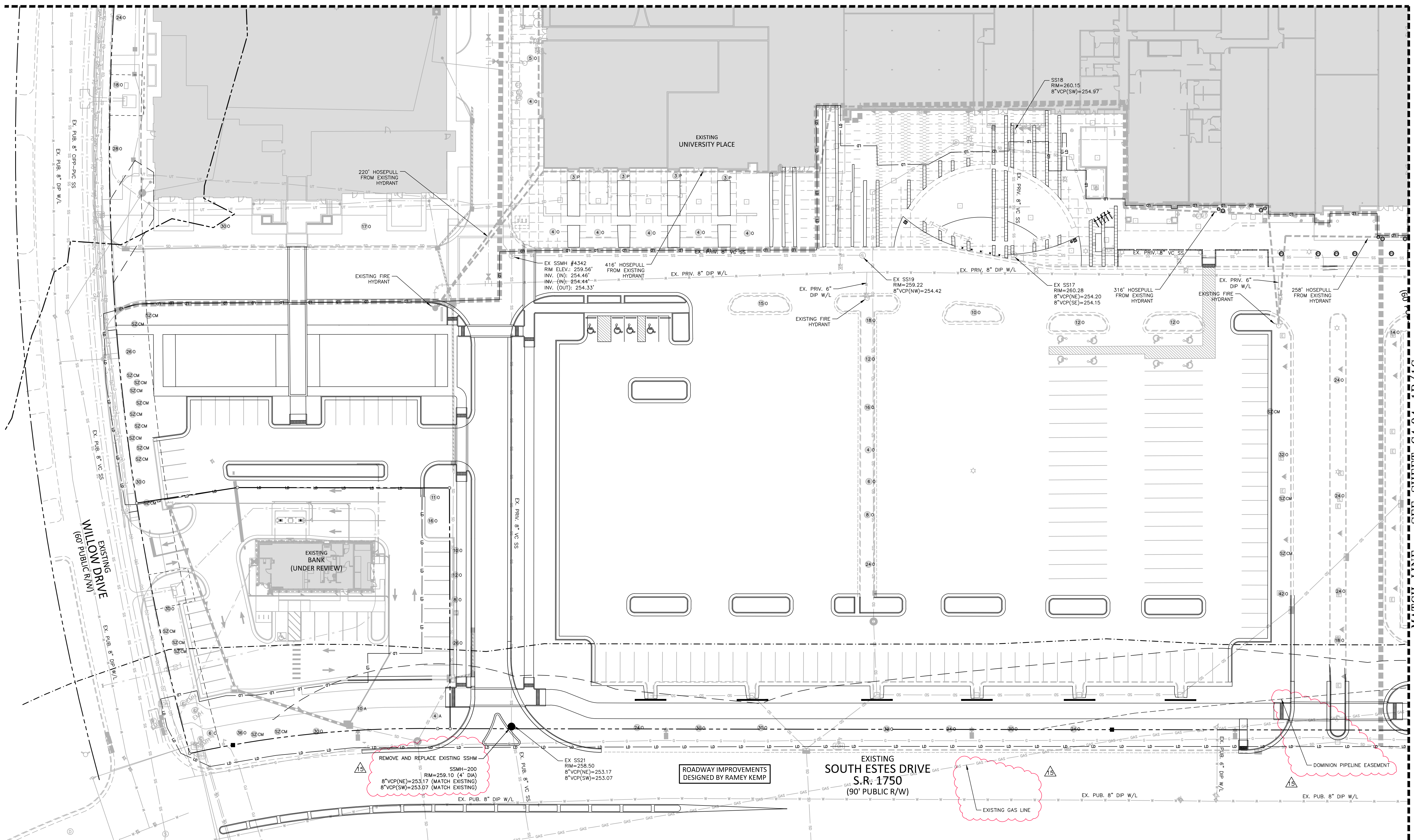

ROADWAY IMPROVEMENTS
DESIGNED BY RAMEY KEMP

EXISTING SOUTH ESTES DRIVE
S.R. 1750
(90' PUBLIC R/W)

SEE SHEET C0.00 FOR ALL PROJECT, SITE,
GRADING, STORM DRAINAGE AND
UTILITY NOTES

ALL CONSTRUCTION SHALL BE IN
ACCORDANCE WITH THE CURRENT TOWN
OF CHAPEL HILL ENGINEERING DESIGN
AND CONSTRUCTION STANDARDS

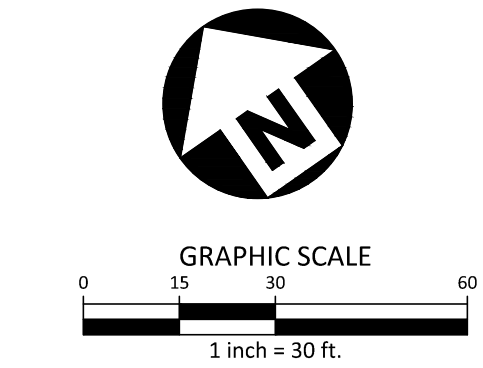

M:\Projects\RAM\2023110551\04-Production\Engineering\Construction Drawings\Retail-1\Current Drawings\RAM19000-U1.dwg, 5/23/2024 8:13:36 AM, Lee Wosner

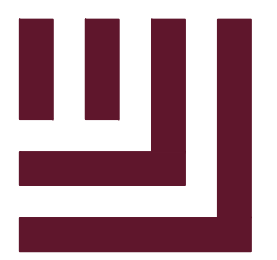

McADAMS

The John R. McAdams Company, Inc.
2905 Meridian Parkway
Durham, NC 27713

phone 919. 361. 5000
fax 919. 361. 2269
license number: C-0293

www.mcadamsco.com

CLIENT

RAM REALTY
2100 S. TRYON STREET SUITE 203
CHARLOTTE, NORTH CAROLINA 28203



UNIVERSITY PLACE
PHASE 1B + 1C
ZONING COMPLIANCE PERMIT
CHAPEL HILL, NC 27514



REVISIONS

NO.	DATE	DESCRIPTION
9	07.14.2023	FIRE HYDRANT REVISION
10	07.28.2023	WEST RIN/ROUT
11	08.24.2023	CHASE BANK EC PLANS
12	09.18.2023	NCDDT-SIDEWALK REVISION
13	09.27.2023	S-B BANK SPOT GRADES
14	02.28.2024	CHASE BANK EC SUBMITTAL
15	05.20.2024	ZCP UPDATE

PLAN INFORMATION

PROJECT NO. RAM-19000
 FILENAME RAM19000-01
 CHECKED BY LAW
 DRAWN BY MRO
 SCALE 1"=30'
 DATE 09.18.2023

SHEET

UTILITY PLAN -
INSET 'D'
C4.04-1B/1C

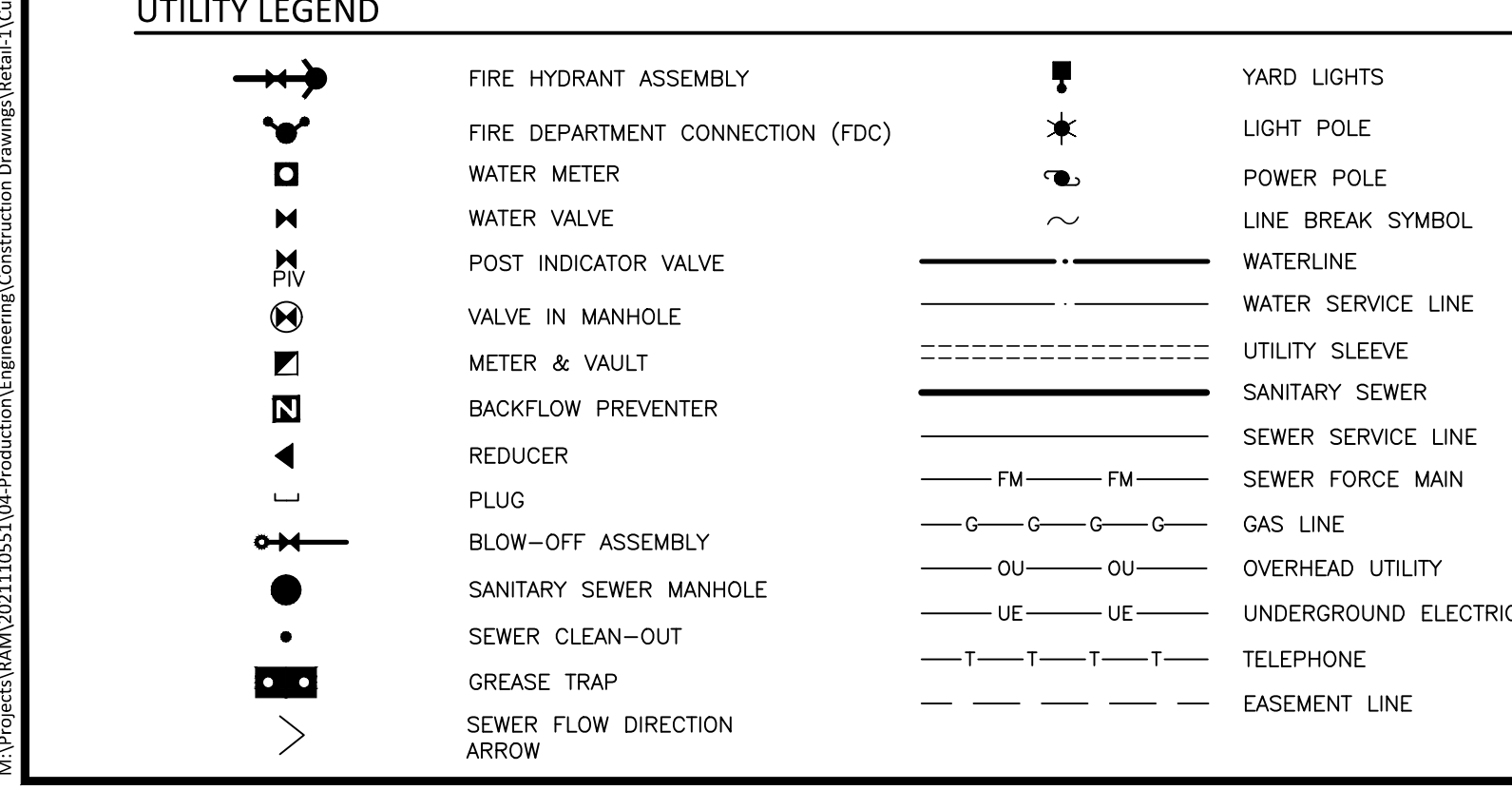
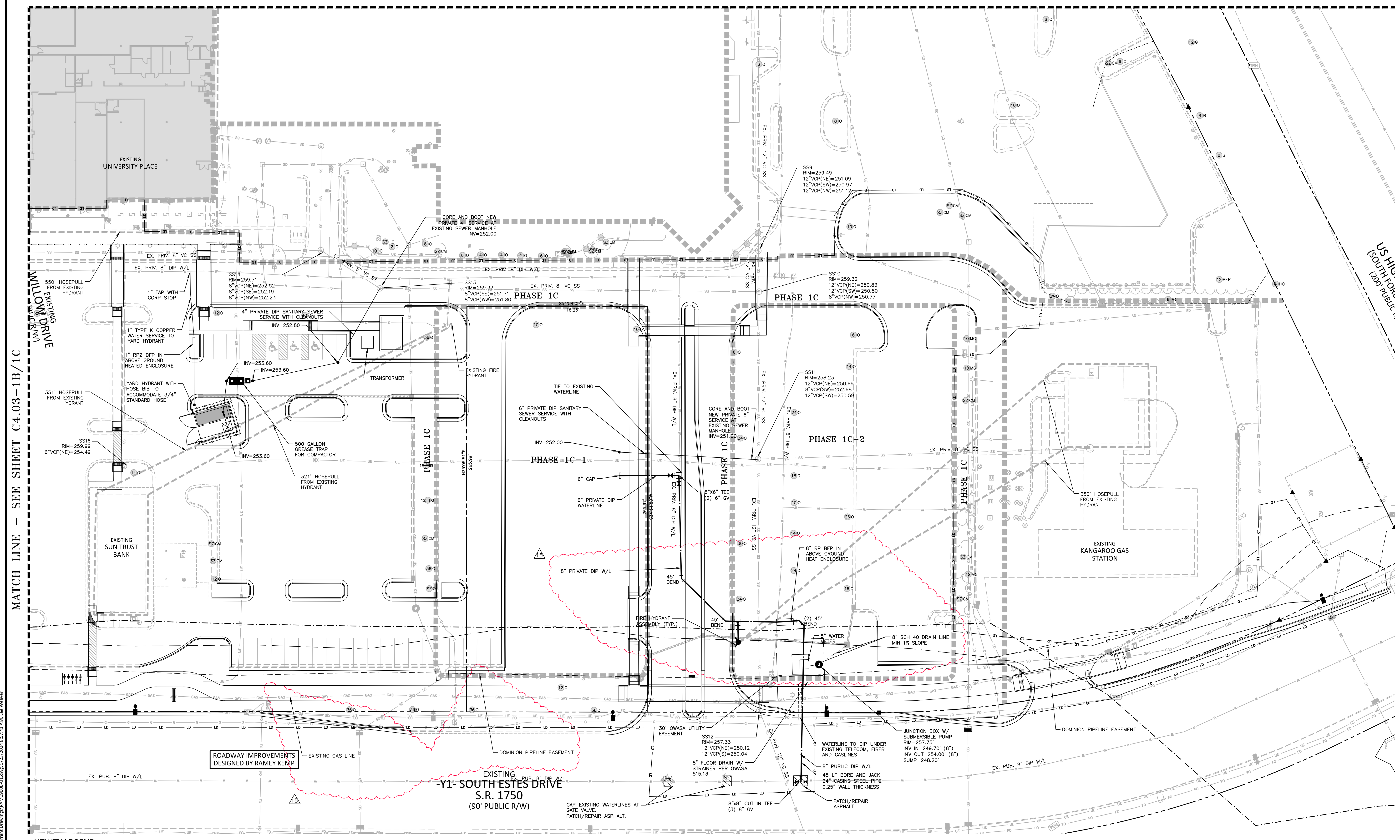

SEE SHEET C0.00 FOR ALL PROJECT, SITE,
GRADING, STORM DRAINAGE AND
UTILITY NOTES

ALL CONSTRUCTION SHALL BE IN
ACCORDANCE WITH THE CURRENT TOWN
OF CHAPEL HILL ENGINEERING DESIGN
AND CONSTRUCTION STANDARDS

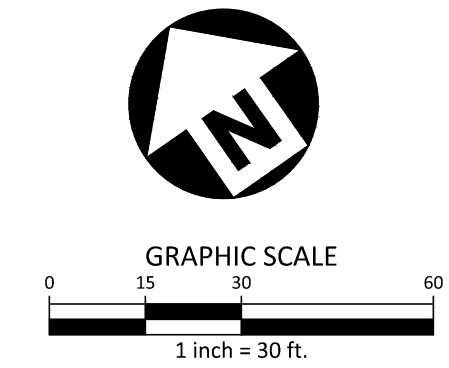

M:\Projects\RAM\20231105\104-Production\Engineering\Construction Drawings\Retail-1\Current Drawings\RAM19000-01.dwg, 5/23/2024 8:57:41 AM, Lee, Wower

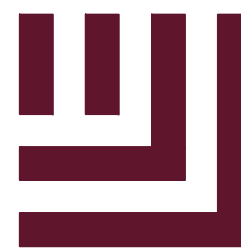

McADAMS

The John R. McAdams Company, Inc.
2905 Meridian Parkway
Durham, NC 27713

phone 919. 361. 5000
fax 919. 361. 2269
license number: C-0293

www.mcadamsco.com

CLIENT

RAM REALTY
2100 S. TRYON STREET SUITE 203
CHARLOTTE, NORTH CAROLINA 28203



UNIVERSITY PLACE
PHASE 1B + 1C
ZONING COMPLIANCE PERMIT
CHAPEL HILL, NC 27514

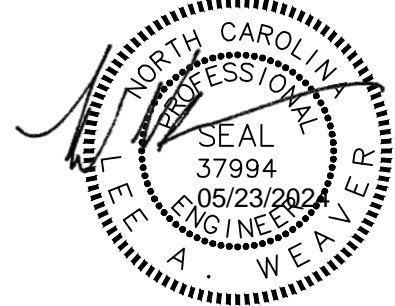

EROSION CONTROL NOTES:

- 1. EROSION AND SEDIMENT CONTROL DEVICES MUST BE INSTALLED AND INSPECTED PRIOR TO ANY GRADING ON SITE. THE CONTRACTOR SHALL CALL FOR AN INSPECTION BY ORANGE COUNTY SEDIMENTATION AND EROSION CONTROL (SEC) ONCE INITIAL MEASURES ARE IN PLACE.
2. REQUIRED TREE PROTECTION FENCING SHALL BE INSTALLED AND A PRE-CONSTRUCTION CONFERENCE SCHEDULED WITH THE TOWN'S URBAN FORESTER PRIOR TO BEGINNING LAND DISTURBANCE.
3. SEDIMENT/EROSION CONTROL DEVICES MUST BE CHECKED AFTER EACH STORM EVENT. EACH DEVICE IS TO BE MAINTAINED OR REPLACED IF SEDIMENT ACCUMULATION HAS REACHED ONE HALF THE CAPACITY OF THE DEVICE.
4. IN ADDITION TO THE REQUIREMENT DURING CONSTRUCTION FOR THE INSPECTION OF EROSION CONTROL DEVICES AFTER EVERY RAINFALL, THE CONTRACTOR SHALL INSPECT THE EROSION AND SEDIMENT CONTROL DEVICES AND OFF-SITE ROADWAYS DAILY, MAKE ANY NECESSARY REPAIRS OR ADJUSTMENTS TO THE DEVICES, REMOVE DEPOSITION OF WET OR DRY SILT ON ADJACENT ROADWAYS AND MAINTAIN INSPECTION LOGS DOCUMENTING THE DAILY INSPECTIONS AND ANY NECESSARY REPAIRS.
5. A COPY OF THE APPROVED EROSION CONTROL PLAN MUST BE ON FILE AT THE JOB SITE AT ALL TIMES.
6. CONSTRUCTION, MAINTENANCE, AND REMOVAL OF ALL EROSION CONTROL DEVICES ARE THE RESPONSIBILITY OF THE GRADING CONTRACTOR UNLESS OTHERWISE NOTED.
7. ANY GRADING BEYOND THE DENUDED LIMITS SHOWN ON THE PLAN IS A VIOLATION OF THE COUNTY EROSION CONTROL ORDINANCE AND IS SUBJECT TO A FINE.
8. NO DEBRIS SHALL BE TRACKED ONTO ANY EXISTING PAVED AREAS OR PUBLIC RIGHT OF WAY. IF THE SITUATION OCCURS WHERE MUD, ROCK AND DEBRIS IS TRACKED ONTO PAVEMENT, THE CONTRACTOR SHALL CLEAN THE PAVEMENT AND INSTALL ADDITIONAL MEASURES TO PREVENT THE FUTURE OCCURRENCE.
9. DURING THE CONSTRUCTION PHASE, ADDITIONAL EROSION AND SEDIMENT CONTROLS MAY BE REQUIRED IF THE PROPOSED MEASURES DO NOT CONTAIN THE SEDIMENT ON SITE. THE EROSION CONTROL INSPECTOR MAY REQUIRE ADDITIONAL FIELD MEASURES AS NECESSARY TO PROVIDE ADEQUATE PROTECTION FROM RECEIVING WATER COURSES.
10. PROTECTION OF EXISTING VEGETATION: AT THE START OF GRADING INVOLVING THE STRIPPING OF TOPSOIL OR COVERING OF EXISTING GRADE AROUND A TREE, A CLEAR, SHARP, PROTECTION FENCE SHALL BE MADE AT THE EDGE OF THE TREE SAVE AREA AT THE SAME TIME AS OTHER EROSION CONTROL MEASURES ARE INSTALLED. THE TREE PROTECTION FENCING SHALL BE INSTALLED ON THE SIDE OF THE CUT FARTHEST AWAY FROM THE TREE TRUNK AND SHALL REMAIN IN PLACE UNTIL ALL CONSTRUCTION IN THE VICINITY OF THE TREES IS COMPLETE. NO STORAGE OF MATERIALS, FILL OR EQUIPMENT AND NO TRESPASSING SHALL BE ALLOWED WITHIN THE BOUNDARY OF THE PROTECTED AREA AND SHALL BE POSTED ON THE PROTECTION FENCE. A PROTECTION FENCE CONSTRUCTED OF MATERIAL RESISTANT TO DEGRADATION BY SUN, WIND, AND MOISTURE FOR THE DURATION OF THE CONSTRUCTION, SHALL BE INSTALLED AT THE SAME TIME AS THE EROSION CONTROL MEASURES AND SHALL BE IN PLACE UNTIL ALL CONSTRUCTION IN THE VICINITY OF THE TREES IS COMPLETE.
11. A CONSTRUCTION SEQUENCE HAS BEEN PROVIDED. INSTALLATION OF ALL PROPOSED SEDIMENTATION & EROSION CONTROL MEASURES IN THE SEQUENCE(S) PROVIDED AND MAINTENANCE OF THOSE DEVICES IS REQUIRED. THE CONTRACTOR MAY BE ALLOWED, WITH PRIOR APPROVAL FROM THE OWNER, TO COORDINATE CHANGES TO THE PLAN WITH THE ON-SITE SEDIMENTATION & EROSION CONTROL INSPECTOR AND THE ENGINEER.
12. PROVIDE INLET PROTECTION AROUND ALL SITE STORM INLETS. PROTECT OPEN PIPES UNDER CONSTRUCTION WITH EITHER PLYWOOD OR WITH MESH AND GRAVEL WEIRS. RUNOFF SHALL NOT BE ALLOWED IN ANY OPEN TRENCH.
13. CONTRACTOR TO VERIFY SILT FENCE OUTLET PLACEMENT AT LOW POINTS AS THEY EXIST OR DEVELOP. ADDITIONAL SILT FENCE OUTLETS MAY BE REQUIRED TO PREVENT EROSION DURING AND AFTER CONSTRUCTION AND LAND DISTURBANCE ACTIVITIES. IF ADDITIONAL SILT FENCE OUTLETS ARE NECESSARY, CONTRACTOR TO ADD ADDITIONAL SILT FENCE OUTLETS PER ENGINEER, NCDOT EROSION CONTROL INSPECTOR, OR OWNER DIRECTION. IF FLOODING OF WATER OR SEDIMENT OCCURS ALONG SILT FENCE, CONTRACTOR SHALL INSTALL AN ADDITIONAL SILT FENCE OUTLET.
14. TEMPORARY DIVERSIONS SHALL BE MAINTAINED DAILY BY CONTRACTOR SO THAT THEY ARE FUNCTIONAL AT THE END OF EACH WORKDAY AND WHEN STOPPING WORK FOR RAIN.

CONTRACTOR'S MAINTENANCE PLAN:

- 1. ALL EROSION AND SEDIMENT CONTROL MEASURES SHALL BE CHECKED FOR STABILITY AND OPERATION FOLLOWING EVERY RUNOFF-PRODUCING RAINFALL BUT IN NO CASE LESS THAN ONCE EVERY WEEK. ANY NEEDED REPAIRS SHALL BE MADE IMMEDIATELY TO MAINTAIN ALL MEASURES AS DESIGNED.
2. SEDIMENT BASINS SHALL BE INSPECTED REGULARLY DURING LAND DISTURBING ACTIVITIES AND AFTER EACH RUNOFF-PRODUCING RAINFALL. SEDIMENT SHALL BE REMOVED AND THE BASIN RESTORED TO ITS ORIGINAL DIMENSIONS WHEN SEDIMENT HAS ACCUMULATED TO ONE-HALF THE DESIGN DEPTH OF EACH BASIN. PORTIONS OF THE BASIN'S GRAVEL FACING THAT ARE CONTAMINATED BY SEDIMENT SHALL BE REPLACED WITH FRESH GRAVEL DURING EACH SEDIMENT REMOVAL EPISODE.
3. SEDIMENT FENCES SHALL BE INSPECTED AT LEAST ONCE A WEEK AND AFTER EACH RUNOFF-PRODUCING RAINFALL. REPAIRS SHALL BE MADE IMMEDIATELY. SEDIMENT DEPOSITS SHALL BE REMOVED AS NEEDED TO PROVIDE ADEQUATE STORAGE VOLUME FOR THE NEXT RAINFALL EVENT, AND TO REDUCE PRESSURE ON THE FENCE. FENCING MATERIALS AND SEDIMENT DEPOSITS SHALL BE REMOVED, AND THE AREA BROUGHT TO GRADE FOLLOWING STABILIZATION OF UPGRADED DISTURBED AREAS.
4. DIVERSION DITCHES MUST REMAIN IN PLACE UNTIL PROJECT IS STABILIZED.
5. EROSION CONTROL DURING SITE CONSTRUCTION WILL BE ACCOMPLISHED BY USE OF SILT FENCING AND SILT FENCE OUTLETS. DEVICES MUST BE EMPLOYED WHEN SEDIMENT ACCUMULATION HAS REACHED 6" DEPTH.

TEMPORARY SEEDING SCHEDULE

Table with 3 columns: SEEDING DATE, SEEDING MIXTURE, APPLICATION RATE. Rows include JAN 1 - MAY 1 and MAY 1 - AUG 15.

SOIL AMENDMENTS

FOLLOW RECOMMENDATIONS OF SOIL TESTS OR APPLY 4,000 LB/AC GROUND AGRICULTURE LIMESTONE AND 750 LB/AC 10-10-10 FERTILIZER (FROM AUG 15 - DEC 30, INCREASE 10-10-10 FERTILIZER TO 1000 LB/AC).

MULCH

APPLY 4000 LB/AC STRAW. ANCHOR STRAW BY TACKING WITH ASPHALT, NETTING, OR A MULCH ANCHORING TOOL. A DISK WITH BLADES SET NEARLY STRAIGHT CAN BE USED AS A MULCH ANCHORING TOOL.

MAINTENANCE

- JAN 1 - AUG 15: REFERTILIZE IF GROWTH IS NOT FULLY ADEQUATE. RESEED, REFERTILIZE, AND MULCH IMMEDIATELY FOLLOWING EROSION OR OTHER DAMAGE.
AUG 15 - DEC 30: REPAIR AND REFERTILIZE DAMAGED AREAS IMMEDIATELY. TOP DRESS WITH 50 LB/AC OF NITROGEN IN MARCH. IF IT IS NECESSARY TO EXTEND TEMPORARY COVER BEYOND JUNE 15, OVERSEED WITH 50 LB/AC KOBE LESPEDENZA IN LATE FEBRUARY OR EARLY MARCH.

NOTE: USE THE TEMPORARY SEEDING SCHEDULE ONLY WHEN DATE IS NOT CORRECT TO USE THE PERMANENT SEEDING SCHEDULE.

PERMANENT SEEDING SCHEDULE

Table with 3 columns: SEEDING DATE, SEEDING MIXTURE, APPLICATION RATE. Rows include AUG 25 - OCT (BEST) and FEB - APR 15 (POSSIBLE).

SOIL AMENDMENTS

FOLLOW RECOMMENDATIONS OF SOIL TESTS OR APPLY 4,000 LB/AC GROUND AGRICULTURE LIMESTONE AND 1000 LB/AC 10-10-10 FERTILIZER.

MULCH

APPLY 4000 LB/AC STRAW. ANCHOR STRAW BY TACKING WITH ASPHALT, NETTING, OR A MULCH ANCHORING TOOL. A DISK WITH BLADES SET NEARLY STRAIGHT CAN BE USED AS A MULCH ANCHORING TOOL.

MAINTENANCE

INSPECT AND REPAIR MULCH FREQUENTLY. REFERTILIZE IN LATE WINTER OF THE FOLLOWING YEAR; USE SOIL TESTS OR APPLY 150 LB/AC 10-10-10 FERTILIZER. MOW REGULARLY TO A HEIGHT OF 2-4 INCHES.

SEEDBED PREPARATION

AREAS TO BE SEEDDED TO BE SCARIFIED 4" DEEP. A FIRM, WELL PULVERIZED, UNIFORM SEEDBED SHOULD BE PROVIDED. FERTILIZER SHALL BE PLACED DURING SCARIFICATION AS FOLLOWS:
LIME: 45 LBS / 1,000 SF
PHOSPHOROUS: 20 LBS / 1,000 SF
FERTILIZER: 17 LBS / 1,000 SF

CONSTRUCTION MANAGEMENT NOTES:

- 1. ALL CONSTRUCTION RELATED VEHICULAR TRAFFIC SHALL ENTER/LEAVE THE SITE THROUGH THE TEMPORARY CONSTRUCTION ENTRANCES AS SHOWN ON THE PLAN.
2. TEMPORARY CONSTRUCTION ENTRANCES MAY SHIFT INTO SITE IN COORDINATION WITH CONSTRUCTION SEQUENCE/TRAFFIC CONTROL FOR EUBANKS ROAD. SITE CONTRACTOR TO SEE PLANS BY RAMSEY KEMP AND ASSOCIATES AND COORDINATE WITH ROADWAY CONTRACTOR.
3. NO OPEN BURNING SHALL BE PERMITTED ON THIS SITE.
4. THE APPLICANT SHALL POST A CONSTRUCTION SIGN ON THE DEVELOPMENT SITE THAT LISTS THE FOLLOWING:
- PROPERTY OWNER'S REPRESENTATIVE & TELEPHONE NUMBER
- CONTRACTOR'S REPRESENTATIVE & TELEPHONE NUMBER
- TELEPHONE NUMBER FOR REGULATORY INFO AT TIME OF BUILDING PERMIT
- SIGN MAY BE A MAXIMUM OF 32 SF AND A MAXIMUM HEIGHT OF 8 FT.
6. NO CONSTRUCTION ACTIVITY WHICH WILL BE SUBJECT TO THE TOWN'S NOISE ORDINANCE (ARTICLE III SECTION 11-37*42) SHALL OCCUR BETWEEN NIGHTTIME HOURS AS DEFINED IN THE TOWN ORDINANCE. THIS MEANS, IN GENERAL, BETWEEN 9 PM AND 7 AM AS DEFINED BY SECTION 11-40 (B) OF THE NOISE ORDINANCE.
7. LOCATION OF CONSTRUCTION OFFICE, PARKING, AND MATERIAL STORAGE AREA IS APPROXIMATE, AND MAY CHANGE DEPENDING ON ANY ON-SITE CONSTRUCTION SEQUENCE OF THE PROJECT AS IT IS BEING COMPLETED.

TRAFFIC MANAGEMENT NOTES:

- 1. TRAFFIC IS NOT INTENDED TO BE INTERRUPTED DURING THE PROPOSED CONSTRUCTION, HOWEVER, NCDOT STANDARD DRAWINGS FOR TEMPORARY LANE CLOSURES (1101.02) AND TEMPORARY ROAD CLOSURES (1101.03) SHALL BE USED IF TEMPORARY TRAFFIC IMPACTS ARE NECESSARY.

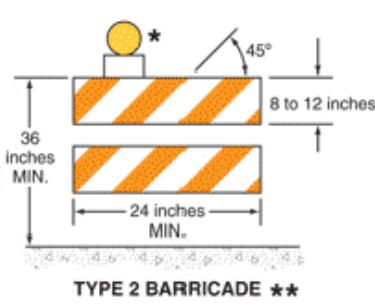

FIGURE 6F-7 CHANNELIZING DEVICES - SIDEWALK BARRICADE

*WARNING LIGHTS (OPTIONAL)
**RAIL STRIPE WIDTHS SHALL BE 6 INCHES, EXCEPT THAT 4-INCH WIDE STRIPES MAY BE USED IF RAIL LENGTHS ARE LESS THAN 36 INCHES. THE SIDES OF BARRICADES FACING TRAFFIC SHALL HAVE RETROREFLECTIVE RAIL FACES.

SIGNAGE NOTES

- 1. ALL SIGNAGE SHALL BE COORDINATED WITH TOWN OF CHAPEL HILL AND NCDOT PEDESTRIAN SAFETY SPECIFICATIONS.
2. ALL SIGNAGE SHALL MEET MUTCD STANDARDS AND SPECIFICATIONS AND NCDOT PEDESTRIAN SAFETY SPECIFICATIONS.
3. ALL PEDESTRIAN SIGNAGE SHALL BE MOUNTED ON TYPE 2 BARRICADES COMPLIANT WITH 2009 MUTCD SECTION 6F-63.

PEDESTRIAN MANAGEMENT NOTES

- 1. ROUTE SHALL BE ACCESSIBLE AT ALL TIMES PER ADA.
2. KEEP PEDESTRIAN ROUTE CLEAR OF CONSTRUCTION ACTIVITIES.
3. UNIQUE PEDESTRIANS NEEDS SHALL BE COORDINATED WITH THE SITE CONTRACTOR.

Figure 6H-2B. Sidewalk Detour or Diversion (TA-28)

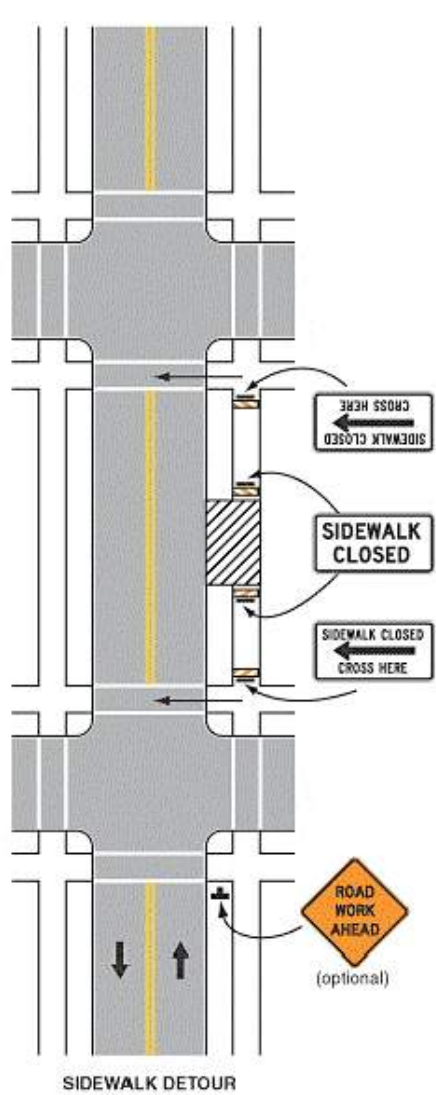

Typical Application 2B

Note: See Tables 6H-2 and 6H-3 for the meaning of the symbols and/or letter codes used in the figure.

FIGURE 6H-2B SIDEWALK DETOUR OR DIVERSION (TA-28)

CONSTRUCTION SEQUENCE - STAGE 1

- 1. OBTAIN A LAND-DISTURBING PERMIT AND SCHEDULE A PRECONSTRUCTION CONFERENCE WITH ORANGE COUNTY EROSION CONTROL OFFICER, WESLEY POOLE (919)245.2587. THE PRECONSTRUCTION MEETING SHALL INCLUDE A REPRESENTATIVE FROM OWASA, TOWN OF CHAPEL HILL, TOWN OF CHAPEL HILL URBAN FORESTER, AND OWNER.
NOTE: INSTALL A RURAL TYPE MAILBOX ON THE SITE TO HOLD A COPY OF THE APPROVED EROSION CONTROL PLAN AND TO PROVIDE A PLACE FOR INSPECTORS TO LEAVE INSPECTION REPORT, COMPLIANCE NOTICES, ETC.
2. INSTALL GRAVEL CONSTRUCTION ENTRANCE(S) PER PLAN. ALSO INSTALL TEMPORARY SILT FENCING WITH OUTLETS AS SHOWN.
3. CONTRACTOR SHALL CLEAR ONLY THOSE AREAS NECESSARY TO ACCESS AND INSTALL INITIAL PERIMETER DEVICES. INSTALL INLET PROTECTION ON EXISTING INLETS AS SHOWN.
4. INSTALL INLET PROTECTION PER ORANGE COUNTY SEC STANDARDS AND SPECIFICATIONS ON ALL SPECIFIED INLETS.
5. CALL 919.245.2587 FOR ON-SITE INSPECTION BY ORANGE COUNTY EROSION CONTROL.
6. BEGIN CLEARING, DEMOLITION OF EXISTING ASPHALT AND GRAVEL AREAS, AND GENERAL GRADING OF STAGE 1 AREA. MAINTAIN DEVICES AS NEEDED.
7. NO MUD SHALL BE TRACKED ONTO EXISTING PAVEMENT OR A NOTICE OF VIOLATION FROM THE EROSION CONTROL DEPARTMENT MAY ENSUE. ADDITIONAL MEASURES MAY BE NECESSARY TO ASSURE THAT NO SEDIMENT LEAVES THE SITE.
8. PROVIDE ALL DISTURBED AREAS WITH GROUND COVER WITHIN 14 CALENDAR DAYS AFTER COMPLETION OF ANY PHASE OF CLEARING, GRUBBING OR GRADING. THE SEEDING, SEEDBED PREPARATION, MULCH AND/OR ROLLED EROSION CONTROL PRODUCT INSTALLATION MUST BE IN ACCORDANCE WITH THE SEEDING SCHEDULE PROVIDED IN THIS S&E PLAN. NOTE: SLOPES IN EXCESS OF 3H:1V SHALL BE STABILIZED WITHIN 7 DAYS AND FOR MODERATE SLOPES (SLOPES LESS THAN 3H:1V) SHALL BE STABILIZED WITHIN 14 DAYS.
9. WITH APPROVAL FROM ORANGE COUNTY EROSION CONTROL INSPECTOR, CONTINUE TO STAGE 2.

CONSTRUCTION SEQUENCE - STAGE 2

- 1. CONSTRUCT STORM DRAIN SYSTEM AS SHOWN.
2. INSTALL INLET PROTECTION ON ALL INLET STRUCTURES DURING CONSTRUCTION.
3. PROVIDE ALL DISTURBED AREAS WITH GROUND COVER WITHIN 14 CALENDAR DAYS AFTER COMPLETION OF ANY PHASE OF CLEARING, GRUBBING OR GRADING. THE SEEDING, SEEDBED PREPARATION, MULCH AND/OR ROLLED EROSION CONTROL PRODUCT INSTALLATION MUST BE IN ACCORDANCE WITH THE SEEDING SCHEDULE PROVIDED IN THIS S&E PLAN. NOTE: SLOPES IN EXCESS OF 3H:1V SHALL BE STABILIZED WITHIN 7 DAYS AND FOR MODERATE SLOPES (SLOPES LESS THAN 3H:1V) SHALL BE STABILIZED WITHIN 14 DAYS.
4. AT THE CONCLUSION OF BUILDING OR IF LAND-DISTURBING ACTIVITY IS STOPPED FOR MORE THAN 14 CONSECUTIVE CALENDAR DAYS, PERMANENT VEGETATIVE COVER SHALL BE INSTALLED IN ACCORDANCE WITH THIS S&E PLAN.
5. WHEN SITE IS AT FINAL GRADE AND NO FURTHER GRADING IS NECESSARY, CONTRACTOR SHALL STABILIZE PORTIONS OF THE SITE WITH SEED/MULCH UNTIL FINAL LANDSCAPING IS INSTALLED.
6. CONTINUE TO STAGE 3.

CONSTRUCTION SEQUENCE - STAGE 3

- 1. INSTALL GRAVEL CONSTRUCTION ENTRANCE(S) PER PLAN. ALSO INSTALL TEMPORARY SILT FENCING WITH OUTLETS AS SHOWN.
2. CONTRACTOR SHALL CLEAR ONLY THOSE AREAS NECESSARY TO ACCESS AND INSTALL INITIAL PERIMETER DEVICES. INSTALL INLET PROTECTION ON EXISTING INLETS AS SHOWN.
3. INSTALL INLET PROTECTION PER ORANGE COUNTY SEC STANDARDS AND SPECIFICATIONS ON ALL SPECIFIED INLETS.
4. CALL 919.245.2587 FOR ON-SITE INSPECTION BY ORANGE COUNTY EROSION CONTROL.
5. BEGIN CLEARING, DEMOLITION OF EXISTING ASPHALT AND GRAVEL AREAS, AND GENERAL GRADING OF STAGE 3 AREA. MAINTAIN DEVICES AS NEEDED.
6. NO MUD SHALL BE TRACKED ONTO EXISTING PAVEMENT OR A NOTICE OF VIOLATION FROM THE EROSION CONTROL DEPARTMENT MAY ENSUE. ADDITIONAL MEASURES MAY BE NECESSARY TO ASSURE THAT NO SEDIMENT LEAVES THE SITE.
7. PROVIDE ALL DISTURBED AREAS WITH GROUND COVER WITHIN 14 CALENDAR DAYS AFTER COMPLETION OF ANY PHASE OF CLEARING, GRUBBING OR GRADING. THE SEEDING, SEEDBED PREPARATION, MULCH AND/OR ROLLED EROSION CONTROL PRODUCT INSTALLATION MUST BE IN ACCORDANCE WITH THE SEEDING SCHEDULE PROVIDED IN THIS S&E PLAN. NOTE: SLOPES IN EXCESS OF 3H:1V SHALL BE STABILIZED WITHIN 7 DAYS AND FOR MODERATE SLOPES (SLOPES LESS THAN 3H:1V) SHALL BE STABILIZED WITHIN 14 DAYS.
8. WITH APPROVAL FROM ORANGE COUNTY EROSION CONTROL INSPECTOR, CONTINUE TO STAGE 4.

CONSTRUCTION SEQUENCE - STAGE 4

- 1. CONSTRUCT STORM DRAIN SYSTEM AS SHOWN.
2. INSTALL INLET PROTECTION ON ALL INLET STRUCTURES DURING CONSTRUCTION.
3. PROVIDE ALL DISTURBED AREAS WITH GROUND COVER WITHIN 14 CALENDAR DAYS AFTER COMPLETION OF ANY PHASE OF CLEARING, GRUBBING OR GRADING. THE SEEDING, SEEDBED PREPARATION, MULCH AND/OR ROLLED EROSION CONTROL PRODUCT INSTALLATION MUST BE IN ACCORDANCE WITH THE SEEDING SCHEDULE PROVIDED IN THIS S&E PLAN. NOTE: SLOPES IN EXCESS OF 3H:1V SHALL BE STABILIZED WITHIN 7 DAYS AND FOR MODERATE SLOPES (SLOPES LESS THAN 3H:1V) SHALL BE STABILIZED WITHIN 14 DAYS.
4. AT THE CONCLUSION OF BUILDING OR IF LAND-DISTURBING ACTIVITY IS STOPPED FOR MORE THAN 14 CONSECUTIVE CALENDAR DAYS, PERMANENT VEGETATIVE COVER SHALL BE INSTALLED IN ACCORDANCE WITH THIS S&E PLAN.
5. WHEN SITE IS AT FINAL GRADE AND NO FURTHER GRADING IS NECESSARY, CONTRACTOR SHALL STABILIZE PORTIONS OF THE SITE WITH SEED/MULCH UNTIL FINAL LANDSCAPING IS INSTALLED.
6. WHEN CONSTRUCTION IS COMPLETE, CALL OCEC TO OBTAIN FINAL INSPECTION AND CERTIFICATE OF COMPLETION TO CLOSE OUT EROSION CONTROL PERMIT.

CONSTRUCTION SEQUENCE - CHASE BANK PAD

- 1. INSTALL GRAVEL CONSTRUCTION ENTRANCE(S) PER PLAN. INSTALL TEMPORARY SILT FENCING WITH OUTLETS AS SHOWN.
2. CONTRACTOR SHALL CLEAR ONLY THOSE AREAS NECESSARY TO ACCESS AND INSTALL INITIAL PERIMETER DEVICES. INSTALL INLET PROTECTION ON EXISTING INLETS AS SHOWN.
3. INSTALL INLET PROTECTION PER ORANGE COUNTY SEC STANDARDS AND SPECIFICATIONS ON ALL SPECIFIED INLETS.
4. CALL 919.245.2587 FOR ON-SITE INSPECTION BY ORANGE COUNTY EROSION CONTROL.
5. BEGIN CLEARING, DEMOLITION OF EXISTING ASPHALT AND GRAVEL AREAS, AND GENERAL GRADING OF STAGE 1 AREA. MAINTAIN DEVICES AS NEEDED.
6. NO MUD SHALL BE TRACKED ONTO EXISTING PAVEMENT OR A NOTICE OF VIOLATION FROM THE EROSION CONTROL DEPARTMENT MAY ENSUE. ADDITIONAL MEASURES MAY BE NECESSARY TO ASSURE THAT NO SEDIMENT LEAVES THE SITE.
7. PROVIDE ALL DISTURBED AREAS WITH GROUND COVER WITHIN 14 CALENDAR DAYS AFTER COMPLETION OF ANY PHASE OF CLEARING, GRUBBING OR GRADING. THE SEEDING, SEEDBED PREPARATION, MULCH AND/OR ROLLED EROSION CONTROL PRODUCT INSTALLATION MUST BE IN ACCORDANCE WITH THE SEEDING SCHEDULE PROVIDED IN THIS S&E PLAN. NOTE: SLOPES IN EXCESS OF 3H:1V SHALL BE STABILIZED WITHIN 7 DAYS AND FOR MODERATE SLOPES (SLOPES LESS THAN 3H:1V) SHALL BE STABILIZED WITHIN 14 DAYS.
8. CONSTRUCT STORM DRAIN SYSTEM AS SHOWN.
9. INSTALL INLET PROTECTION ON ALL INLET STRUCTURES DURING CONSTRUCTION.
10. AT THE CONCLUSION OF BUILDING OR IF LAND-DISTURBING ACTIVITY IS STOPPED FOR MORE THAN 14 CONSECUTIVE CALENDAR DAYS, PERMANENT VEGETATIVE COVER SHALL BE INSTALLED IN ACCORDANCE WITH THIS S&E PLAN.
11. WHEN SITE IS AT FINAL GRADE AND NO FURTHER GRADING IS NECESSARY, CONTRACTOR SHALL STABILIZE PORTIONS OF THE SITE WITH SEED/MULCH UNTIL FINAL LANDSCAPING IS INSTALLED.

Table for GROUND STABILIZATION with columns: SITE AREA DESCRIPTION, STABILIZATION TIME FRAME, STABILIZATION TIME FRAME EXCEPTIONS. Rows include PERIMETER DICES, SWALES, DITCHES AND SLOPES, HIGH QUALITY WATER (HQW) ZONES, SLOPES STEEPER THAN 3:1, SLOPES 3:1 OR FLATTER, ALL OTHER AREAS WITH SLOPES FLATTER THAN 4:1.

Table for BUILDING WASTES HANDLING with bullet points: NO PAINT OR LIQUID WASTES IN STREAM OR STORM DRAINS; DEDICATED AREAS FOR DEMOLITION, CONSTRUCTION AND OTHER WASTES MUST BE LOCATED 50' FROM STORM DRAINS AND STREAMS UNLESS NO REASONABLE ALTERNATIVES AVAILABLE; EARTHEN-MATERIAL STOCKPILES MUST BE LOCATED 50' FROM STORM DRAINS AND STREAMS UNLESS NO REASONABLE ALTERNATIVES AVAILABLE; CONCRETE MATERIALS MUST BE CONTROLLED TO AVOID CONTACT WITH SURFACE WATER, WETLANDS, OR BUFFERS.

EROSION CONTROL LEGEND

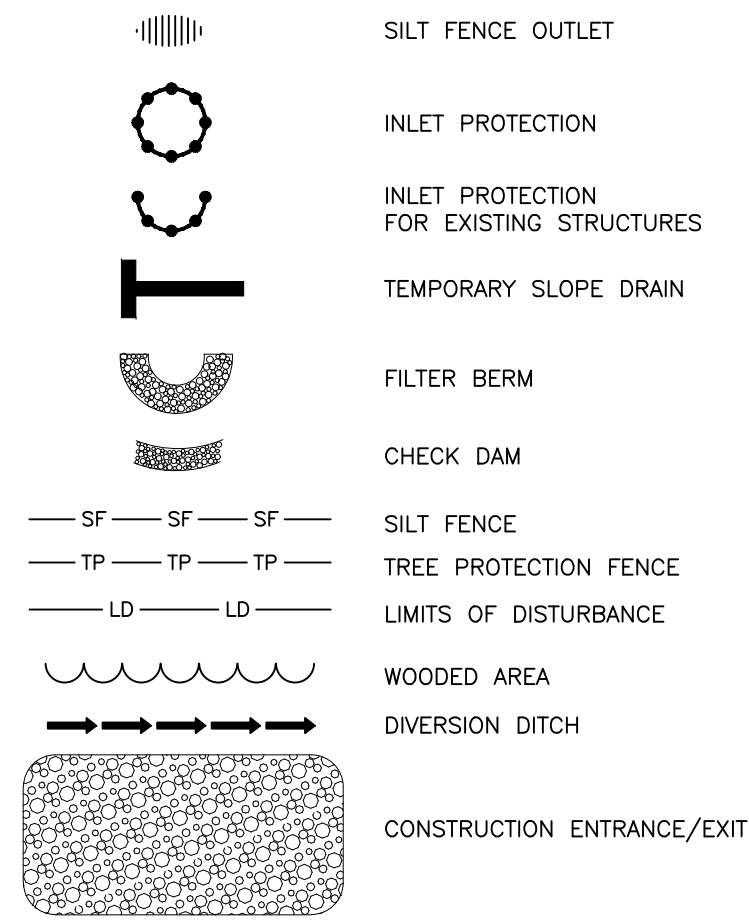

SEE SHEET C0.00 FOR ALL PROJECT, SITE, GRADING, STORM DRAINAGE AND UTILITY NOTES

ALL CONSTRUCTION SHALL BE IN ACCORDANCE WITH THE CURRENT TOWN OF CHAPEL HILL ENGINEERING DESIGN AND CONSTRUCTION STANDARDS

REVISIONS

Table with 3 columns: NO., DATE, DESCRIPTION. Rows include revisions for fire hydrant revision, west rin/rout, chase bank ec plans, ncdot-sidewalk revision, 5-3 bank spot grades, chase bank ec submittal, and zcp update.

PLAN INFORMATION

PROJECT NO. RAM-19000
FILENAME RAM19000-EC1
CHECKED BY LAW
DRAWN BY MRO
SCALE 1"=40'
DATE 09.18.2023

SHEET

EROSION CONTROL & CM NOTES

C6.01-1B/1C

CONSTRUCTION SEQUENCE - STAGE 1

- OBTAIN A LAND-DISTURBING PERMIT AND SCHEDULE A PRECONSTRUCTION CONFERENCE WITH ORANGE COUNTY EROSION CONTROL OFFICER, WESLEY POOLE (919)245.2587. THE PRECONSTRUCTION MEETING SHALL INCLUDE A REPRESENTATIVE FROM OWASA, TOWN OF CHAPEL HILL, TOWN OF CHAPEL HILL URBAN FORESTER, AND OWNER.
- NOTE: INSTALL A RURAL TYPE MAILBOX ON THE SITE TO HOLD A COPY OF THE APPROVED EROSION CONTROL PLAN AND TO PROVIDE A PLACE FOR INSPECTORS TO LEAVE INSPECTION REPORT, COMPLIANCE NOTICES, ETC.
- INSTALL GRAVEL CONSTRUCTION ENTRANCE(S) PER PLAN. ALSO INSTALL TEMPORARY SILT FENCING WITH OUTLETS AS SHOWN.
- CONTRACTOR SHALL CLEAR ONLY THOSE AREAS NECESSARY TO ACCESS AND INSTALL INITIAL PERIMETER DEVICES. INSTALL INLET PROTECTION ON EXISTING INLETS AS SHOWN.
- INSTALL INLET PROTECTION PER ORANGE COUNTY SEC STANDARDS AND SPECIFICATIONS ON ALL SPECIFIED INLETS.
- CALL 919.245.2587 FOR ON-SITE INSPECTION BY ORANGE COUNTY EROSION CONTROL.
- BEGIN CLEARING, DEMOLITION OF EXISTING ASPHALT AND GRAVEL AREAS, AND GENERAL GRADING OF STAGE 1 AREA. MAINTAIN DEVICES AS NEEDED.
- NO MUD SHALL BE TRACKED ONTO EXISTING PAVEMENT OR A NOTICE OF VIOLATION FROM THE EROSION CONTROL DEPARTMENT MAY ENSUE. ADDITIONAL MEASURES MAY BE NECESSARY TO ASSURE THAT NO SEDIMENT LEAVES THE SITE.
- PROVIDE ALL DISTURBED AREAS WITH GROUND COVER WITHIN 14 CALENDAR DAYS AFTER COMPLETION OF ANY PHASE OF CLEARING, GRUBBING OR GRADING. THE SEEDING, SEEDBED PREPARATION, MULCH AND/OR ROLLED EROSION CONTROL PRODUCT INSTALLATION MUST BE IN ACCORDANCE WITH THE SEEDING SCHEDULE PROVIDED IN THIS S&E PLAN. NOTE: SLOPES IN EXCESS OF 3H:1V SHALL BE STABILIZED WITHIN 7 DAYS AND FOR MODERATE SLOPES (SLOPES LESS THAN 3H:1V) SHALL BE STABILIZED WITHIN 14 DAYS.
- WITH APPROVAL FROM ORANGE COUNTY EROSION CONTROL INSPECTOR, CONTINUE TO STAGE 2.

CONSTRUCTION SEQUENCE - CHASE BANK PAD

- INSTALL GRAVEL CONSTRUCTION ENTRANCE(S) PER PLAN. INSTALL TEMPORARY SILT FENCING WITH OUTLETS AS SHOWN.
- CONTRACTOR SHALL CLEAR ONLY THOSE AREAS NECESSARY TO ACCESS AND INSTALL INITIAL PERIMETER DEVICES. INSTALL INLET PROTECTION ON EXISTING INLETS AS SHOWN.
- INSTALL INLET PROTECTION PER ORANGE COUNTY SEC STANDARDS AND SPECIFICATIONS ON ALL SPECIFIED INLETS.
- CALL 919.245.2587 FOR ON-SITE INSPECTION BY ORANGE COUNTY EROSION CONTROL.
- BEGIN CLEARING, DEMOLITION OF EXISTING ASPHALT AND GRAVEL AREAS, AND GENERAL GRADING OF STAGE 1 AREA. MAINTAIN DEVICES AS NEEDED.
- NO MUD SHALL BE TRACKED ONTO EXISTING PAVEMENT OR A NOTICE OF VIOLATION FROM THE EROSION CONTROL DEPARTMENT MAY ENSUE. ADDITIONAL MEASURES MAY BE NECESSARY TO ASSURE THAT NO SEDIMENT LEAVES THE SITE.
- PROVIDE ALL DISTURBED AREAS WITH GROUND COVER WITHIN 14 CALENDAR DAYS AFTER COMPLETION OF ANY PHASE OF CLEARING, GRUBBING OR GRADING. THE SEEDING, SEEDBED PREPARATION, MULCH AND/OR ROLLED EROSION CONTROL PRODUCT INSTALLATION MUST BE IN ACCORDANCE WITH THE SEEDING SCHEDULE PROVIDED IN THIS S&E PLAN. NOTE: SLOPES IN EXCESS OF 3H:1V SHALL BE STABILIZED WITHIN 7 DAYS AND FOR MODERATE SLOPES (SLOPES LESS THAN 3H:1V) SHALL BE STABILIZED WITHIN 14 DAYS.
- CONSTRUCT STORM DRAIN SYSTEM AS SHOWN.
- INSTALL INLET PROTECTION ON ALL INLET STRUCTURES DURING CONSTRUCTION.
- AT THE CONCLUSION OF BUILDING OR IF LAND-DISTURBING ACTIVITY IS STOPPED FOR MORE THAN 14 CONSECUTIVE CALENDAR DAYS, PERMANENT VEGETATIVE COVER SHALL BE INSTALLED IN ACCORDANCE WITH THIS S&E PLAN.
- WHEN SITE IS AT FINAL GRADE AND NO FURTHER GRADING IS NECESSARY, CONTRACTOR SHALL STABILIZE PORTIONS OF THE SITE WITH SEED/MULCH UNTIL FINAL LANDSCAPING IS INSTALLED.

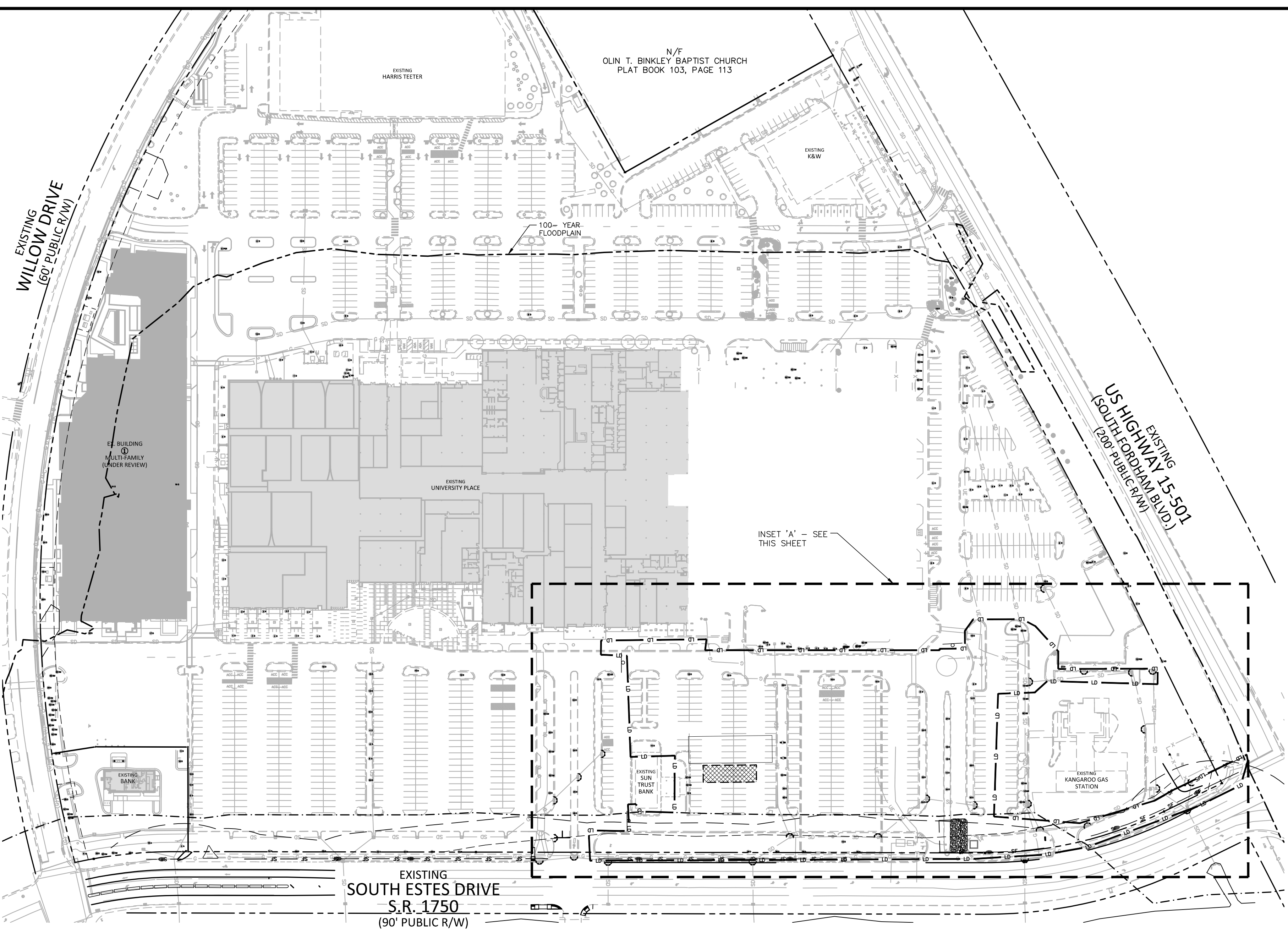

EROSION CONTROL LEGEND

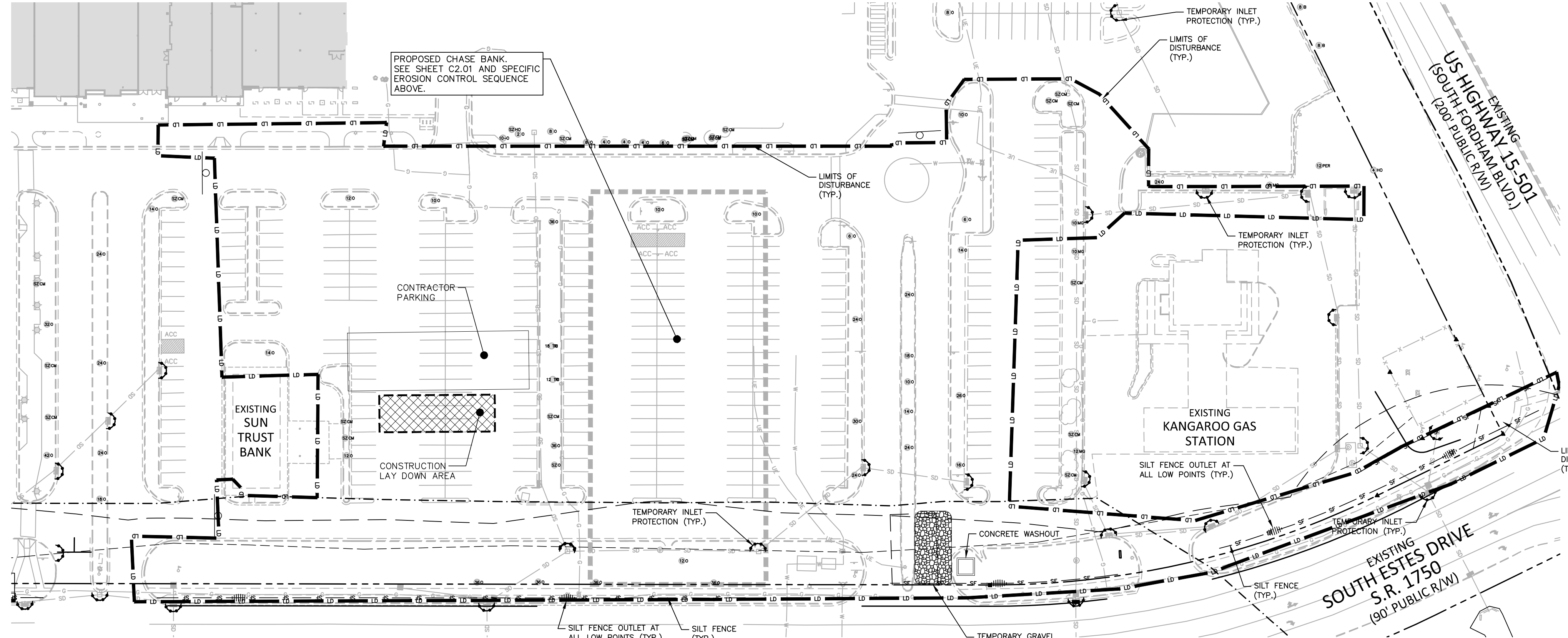
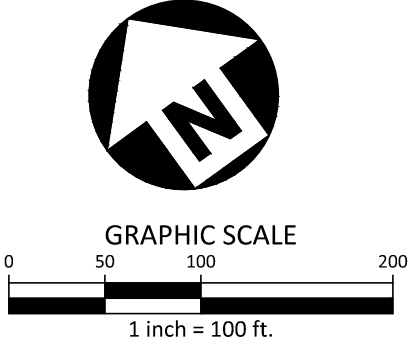
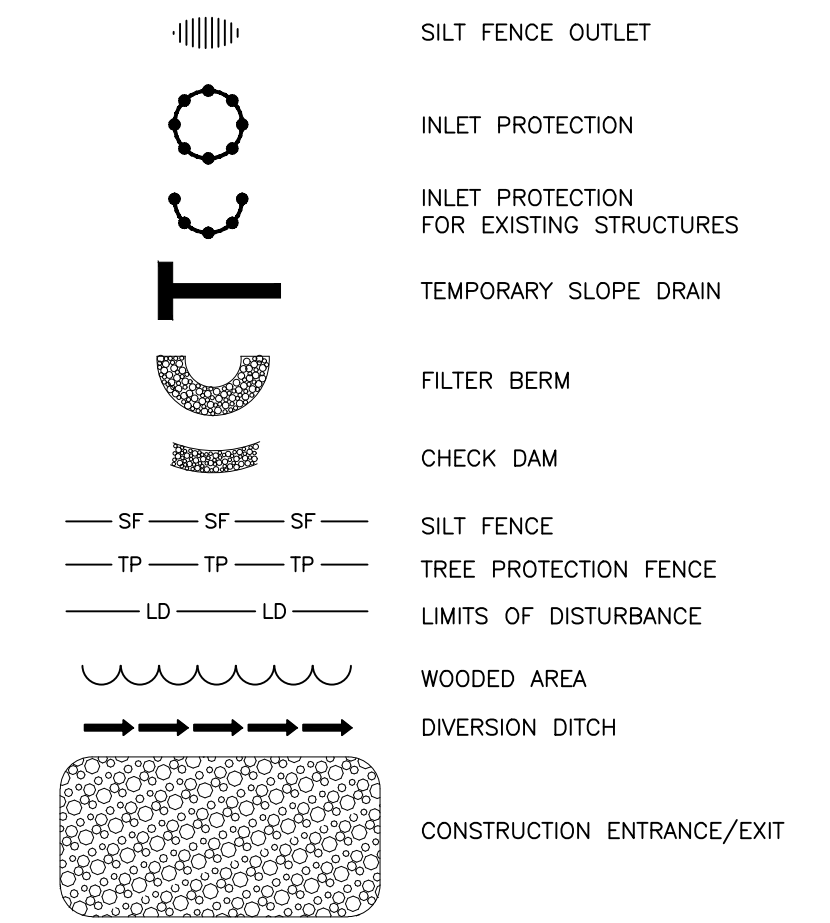

SEE SHEET C0.00 FOR ALL PROJECT, SITE, GRADING, STORM DRAINAGE AND UTILITY NOTES

ALL CONSTRUCTION SHALL BE IN ACCORDANCE WITH THE CURRENT TOWN OF CHAPEL HILL ENGINEERING DESIGN AND CONSTRUCTION STANDARDS

McADAMS
The John R. McAdams Company, Inc.
2905 Meridian Parkway
Durham, NC 27713
phone 919. 361. 5000
fax 919. 361. 2269
license number: C-0293
www.mcadamsco.com

CLIENT
RAM REALTY
2100 S. TRYON STREET SUITE 203
CHARLOTTE, NORTH CAROLINA 28203



**UNIVERSITY PLACE
PHASE 1B + 1C
ZONING COMPLIANCE PERMIT**
CHAPEL HILL, NC 27514



REVISIONS

NO.	DATE	DESCRIPTION
9	07.14.2023	FIRE HYDRANT REVISION
10	07.28.2023	WEST RIN/ROUT
11	08.24.2023	CHASE BANK EC PLANS
12	09.18.2023	NCDOT-SIDEWALK REVISION
13	09.27.2023	S-B BANK SPOT GRADES
14	02.28.2024	CHASE BANK EC SUBMITTAL
15	05.20.2024	ZCP UPDATE

PLAN INFORMATION

PROJECT NO. RAM-19000
FILENAME RAM19000-OAS1
CHECKED BY LAW
DRAWN BY MRO
SCALE 1"=100'
DATE 09.18.2023

**EROSION CONTROL & CM PLAN - STAGE 1
C6.02-1B/1C**

P:\Projects\RAM\202110551\04-Production\Engineering\Construction Drawings\Retail-1\Current Drawings\RAM19000-OAEC1.dwg, 5/23/2024 8:39:48 AM, Lee Wosner